

# PULEGGE DENTATE

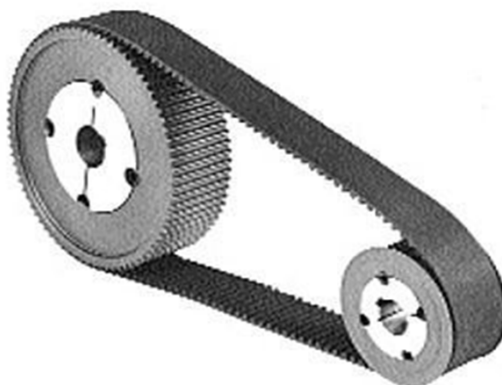

Le pulegge vengono approntate con diversi tipi di dentature per poter soddisfare le più svariate esigenze dell'utilizzatore, principalmente si dividono in :

## **Pulegge con passo e larghezza in pollici, che si dividono nei seguenti passi**

1. MXL
2. XL
3. L
4. H
5. XH
6. XXH

## **Pulegge con passo e larghezza in millimetri, che si dividono nei seguenti passi**

1. HTD 3M
2. HTD 5M
3. HTD 8M
4. HTD 14M
5. HTD 20M (a richiesta)
6. T 2,5
7. T 5
8. T 10
9. T 20 (a richiesta)

Tutte le pulegge possono essere dotate di flange per contenimento cinghia.

I materiali utilizzati ed i trattamenti superficiali protettivi sono :

- Lega di alluminio : nessun trattamento
- Ghisa – Ghisa sferoidale : fosfatazione e successiva oliatura
- Acciaio : verniciatura o brunitura e successiva oliatura

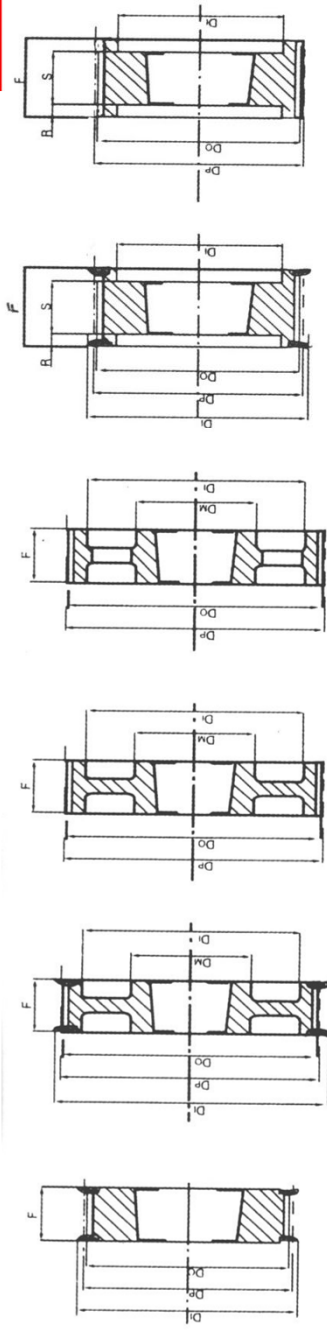

1MF

3DF

3D

3R

4MF

4M

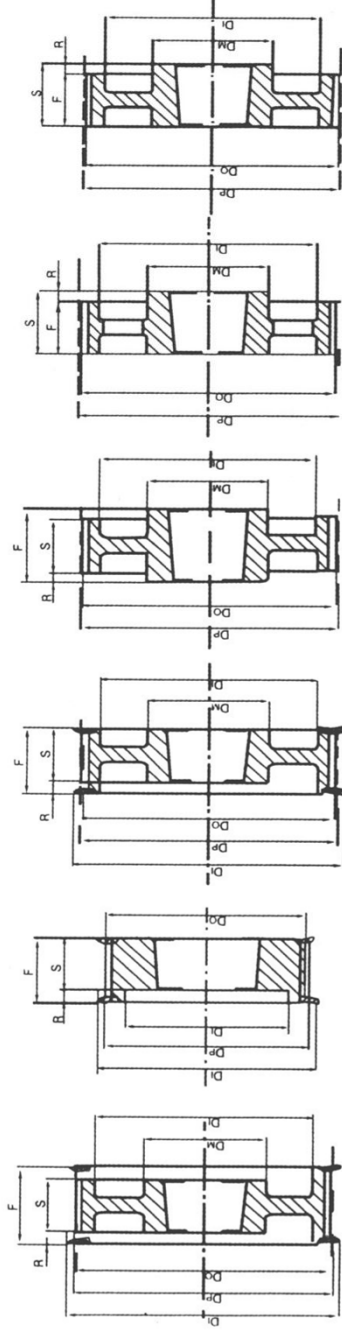

4DF

5MF

5DF

7D

8R

8D

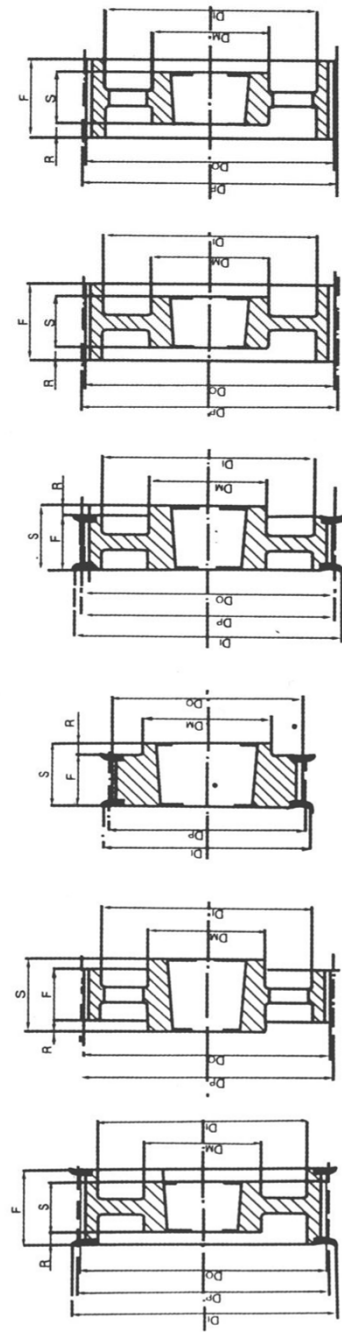

9DF

7R

8MF

8DF

9D

9R

# Bussole coniche PB BUS per Pulegge

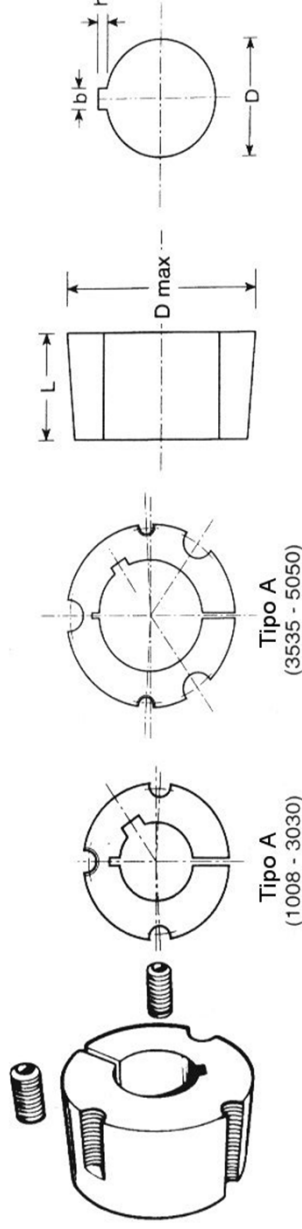
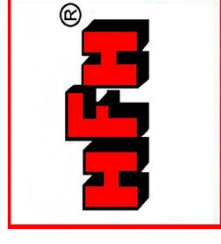

| Tipo PB BUS | Fori disponibili ( * = chiave ribassata di 1 mm. )        | D mm. | Dimensioni D max | L      | Massa max Kg | Viti n° | A = 2 Grani Passo x Lunghezza | B = 3 Viti Lunghezza | Chiave mm. | Serraggio Coppia Nm | d3     | $\beta 1$ | $\beta 2$ |
|-------------|---|-------|------------------|--------|--------------|---------|-------------------------------|----------------------|------------|---------------------|--------|-----------|-----------|
| 1008        | 11-12-14-15-16-18-19-20-22-24*25*                         |       | 35,00            | 22,00  | 0,15         | 2       | 1/4" x 13                     |                      | 3          | 5,7                 | 33,73  |           |           |
| 1108        | 11-12-14-15-16-18-19-20-22-24-25-28*                      |       | 36,30            | 22,00  | 0,15         | 2       | 1/4" x 13                     |                      | 3          | 5,7                 | 36,92  |           |           |
| 1210        | 11-12-14-15-16-18-19-20-22-24-25-28-30-32                 |       | 47,50            | 25,40  | 0,30         | 2       | 3/8" x 16                     |                      | 5          | 20                  | 44,44  |           |           |
| 1215        | 11-12-14-15-16-18-19-20-22-24-25-28-30-32                 |       | 47,50            | 38,10  | 0,40         | 2       | 3/8" x 16                     |                      | 5          | 20                  | 44,44  |           |           |
| 1610        | 12-14-15-16-18-19-20-22-24-25-28-30-32-35-38-40-42*       |       | 57,00            | 25,40  | 0,45         | 2       | 3/8" x 16                     |                      | 5          | 20                  | 53,97  |           |           |
| 1615        | 14-15-16-18-19-20-22-24-25-28-30-32-35-38-40-42*          |       | 57,00            | 38,10  | 0,60         | 2       | 3/8" x 16                     |                      | 5          | 20                  | 53,97  |           |           |
| 2012        | 15-16-18-19-20-22-24-25-28-30-32-35-38-40-42-45-48-50     |       | 70,00            | 31,80  | 0,80         | 2       | 7/16" x 22                    |                      | 6          | 30                  | 66,68  |           |           |
| 2517        | 18-19-20-22-24-25-28-30-32-35-38-40-42-45-48-50-55-60-65* |       | 85,70            | 44,50  | 1,70         | 2       | 1/2" x 25                     |                      | 6          | 50                  | 82,55  |           |           |
| 3020        | 25-28-30-32-35-38-40-42-45-48-50-55-60-65-70-75           |       | 108,00           | 50,80  | 3,00         | 2       | 5/8" x 32                     |                      | 8          | 90                  | 101,6  |           |           |
| 3030        | 25-28-30-32-35-38-40-42-45-48-50-55-60-65-70-75           |       | 108,00           | 76,20  | 4,00         | 2       | 5/8" x 32                     |                      | 8          | 90                  | 101,6  |           |           |
| 3525        | -35-38-40-42-45-48-50-55-60-65-70-75-80-85-90             |       | 127,00           | 65,00  | 5,00         | 3       |                               | 1/2" x 38            | 10         | 110                 | 122,68 | 80°       | 88°       |
| 3535        | -35-38-40-42-45-48-50-55-60-65-70-75-80-85-90             |       | 127,00           | 88,90  | 6,00         | 3       |                               | 1/2" x 38            | 10         | 110                 | 122,68 | 80°       | 88°       |
| 4030        | 48-50-55-60-65-70-75-80-85-90-95-100                      |       | 146,00           | 76,00  | 7,50         | 3       |                               | 5/8" x 44            | 12         | 170                 | 140,72 | 80°       | 88°       |
| 4040        | 48-50-55-60-65-70-75-80-85-90-95-100                      |       | 146,00           | 101,60 | 9,00         | 3       |                               | 5/8" x 44            | 12         | 170                 | 140,72 | 80°       | 88°       |
| 4535        | 55-60-65-70-75-80-85-90-95-100-105-110                    |       | 162,00           | 88,90  | 11,00        | 3       |                               | 3/4" x 50            | 14         | 195                 | 155,7  | 80°       | 88°       |
| 4545        | 55-60-65-70-75-80-85-90-95-100-105-110                    |       | 162,00           | 114,30 | 12,50        | 3       |                               | 3/4" x 50            | 14         | 195                 | 155,7  | 80°       | 88°       |
| 5050        | 55-60-65-70-75-80-85-90-95-100-105-110-120-125            |       | 177,60           | 127,00 | 15,00        | 3       |                               | 7/8" x 57            | 17         | 275                 | 170,68 | 83°       | 91°       |
| 6050        | da 90 a 150   |       |                  | 127,00 | 30,00        | 3       |                               | 1 1/4" x 89          | 42         | 800                 |        |           |           |
| 8050        | da 140 a 200  |       |                  | 127,00 | 40,00        | 4       |                               | 1 1/4" x 89          | 42         | 800                 |        |           |           |
| 10065       | da 180 a 250  |       |                  | 160,00 | 80,00        | 4       |                               | 1 1/2" x 108         | 50         | 1400                |        |           |           |

# PULEGGE DENTATE HTD PER BUSSOLA CONICA 8M 20-30-50-85



## Passo 8M-20

| Materiale | Cod. HFH     | Esec.<br>N°  | N°<br>Denti | Bussola<br>Tipo | Ø Prim. | Ø est. | Ø Flangia | Ø Mozzo | Ø int. | F   | L  | R  | Flangia<br>N° | Massa<br>(kg) |      |
|-----------|--------------|--------------|-------------|-----------------|---------|--------|-----------|---------|--------|-----|----|----|---------------|---------------|------|
|           |              |              |             |                 | Dp      | De     | Df        | Dm      | Di     |     |    |    |               |               |      |
| Acciaio   | PBD 22 8M-20 | 16F          | 22          | 1008            | 56,02   | 54,65  | 60        | -       | 37     | 28  | 22 | 6  | 308           | 0,25          |      |
|           | PBD 24 8M-20 | 16F          | 24          | 1108            | 61,11   | 59,74  | 66        | -       | 44     | 28  | 22 | 6  | 310           | 0,30          |      |
|           | PBD 26 8M-20 | 16F          | 26          | 1108            | 66,21   | 64,84  | 71        | -       | 45     | 28  | 22 | 6  | 311           | 0,36          |      |
|           | PBD 28 8M-20 | 16F          | 28          | 1108            | 71,30   | 70,08  | 75        | -       | 50     | 28  | 22 | 6  | 312           | 0,45          |      |
|           | PBD 30 8M-20 | 16F          | 30          | 1108            | 76,39   | 75,13  | 83        | -       | 58     | 28  | 22 | 6  | 314           | 0,55          |      |
|           | PBD 32 8M-20 | 16F          | 32          | 1610            | 81,49   | 80,16  | 87        | -       | 63     | 28  | 25 | 3  | 315           | 0,43          |      |
|           | PBD 34 8M-20 | 16F          | 34          | 1610            | 86,58   | 85,21  | 91        | -       | 64     | 28  | 25 | 3  | 316           | 0,57          |      |
|           | PBD 36 8M-20 | 16F          | 36          | 1610            | 91,67   | 90,30  | 98        | -       | 68     | 28  | 25 | 3  | 319           | 0,70          |      |
|           | PBD 38 8M-20 | 16F          | 38          | 1610            | 96,77   | 95,39  | 103       | -       | 72     | 28  | 25 | 3  | 320           | 0,82          |      |
|           | PBD 40 8M-20 | 16F          | 40          | 1610            | 101,86  | 100,49 | 106       | -       | 76     | 28  | 25 | 3  | 321           | 1,10          |      |
|           | PBD 44 8M-20 | 10F          | 44          | 2012            | 112,05  | 110,67 | 119       | 92      | -      | 28  | 32 | 4  | 325           | 1,20          |      |
|           | PBD 48 8M-20 | 10F          | 48          | 2012            | 122,23  | 120,86 | 127       | 96      | -      | 28  | 32 | 4  | 327           | 1,65          |      |
|           | PBD 56 8M-20 | 10F          | 56          | 2012            | 142,60  | 141,23 | 148       | 110     | -      | 28  | 32 | 4  | 333           | 2,50          |      |
|           | PBD 64 8M-20 | 11F          | 64          | 2012            | 162,97  | 161,60 | 168       | 110     | 137    | 28  | 32 | 4  | 338           | 2,60          |      |
|           | PBD 72 8M-20 | 11F          | 72          | 2012            | 183,35  | 181,97 | 192       | 110     | 158    | 28  | 32 | 4  | 340           | 3,40          |      |
|           | Ghisa        | PBD 80 8M-20 | 11          | 80              | 2012    | 203,72 | 202,35    | -       | 110    | 180 | 28 | 32 | 4             | -             | 3,60 |
|           |              | PBD 90 8M-20 | 11          | 90              | 2012    | 229,18 | 227,81    | -       | 110    | 204 | 28 | 32 | 4             | -             | 4,10 |

## Passo 8M-30

| Materiale     | Cod. HFH     | Esec.<br>N°  | N°<br>Denti | Bussola<br>Tipo | Ø Prim. | Ø est. | Ø Flangia | Ø Mozzo | Ø int. | F   | L  | R  | Flangia<br>N° | Massa<br>(kg) |      |
|---------------|--------------|--------------|-------------|-----------------|---------|--------|-----------|---------|--------|-----|----|----|---------------|---------------|------|
|               |              |              |             |                 | Dp      | De     | Df        | Dm      | Di     |     |    |    |               |               |      |
| Acciaio       | PBD 22 8M-30 | 16F          | 22          | 1008            | 56,02   | 54,65  | 60        | -       | 37     | 38  | 22 | 16 | 308           | 0,30          |      |
|               | PBD 24 8M-30 | 16F          | 24          | 1108            | 61,11   | 59,74  | 66        | -       | 44     | 38  | 22 | 16 | 310           | 0,40          |      |
|               | PBD 26 8M-30 | 16F          | 26          | 1108            | 66,21   | 64,84  | 71        | -       | 44     | 38  | 22 | 16 | 311           | 0,45          |      |
|               | PBD 28 8M-30 | 16F          | 28          | 1210            | 71,30   | 70,08  | 75        | -       | 50     | 38  | 25 | 13 | 312           | 0,50          |      |
|               | PBD 30 8M-30 | 15F          | 30          | 1615            | 76,39   | 75,13  | 83        | -       | -      | 38  | 38 | -  | 314           | 0,55          |      |
|               | PBD 32 8M-30 | 15F          | 32          | 1615            | 81,49   | 80,16  | 87        | -       | -      | 38  | 38 | -  | 315           | 0,60          |      |
|               | PBD 34 8M-30 | 15F          | 34          | 1615            | 86,58   | 85,21  | 91        | -       | -      | 38  | 38 | -  | 316           | 0,80          |      |
|               | PBD 36 8M-30 | 15F          | 36          | 1615            | 91,67   | 90,30  | 98        | -       | -      | 38  | 38 | -  | 319           | 1,00          |      |
|               | PBD 38 8M-30 | 15F          | 38          | 1615            | 96,77   | 95,39  | 103       | -       | -      | 38  | 38 | -  | 320           | 1,10          |      |
|               | PBD 40 8M-30 | 15F          | 40          | 1615            | 101,86  | 100,49 | 106       | -       | -      | 38  | 38 | -  | 321           | 1,34          |      |
|               | PBD 44 8M-30 | 18F          | 44          | 2012            | 112,05  | 110,67 | 119       | -       | 86     | 38  | 32 | 3  | 325           | 1,30          |      |
|               | PBD 48 8M-30 | 18F          | 48          | 2012            | 122,23  | 120,86 | 127       | -       | 90     | 38  | 32 | 3  | 327           | 1,80          |      |
|               | PBD 56 8M-30 | 18F          | 56          | 2012            | 142,60  | 141,23 | 148       | -       | 110    | 38  | 32 | 3  | 333           | 3,80          |      |
|               | PBD 64 8M-30 | 10F          | 64          | 2517            | 162,97  | 161,60 | 168       | 125     | -      | 38  | 45 | 7  | 338           | 4,30          |      |
|               | PBD 72 8M-30 | 11F          | 72          | 2517            | 183,35  | 181,97 | 192       | 125     | 158    | 38  | 45 | 7  | 340           | 4,40          |      |
|               | Ghisa        | PBD 80 8M-30 | 11          | 80              | 2517    | 203,72 | 202,35    | -       | 125    | 180 | 38 | 45 | 7             | -             | 4,65 |
|               |              | PBD 90 8M-30 | 11          | 90              | 2517    | 229,18 | 227,81    | -       | 125    | 204 | 38 | 45 | 7             | -             | 5,80 |
| PBD 112 8M-30 |              | 12           | 112         | 2517            | 285,21  | 283,83 | -         | 125     | 254    | 38  | 45 | 7  | -             | 6,20          |      |
| PBD 144 8M-30 |              | 12           | 114         | 2517            | 366,69  | 365,32 | -         | 125     | 336    | 38  | 45 | 7  | -             | 9,00          |      |

## Passo 8M-50

| Materiale    | Cod. HFH      | Esec. N° | N° Denti | Bussola Tipo | Ø Prim. Dp | Ø est. De | Ø Flangia Df | Ø Mozzo Dm | Ø int. Di | F  | L   | R   | Flangia N° | Massa (kg) |
|--------------|---------------|----------|----------|--------------|------------|-----------|--------------|------------|-----------|----|-----|-----|------------|------------|
|              |               |          |          |              |            |           |              |            |           |    |     |     |            |            |
| Acciaio      | PBD 28 8M-50  | 16F      | 28       | 1210         | 71,30      | 70,08     | 75           | -          | 50        | 60 | 25  | 35  | 312        | 0,60       |
|              | PBD 30 8M-50  | 16F      | 30       | 1615         | 76,39      | 75,13     | 83           | -          | 58        | 60 | 38  | 22  | 314        | 0,65       |
|              | PBD 32 8M-50  | 16F      | 32       | 1615         | 81,49      | 80,16     | 87           | -          | 63        | 60 | 38  | 22  | 315        | 0,80       |
|              | PBD 34 8M-50  | 16F      | 34       | 1615         | 86,58      | 85,21     | 91           | -          | 65        | 60 | 38  | 22  | 316        | 1,08       |
|              | PBD 36 8M-50  | 16F      | 36       | 1615         | 91,67      | 90,30     | 98           | -          | 68        | 60 | 38  | 22  | 319        | 1,35       |
|              | PBD 38 8M-50  | 16F      | 38       | 1615         | 96,77      | 95,39     | 103          | -          | 72        | 60 | 38  | 22  | 320        | 1,65       |
|              | PBD 40 8M-50  | 18F      | 40       | 2012         | 101,86     | 100,49    | 106          | -          | 80        | 60 | 32  | 14  | 321        | 1,70       |
|              | PBD 44 8M-50  | 18F      | 44       | 2012         | 112,05     | 110,67    | 119          | -          | 86        | 60 | 32  | 14  | 325        | 1,80       |
|              | PBD 48 8M-50  | 18F      | 48       | 2012         | 122,23     | 120,86    | 127          | -          | 95        | 60 | 32  | 14  | 327        | 2,35       |
|              | PBD 56 8M-50  | 18F      | 56       | 2517         | 142,60     | 141,23    | 148          | -          | 116       | 60 | 45  | 7,5 | 333        | 3,35       |
| PBD 64 8M-50 | 18F           | 64       | 2517     | 162,97       | 161,60     | 168       | -            | 136        | 60        | 45 | 7,5 | 338 | 4,90       |            |
| PBD 72 8M-50 | 19F           | 72       | 2517     | 183,35       | 181,97     | 192       | 125          | 158        | 60        | 45 | 7,5 | 340 | 6,90       |            |
| Ghisa        | PBD 80 8M-50  | 18       | 80       | 3020         | 203,72     | 202,35    | -            | -          | 180       | 60 | 51  | 4,5 | -          | 8,90       |
|              | PBD 90 8M-50  | 19       | 90       | 3020         | 229,18     | 227,81    | -            | 160        | 204       | 60 | 51  | 4,5 | -          | 9,90       |
|              | PBD 112 8M-50 | 19       | 112      | 3020         | 285,21     | 283,83    | -            | 170        | 254       | 60 | 51  | 4,5 | -          | 12,10      |
|              | PBD 144 8M-50 | 20       | 144      | 3020         | 366,69     | 365,32    | -            | 170        | 336       | 60 | 51  | 4,5 | -          | 15,40      |
|              | PBD 168 8M-50 | 14       | 168      | 3525         | 427,81     | 426,44    | -            | 198        | 395       | 60 | 65  | 2,5 | -          | 22,80      |
|              | PBD 192 8M-50 | 14       | 192      | 3525         | 488,92     | 487,55    | -            | 198        | 455       | 60 | 65  | 2,5 | -          | 26,50      |

## Passo 8M-85

| Materiale    | Cod. HFH      | Esec. N° | N° Denti | Bussola Tipo | Ø Prim. Dp | Ø est. De | Ø Flangia Df | Ø Mozzo Dm | Ø int. Di | F  | L  | R   | Flangia N° | Massa (kg) |
|--------------|---------------|----------|----------|--------------|------------|-----------|--------------|------------|-----------|----|----|-----|------------|------------|
|              |               |          |          |              |            |           |              |            |           |    |    |     |            |            |
| Acciaio      | PBD 34 8M-85  | 18F      | 34       | 1615         | 86,58      | 85,21     | 91           | -          | 65        | 95 | 38 | 29  | 316        | 1,50       |
|              | PBD 36 8M-85  | 18F      | 36       | 1615         | 91,67      | 90,30     | 98           | -          | 68        | 95 | 38 | 29  | 319        | 1,90       |
|              | PBD 38 8M-85  | 18F      | 38       | 1615         | 96,77      | 95,39     | 103          | -          | 72        | 95 | 38 | 29  | 320        | 2,20       |
|              | PBD 40 8M-85  | 18F      | 40       | 2012         | 101,86     | 100,49    | 106          | -          | 80        | 95 | 32 | 32  | 321        | 1,90       |
|              | PBD 44 8M-85  | 18F      | 44       | 2012         | 112,05     | 110,67    | 119          | -          | 86        | 95 | 32 | 32  | 325        | 2,30       |
|              | PBD 48 8M-85  | 18F      | 48       | 2012         | 122,23     | 120,86    | 127          | -          | 95        | 95 | 45 | 25  | 327        | 2,70       |
|              | PBD 56 8M-85  | 18F      | 56       | 2517         | 142,60     | 141,23    | 148          | -          | 116       | 95 | 45 | 25  | 333        | 4,50       |
|              | PBD 64 8M-85  | 18F      | 64       | 2517         | 162,97     | 161,60    | 168          | -          | 136       | 95 | 45 | 25  | 338        | 6,30       |
| PBD 72 8M-85 | 18F           | 72       | 2517     | 183,35       | 181,97     | 192       | 125          | 150        | 95        | 51 | 22 | 340 | 8,10       |            |
| Ghisa        | PBD 80 8M-85  | 18       | 80       | 3020         | 203,72     | 202,35    | -            | -          | 180       | 95 | 51 | 22  | -          | 10,20      |
|              | PBD 90 8M-85  | 19       | 90       | 3020         | 229,18     | 227,81    | -            | 160        | 204       | 95 | 51 | 22  | -          | 11,20      |
|              | PBD 112 8M-85 | 19       | 112      | 3020         | 285,21     | 283,83    | -            | 170        | 254       | 95 | 51 | 22  | -          | 15,00      |
|              | PBD 144 8M-85 | 20       | 144      | 3020         | 366,69     | 365,32    | -            | 170        | 336       | 95 | 65 | 15  | -          | -          |
|              | PBD 168 8M-85 | 20       | 168      | 3525         | 427,81     | 426,44    | -            | 198        | 395       | 95 | 65 | 15  | -          | -          |
|              | PBD 192 8M-85 | 20       | 192      | 3525         | 488,92     | 487,55    | -            | 198        | 455       | 95 | 65 | 15  | -          | -          |

# PULEGGE DENTATE HTD PER BUSSOLA CONICA 14M 40-55-85-115



## Passo 14M-40

| Materiale | Cod. HFH       | Esec. N° | N° Denti | Bussola Tipo | Ø Prim. Dp | Ø est. De | Ø Flangia Df | Ø Mozzo Dm | Ø int. Di | F  | L  | R   | Flangia N° | Massa (kg) |
|-----------|----------------|----------|----------|--------------|------------|-----------|--------------|------------|-----------|----|----|-----|------------|------------|
| Acciaio   | PBD 28 14M-40  | 18F      | 28       | 2012         | 124,78     | 122,12    | 127          | -          | 94        | 54 | 32 | ### | 400        | 2,10       |
|           | PBD 30 14M-40  | 18F      | 30       | 2012         | 133,69     | 130,99    | 138          | -          | 98        | 54 | 32 | ### | 401        | 2,70       |
|           | PBD 32 14M-40  | 18F      | 32       | 2012         | 142,60     | 139,88    | 154          | -          | 108       | 54 | 32 | ### | 403        | 3,40       |
|           | PBD 34 14M-40  | 18F      | 34       | 2517         | 151,52     | 148,79    | 160          | -          | 110       | 54 | 45 | 4,5 | 404        | 3,90       |
|           | PBD 36 14M-40  | 18F      | 36       | 2517         | 160,43     | 157,68    | 168          | -          | 120       | 54 | 45 | 4,5 | 405        | 4,80       |
|           | PBD 38 14M-40  | 18F      | 38       | 2517         | 169,34     | 166,60    | 183          | -          | 130       | 54 | 45 | 4,5 | 406        | 5,40       |
|           | PBD 40 14M-40  | 18F      | 40       | 2517         | 178,25     | 175,49    | 188          | -          | 138       | 54 | 45 | 4,5 | 407        | 6,00       |
|           | PBD 44 14M-40  | 18F      | 44       | 3020         | 196,08     | 193,28    | 211          | -          | 155       | 54 | 51 | 1,5 | 411        | -          |
|           | PBD 48 14M-40  | 18F      | 48       | 3020         | 213,90     | 211,11    | 226          | -          | 170       | 54 | 51 | 1,5 | 412        | -          |
| Ghisa     | PBD 56 14M-40  | 18F      | 56       | 3020         | 249,55     | 246,76    | 256          | -          | 208       | 54 | 51 | 1,5 | 416        | -          |
|           | PBD 64 14M-40  | 19F      | 64       | 3020         | 285,21     | 282,41    | 296          | 170        | 240       | 54 | 51 | 1,5 | 418        | -          |
|           | PBD 72 14M-40  | 19       | 72       | 3020         | 320,86     | 318,06    | -            | 170        | 280       | 54 | 51 | 1,5 | -          | 15,00      |
|           | PBD 80 14M-40  | 20       | 80       | 3020         | 356,51     | 353,71    | -            | 170        | 315       | 54 | 51 | 1,5 | -          | 16,00      |
|           | PBD 90 14M-40  | 20       | 90       | 3020         | 401,07     | 398,28    | -            | 170        | 360       | 54 | 51 | 1,5 | -          | 18,00      |
|           | PBD 112 14M-40 | 20       | 112      | 3020         | 499,11     | 496,32    | -            | 170        | 457       | 54 | 51 | 1,5 | -          | 25,00      |
|           | PBD 144 14M-40 | 20       | 144      | 3020         | 641,71     | 638,92    | -            | 170        | 600       | 54 | 51 | 1,5 | -          | 32,00      |
|           | PBD 168 14M-40 | 20       | 168      | 3020         | 748,66     | 745,87    | -            | 170        | 706       | 54 | 51 | 1,5 | -          | 43,50      |
|           | PBD 192 14M-40 | 20       | 192      | 3020         | 855,62     | 852,82    | -            | 170        | 813       | 54 | 51 | 1,5 | -          | 49,50      |
|           | PBD 216 14M-40 | 20       | 216      | 3535         | 962,57     | 959,76    | -            | 190        | 920       | 54 | 65 | 5,5 | -          | 62,00      |
|           | PBD 264 14M-40 | 20       | 264      | 3535         | 1176,38    | 1173,04   | -            | 190        | 1134      | 54 | 65 | 5,5 | -          | 75,00      |

## Passo 14M-55

| Materiale | Cod. HFH       | Esec. N° | N° Denti | Bussola Tipo | Ø Prim. Dp | Ø est. De | Ø Flangia Df | Ø Mozzo Dm | Ø int. Di | F  | L   | R   | Flangia N° | Massa (kg) |
|-----------|----------------|----------|----------|--------------|------------|-----------|--------------|------------|-----------|----|-----|-----|------------|------------|
| Acciaio   | PBD 28 14M-55  | 18F      | 28       | 2012         | 124,78     | 122,12    | 127          | -          | 94        | 70 | 32  | 19  | 400        | 2,20       |
|           | PBD 30 14M-55  | 18F      | 30       | 2012         | 133,69     | 130,99    | 138          | -          | 100       | 70 | 32  | 13  | 401        | 2,70       |
|           | PBD 32 14M-55  | 18F      | 32       | 2012         | 142,60     | 139,88    | 154          | -          | 108       | 70 | 32  | 13  | 403        | 3,60       |
|           | PBD 34 14M-55  | 18F      | 34       | 2517         | 151,52     | 148,79    | 160          | -          | 110       | 70 | 45  | 13  | 404        | 4,50       |
|           | PBD 36 14M-55  | 18F      | 36       | 2517         | 160,43     | 157,68    | 168          | -          | 120       | 70 | 45  | 13  | 405        | 5,20       |
|           | PBD 38 14M-55  | 18F      | 38       | 2517         | 169,34     | 166,60    | 183          | -          | 130       | 70 | 45  | 13  | 406        | 6,20       |
|           | PBD 40 14M-55  | 18F      | 40       | 2517         | 178,25     | 175,49    | 188          | -          | 138       | 70 | 45  | 13  | 407        | 6,90       |
|           | PBD 44 14M-55  | 18F      | 44       | 3020         | 196,08     | 193,28    | 211          | -          | 155       | 70 | 51  | 9,5 | 411        | 8,60       |
|           | PBD 48 14M-55  | 18F      | 48       | 3020         | 213,90     | 211,11    | 226          | -          | 170       | 70 | 51  | 9,5 | 412        | 10,50      |
| Ghisa     | PBD 56 14M-55  | 18F      | 56       | 3020         | 249,55     | 246,76    | 256          | 170        | 208       | 70 | 51  | 9,5 | 416        | 13,50      |
|           | PBD 64 14M-55  | 19F      | 64       | 3020         | 285,21     | 282,41    | 296          | 170        | 240       | 70 | 51  | 9,5 | 418        | 14,50      |
|           | PBD 72 14M-55  | 19       | 72       | 3020         | 320,86     | 318,06    | -            | 170        | 280       | 70 | 51  | 9,5 | -          | 16,30      |
|           | PBD 80 14M-55  | 20       | 80       | 3020         | 356,51     | 353,71    | -            | 170        | 315       | 70 | 51  | 9,5 | -          | 17,50      |
|           | PBD 90 14M-55  | 20       | 90       | 3020         | 401,07     | 398,28    | -            | 170        | 360       | 70 | 51  | 9,5 | -          | 20,00      |
|           | PBD 112 14M-55 | 20       | 112      | 3020         | 499,11     | 496,32    | -            | 170        | 457       | 70 | 51  | 9,5 | -          | 28,20      |
|           | PBD 144 14M-55 | 20       | 144      | 3020         | 641,71     | 638,92    | -            | 170        | 600       | 70 | 51  | 9,5 | -          | 36,00      |
|           | PBD 168 14M-55 | 20       | 168      | 3020         | 748,66     | 745,87    | -            | 170        | 706       | 70 | 51  | 9,5 | -          | 48,50      |
|           | PBD 192 14M-55 | 20       | 192      | 3020         | 855,62     | 852,82    | -            | 170        | 813       | 70 | 51  | 9,5 | -          | 52,00      |
|           | PBD 216 14M-55 | 20       | 216      | 3535         | 962,57     | 959,76    | -            | 190        | 920       | 70 | 90  | 10  | -          | 62,00      |
|           | PBD 264 14M-55 | 20       | 264      | 4040         | 1176,38    | 1173,04   | -            | 230        | 1134      | 70 | 102 | 16  | -          | 75,00      |

## Passo 14M-85

| Materiale | Cod. HFH       | Esec. N° | N° Denti | Bussola Tipo | Ø Prim. | Ø est.  | Ø Flangia | Ø Mozzo | Ø int. | F   | L   | R  | Flangia N° | Massa (kg) |
|-----------|----------------|----------|----------|--------------|---------|---------|-----------|---------|--------|-----|-----|----|------------|------------|
|           |                |          |          |              | Dp      | De      | Df        | Dm      | Di     |     |     |    |            |            |
| Acciaio   | PBD 28 14M-85  | 18F      | 28       | 2517         | 124,78  | 122,12  | 127       | -       | 98     | 102 | 45  | 29 | 400        | 2,70       |
|           | PBD 30 14M-85  | 18F      | 30       | 2517         | 133,69  | 130,99  | 138       | -       | 100    | 102 | 45  | 29 | 401        | 3,80       |
|           | PBD 32 14M-85  | 18F      | 32       | 2517         | 142,60  | 139,88  | 154       | -       | 108    | 102 | 45  | 29 | 403        | 4,70       |
|           | PBD 34 14M-85  | 18F      | 34       | 2517         | 151,52  | 148,79  | 160       | -       | 110    | 102 | 45  | 29 | 404        | 6,00       |
|           | PBD 36 14M-85  | 18F      | 36       | 3020         | 160,43  | 157,68  | 168       | -       | 125    | 102 | 51  | 26 | 405        | 5,70       |
|           | PBD 38 14M-85  | 18F      | 38       | 3020         | 169,34  | 166,60  | 183       | -       | 130    | 102 | 51  | 26 | 406        | 6,80       |
|           | PBD 40 14M-85  | 18F      | 40       | 3020         | 178,25  | 175,49  | 188       | -       | 138    | 102 | 51  | 26 | 407        | 8,00       |
|           | PBD 44 14M-85  | 18F      | 44       | 3030         | 196,08  | 193,28  | 211       | -       | 155    | 102 | 76  | 13 | 411        | 11,70      |
|           | PBD 48 14M-85  | 18F      | 48       | 3030         | 213,90  | 211,11  | 226       | -       | 170    | 102 | 76  | 13 | 412        | 15,00      |
| Ghisa     | PBD 56 14M-85  | 18F      | 56       | 3525         | 249,55  | 246,76  | 256       | -       | 210    | 102 | 65  | 19 | 416        | 19,00      |
|           | PBD 64 14M-85  | 19F      | 64       | 3525         | 285,21  | 282,41  | 296       | 190     | 240    | 102 | 65  | 19 | 418        | 23,50      |
|           | PBD 72 14M-85  | 19       | 72       | 3525         | 320,86  | 318,06  | -         | 190     | 280    | 102 | 65  | 19 | -          | 25,00      |
|           | PBD 80 14M-85  | 20       | 80       | 3525         | 356,51  | 353,71  | -         | 190     | 315    | 102 | 65  | 19 | -          | 26,00      |
|           | PBD 90 14M-85  | 20       | 90       | 3525         | 401,07  | 398,28  | -         | 190     | 360    | 102 | 65  | 19 | -          | 28,00      |
|           | PBD 112 14M-85 | 20       | 112      | 3525         | 499,11  | 496,32  | -         | 190     | 457    | 102 | 65  | 19 | -          | 36,00      |
|           | PBD 144 14M-85 | 20       | 144      | 3525         | 641,71  | 638,92  | -         | 190     | 600    | 102 | 65  | 19 | -          | 48,00      |
|           | PBD 168 14M-85 | 20       | 168      | 3525         | 748,66  | 745,87  | -         | 190     | 706    | 102 | 65  | 19 | -          | 60,00      |
|           | PBD 192 14M-85 | 22       | 192      | 4040         | 855,62  | 852,82  | -         | 230     | 813    | 102 | 102 | 19 | -          | 85,00      |
|           | PBD 216 14M-85 | 20       | 216      | 4040         | 962,57  | 959,76  | -         | 230     | 920    | 102 | 102 | 16 | -          | 100,00     |
|           | PBD 264 14M-85 | 20       | 264      | 4040         | 1176,38 | 1173,04 | -         | 230     | 1134   | 102 | 102 | 16 | -          | 115,00     |

## Passo 14M-115

| Materiale | Cod. HFH        | Esec. N° | N° Denti | Bussola Tipo | Ø Prim. | Ø est.  | Ø Flangia | Ø Mozzo | Ø int. | F   | L   | R  | Flangia N° | Massa (kg) |
|-----------|-----------------|----------|----------|--------------|---------|---------|-----------|---------|--------|-----|-----|----|------------|------------|
|           |                 |          |          |              | Dp      | De      | Df        | Dm      | Di     |     |     |    |            |            |
| Acciaio   | PBD 28 14M-115  | 18F      | 28       | 2517         | 124,78  | 122,12  | 127       | -       | 98     | 133 | 45  | 44 | 400        | 3,80       |
|           | PBD 30 14M-115  | 18F      | 30       | 2517         | 133,69  | 130,99  | 138       | -       | 100    | 133 | 45  | 44 | 401        | 5,00       |
|           | PBD 32 14M-115  | 18F      | 32       | 2517         | 142,60  | 139,88  | 154       | -       | 108    | 133 | 45  | 44 | 403        | 6,80       |
|           | PBD 34 14M-115  | 18F      | 34       | 2517         | 151,52  | 148,79  | 160       | -       | 110    | 133 | 45  | 44 | 404        | 6,90       |
|           | PBD 36 14M-115  | 18F      | 36       | 3020         | 160,43  | 157,68  | 168       | -       | 125    | 133 | 51  | 41 | 405        | 7,00       |
|           | PBD 38 14M-115  | 18F      | 38       | 3020         | 169,34  | 166,60  | 183       | -       | 130    | 133 | 51  | 41 | 406        | 8,50       |
|           | PBD 40 14M-115  | 18F      | 40       | 3020         | 178,25  | 175,49  | 188       | -       | 138    | 133 | 51  | 41 | 407        | 9,10       |
|           | PBD 44 14M-115  | 18F      | 44       | 3030         | 196,08  | 193,28  | 211       | -       | 155    | 133 | 76  | 29 | 411        | -          |
|           | PBD 48 14M-115  | 18F      | 48       | 3030         | 213,90  | 211,11  | 226       | -       | 170    | 133 | 76  | 29 | 412        | -          |
| Ghisa     | PBD 56 14M-115  | 18F      | 56       | 3525         | 249,55  | 246,76  | 256       | -       | 210    | 133 | 89  | 22 | 416        | -          |
|           | PBD 64 14M-115  | 19F      | 64       | 3525         | 285,21  | 282,41  | 296       | 190     | 240    | 133 | 89  | 22 | 418        | -          |
|           | PBD 72 14M-115  | 19       | 72       | 3525         | 320,86  | 318,06  | -         | 190     | 280    | 133 | 89  | 22 | -          | -          |
|           | PBD 80 14M-115  | 20       | 80       | 3525         | 356,51  | 353,71  | -         | 190     | 315    | 133 | 89  | 22 | -          | 32,00      |
|           | PBD 90 14M-115  | 20       | 90       | 3525         | 401,07  | 398,28  | -         | 190     | 360    | 133 | 89  | 22 | -          | 37,00      |
|           | PBD 112 14M-115 | 20       | 112      | 3525         | 499,11  | 496,32  | -         | 190     | 457    | 133 | 89  | 22 | -          | 45,00      |
|           | PBD 144 14M-115 | 20       | 144      | 3525         | 641,71  | 638,92  | -         | 230     | 600    | 133 | 102 | 16 | -          | -          |
|           | PBD 168 14M-115 | 20       | 168      | 3525         | 748,66  | 745,87  | -         | 230     | 706    | 133 | 102 | 16 | -          | -          |
|           | PBD 192 14M-115 | 20       | 192      | 4040         | 855,62  | 852,82  | -         | 230     | 813    | 133 | 102 | 16 | -          | 95,00      |
|           | PBD 216 14M-115 | 20       | 216      | 4040         | 962,57  | 959,76  | -         | 230     | 920    | 133 | 102 | 16 | -          | 115,00     |
|           | PBD 264 14M-115 | 20       | 264      | 4040         | 1176,38 | 1173,04 | -         | 230     | 1134   | 133 | 102 | 16 | -          | 130,00     |

# PULEGGE DENTATE PER BUSSOLA CONICA

## L 050-075-100



### L 050 Passo 3/8" (9.525mm)

| Materiale | Cod. HFH     | Esec. N° | N° Denti | Bussola Tipo | Ø Prim. Dp | Ø est. De | Ø Flangia Df | Ø Mozzo Dm | Ø int. Di | F  | L  | R | Flangia N° | Massa (kg) |
|-----------|--------------|----------|----------|--------------|------------|-----------|--------------|------------|-----------|----|----|---|------------|------------|
| Acciaio   | PBD 18 L 050 | 10F      | 18       | 1108         | 54,57      | 53,81     | 60           | 44         | -         | 19 | 22 | 3 | 308        | 0,20       |
|           | PBD 19 L 050 | 10F      | 19       | 1108         | 57,61      | 56,84     | 63           | 44         | -         | 19 | 22 | 3 | 309        | 0,23       |
|           | PBD 20 L 050 | 10F      | 20       | 1108         | 60,64      | 59,88     | 66           | 48         | -         | 19 | 22 | 3 | 310        | 0,27       |
|           | PBD 21 L 050 | 10F      | 21       | 1108         | 63,67      | 62,91     | 71           | 48         | -         | 19 | 22 | 3 | 311        | 0,30       |
|           | PBD 22 L 050 | 10F      | 22       | 1108         | 66,70      | 65,94     | 75           | 51         | -         | 19 | 22 | 3 | 312        | 0,34       |
|           | PBD 23 L 050 | 10F      | 23       | 1108         | 69,73      | 68,97     | 79           | 54         | -         | 19 | 22 | 3 | 313        | 0,40       |
|           | PBD 24 L 050 | 10F      | 24       | 1108         | 72,77      | 72,00     | 79           | 54         | -         | 19 | 22 | 3 | 313        | 0,45       |
|           | PBD 25 L 050 | 10F      | 25       | 1108         | 75,80      | 75,04     | 83           | 56         | -         | 19 | 22 | 3 | 314        | 0,50       |
|           | PBD 26 L 050 | 10F      | 26       | 1108         | 78,83      | 78,07     | 87           | 60         | -         | 19 | 22 | 3 | 315        | 0,55       |
|           | PBD 27 L 050 | 10F      | 27       | 1108         | 81,86      | 81,10     | 87           | 62         | -         | 19 | 22 | 3 | 315        | 0,60       |
|           | PBD 28 L 050 | 10F      | 28       | 1108         | 84,89      | 84,13     | 91           | 65         | -         | 19 | 22 | 3 | 316        | 0,65       |
|           | PBD 30 L 050 | 10F      | 30       | 1108         | 90,96      | 90,20     | 97           | 70         | -         | 19 | 22 | 3 | 318        | 0,80       |
|           | PBD 32 L 050 | 10F      | 32       | 1108         | 97,02      | 96,26     | 103          | 74         | -         | 19 | 22 | 3 | 320        | 0,98       |
|           | PBD 36 L 050 | 10F      | 36       | 1108         | 109,15     | 108,39    | 115          | 85         | -         | 19 | 22 | 3 | 323        | 1,20       |
|           | PBD 40 L 050 | 10F      | 40       | 1610         | 121,28     | 120,51    | 127          | 97         | -         | 19 | 25 | 6 | 327        | 1,40       |
|           | PBD 48 L 050 | 11F      | 48       | 1610         | 145,53     | 144,77    | 152          | 88         | 120       | 19 | 25 | 6 | 334        | 2,30       |
|           | PBD 60 L 050 | 13F      | 60       | 1610         | 181,91     | 181,15    | -            | 92         | 166       | 19 | 25 | 3 | -          | 2,20       |

### L 075 Passo 3/8" (9.525mm)

| Materiale | Cod. HFH     | Esec. N° | N° Denti | Bussola Tipo | Ø Prim. Dp | Ø est. De | Ø Flangia Df | Ø Mozzo Dm | Ø int. Di | F  | L  | R | Flangia N° | Massa (kg) |
|-----------|--------------|----------|----------|--------------|------------|-----------|--------------|------------|-----------|----|----|---|------------|------------|
| Acciaio   | PBD 18 L 075 | 15F      | 18       | 1108         | 54,57      | 53,81     | 60           | -          | -         | 25 | 25 | - | 308        | 0,25       |
|           | PBD 19 L 075 | 15F      | 19       | 1108         | 57,61      | 56,84     | 63           | -          | -         | 25 | 25 | - | 309        | 0,32       |
|           | PBD 20 L 075 | 15F      | 20       | 1108         | 60,64      | 59,88     | 66           | -          | -         | 25 | 25 | - | 310        | 0,35       |
|           | PBD 21 L 075 | 15F      | 21       | 1108         | 63,67      | 62,91     | 71           | -          | -         | 25 | 25 | - | 311        | 0,40       |
|           | PBD 22 L 075 | 15F      | 22       | 1108         | 66,70      | 65,94     | 75           | -          | -         | 25 | 25 | - | 312        | 0,44       |
|           | PBD 23 L 075 | 15F      | 23       | 1108         | 69,73      | 68,97     | 79           | -          | -         | 25 | 25 | - | 313        | 0,48       |
|           | PBD 24 L 075 | 15F      | 24       | 1108         | 72,77      | 72,00     | 79           | -          | -         | 25 | 25 | - | 313        | 0,55       |
|           | PBD 25 L 075 | 15F      | 25       | 1108         | 75,80      | 75,04     | 83           | -          | -         | 25 | 25 | - | 314        | 0,63       |
|           | PBD 26 L 075 | 15F      | 26       | 1108         | 78,83      | 78,07     | 87           | -          | -         | 25 | 25 | - | 315        | 0,66       |
|           | PBD 27 L 075 | 15F      | 27       | 1108         | 81,86      | 81,10     | 87           | -          | -         | 25 | 25 | - | 315        | 0,70       |
|           | PBD 28 L 075 | 15F      | 28       | 1108         | 84,89      | 84,13     | 91           | -          | -         | 25 | 25 | - | 316        | 0,72       |
|           | PBD 30 L 075 | 15F      | 30       | 1108         | 90,96      | 90,20     | 97           | -          | -         | 25 | 25 | - | 318        | 0,93       |
|           | PBD 32 L 075 | 15F      | 32       | 1108         | 97,02      | 96,26     | 103          | -          | -         | 25 | 25 | - | 320        | 1,10       |
|           | PBD 36 L 075 | 15F      | 36       | 1108         | 109,15     | 108,39    | 115          | -          | -         | 25 | 25 | - | 323        | 1,20       |
|           | PBD 40 L 075 | 15F      | 40       | 1610         | 121,28     | 120,51    | 127          | -          | -         | 25 | 25 | - | 327        | 1,70       |
|           | PBD 48 L 075 | 21F      | 48       | 1610         | 145,53     | 144,77    | 152          | 92         | 120       | 25 | 25 | - | 334        | 2,60       |
|           | PBD 60 L 075 | 21F      | 60       | 1610         | 181,91     | 181,15    | -            | 92         | 166       | 25 | 25 | - | -          | 3,00       |



## L 100      Passo 3/8" (9.525mm)

| Materiale | Cod.          | HFH | Esec.<br>N° | N°<br>Denti | Bussola<br>Tipo | Ø Prim.<br>Dp | Ø est.<br>De | Ø Flangia<br>Df | Ø Mozzo<br>Dm | Ø int.<br>Di | F  | L  | R   | Flangia<br>N° | Massa<br>(kg) |
|-----------|---------------|-----|-------------|-------------|-----------------|---------------|--------------|-----------------|---------------|--------------|----|----|-----|---------------|---------------|
| Acciaio   | PBD 18 L 100  |     | 15F         | 18          | 1108            | 54,57         | 53,81        | 60              | -             | 38           | 31 | 22 | 9   | 308           | 0,20          |
|           | PBD 19 L 100  |     | 15F         | 19          | 1108            | 57,61         | 56,84        | 63              | -             | 38           | 31 | 22 | 9   | 309           | 0,32          |
|           | PBD 20 L 100  |     | 15F         | 20          | 1108            | 60,64         | 59,88        | 66              | -             | 45           | 31 | 22 | 9   | 310           | 0,41          |
|           | PBD 21 L 100  |     | 15F         | 21          | 1108            | 63,67         | 62,91        | 71              | -             | 45           | 31 | 22 | 9   | 311           | 0,45          |
|           | PBD 22 L 100  |     | 15F         | 22          | 1108            | 66,70         | 65,94        | 75              | -             | 48           | 31 | 22 | 9   | 312           | 0,47          |
|           | PBD 23 L 100  |     | 15F         | 23          | 1108            | 69,73         | 68,97        | 79              | -             | 52           | 32 | 22 | 10  | 313           | 0,50          |
|           | PBD 24 L 100  |     | 15F         | 24          | 1108            | 72,77         | 72,00        | 79              | -             | 52           | 32 | 22 | 10  | 313           | 0,64          |
|           | PBD 25 L 100  |     | 15F         | 25          | 1108            | 75,80         | 75,04        | 83              | -             | 54           | 32 | 22 | 10  | 314           | 0,68          |
|           | PBD 26 L 100  |     | 15F         | 26          | 1108            | 78,83         | 78,07        | 87              | -             | 60           | 32 | 22 | 10  | 315           | 0,70          |
|           | PBD 27 L 100  |     | 15F         | 27          | 1108            | 81,86         | 81,10        | 87              | -             | 60           | 32 | 22 | 10  | 315           | 0,83          |
|           | PBD 28 L 100  |     | 15F         | 28          | 1108            | 84,89         | 84,13        | 91              | -             | 65           | 32 | 22 | 10  | 316           | 0,85          |
|           | PBD 30 L 100  |     | 15F         | 30          | 1210            | 90,96         | 90,20        | 97              | -             | 71           | 32 | 25 | 7   | 318           | 0,90          |
|           | PBD 32 L 100  |     | 15F         | 32          | 1210            | 97,02         | 96,26        | 103             | -             | 75           | 32 | 25 | 7   | 320           | 1,05          |
|           | PBD 36 L 100  |     | 15F         | 36          | 1610            | 109,15        | 108,39       | 115             | -             | 86           | 32 | 25 | 7   | 323           | 1,40          |
|           | PBD 40 L 100  |     | 15F         | 40          | 1610            | 121,28        | 120,51       | 127             | -             | 96           | 32 | 25 | 7   | 327           | 1,65          |
|           | PBD 48 L 100  |     | 21F         | 48          | 1610            | 145,53        | 144,77       | 152             | 92            | 120          | 32 | 25 | 7   | 334           | 2,8           |
|           | PBD 60 L 100  |     | 21F         | 60          | 1610            | 181,91        | 181,15       | -               | 92            | 166          | 32 | 25 | 3,5 | -             | 2,7           |
| Ghisa     | PBD 72 L 100  |     | 22          | 72          | 2012            | 218,30        | 217,53       | -               | 106           | 202          | 32 | 32 | -   | -             | 2,96          |
|           | PBD 84 L 100  |     | 14          | 84          | 1610            | 254,68        | 253,90       | -               | 106           | 236          | 32 | 32 | -   | -             | 3,87          |
|           | PBD 96 L 100  |     | 14          | 96          | 2012            | 291,06        | 290,30       | -               | 106           | 270          | 32 | 32 | -   | -             | 4,64          |
|           | PBD 120 L 100 |     | 14          | 120         | 2012            | 363,83        | 363,07       | -               | 106           | 343          | 32 | 32 | -   | -             | 6,37          |

# PULEGGE DENTATE PER BUSSOLA CONICA L 050-075-100



## L 050      Passo 3/8" (9.525mm)

| Materiale | Cod. HFH     | Esec.<br>N° | N°<br>Denti | Bussola<br>Tipo | Ø Prim.<br>Dp | Ø est.<br>De | Ø Flangia<br>Df | Ø Mozzo<br>Dm | Ø int.<br>Di | F  | L  | R | Flangia<br>N° | Massa<br>(kg) |
|-----------|--------------|-------------|-------------|-----------------|---------------|--------------|-----------------|---------------|--------------|----|----|---|---------------|---------------|
|           |              |             |             |                 |               |              |                 |               |              |    |    |   |               |               |
| Acciaio   | PBD 18 L 050 | 10F         | 18          | 1108            | 54,57         | 53,81        | 60              | 44            | -            | 19 | 22 | 3 | 308           | 0,20          |
|           | PBD 19 L 050 | 10F         | 19          | 1108            | 57,61         | 56,84        | 63              | 44            | -            | 19 | 22 | 3 | 309           | 0,23          |
|           | PBD 20 L 050 | 10F         | 20          | 1108            | 60,64         | 59,88        | 66              | 48            | -            | 19 | 22 | 3 | 310           | 0,27          |
|           | PBD 21 L 050 | 10F         | 21          | 1108            | 63,67         | 62,91        | 71              | 48            | -            | 19 | 22 | 3 | 311           | 0,30          |
|           | PBD 22 L 050 | 10F         | 22          | 1108            | 66,70         | 65,94        | 75              | 51            | -            | 19 | 22 | 3 | 312           | 0,34          |
|           | PBD 23 L 050 | 10F         | 23          | 1108            | 69,73         | 68,97        | 79              | 54            | -            | 19 | 22 | 3 | 313           | 0,40          |
|           | PBD 24 L 050 | 10F         | 24          | 1108            | 72,77         | 72,00        | 79              | 54            | -            | 19 | 22 | 3 | 313           | 0,45          |
|           | PBD 25 L 050 | 10F         | 25          | 1108            | 75,80         | 75,04        | 83              | 56            | -            | 19 | 22 | 3 | 314           | 0,50          |
|           | PBD 26 L 050 | 10F         | 26          | 1108            | 78,83         | 78,07        | 87              | 60            | -            | 19 | 22 | 3 | 315           | 0,55          |
|           | PBD 27 L 050 | 10F         | 27          | 1108            | 81,86         | 81,10        | 87              | 62            | -            | 19 | 22 | 3 | 315           | 0,60          |
|           | PBD 28 L 050 | 10F         | 28          | 1108            | 84,89         | 84,13        | 91              | 65            | -            | 19 | 22 | 3 | 316           | 0,65          |
|           | PBD 30 L 050 | 10F         | 30          | 1108            | 90,96         | 90,20        | 97              | 70            | -            | 19 | 22 | 3 | 318           | 0,80          |
|           | PBD 32 L 050 | 10F         | 32          | 1108            | 97,02         | 96,26        | 103             | 74            | -            | 19 | 22 | 3 | 320           | 0,98          |
|           | PBD 36 L 050 | 10F         | 36          | 1108            | 109,15        | 108,39       | 115             | 85            | -            | 19 | 22 | 3 | 323           | 1,20          |
|           | PBD 40 L 050 | 10F         | 40          | 1610            | 121,28        | 120,51       | 127             | 97            | -            | 19 | 25 | 6 | 327           | 1,40          |
|           | PBD 48 L 050 | 11F         | 48          | 1610            | 145,53        | 144,77       | 152             | 88            | 120          | 19 | 25 | 6 | 334           | 2,30          |
|           | PBD 60 L 050 | 13F         | 60          | 1610            | 181,91        | 181,15       | -               | 92            | 166          | 19 | 25 | 3 | -             | 2,20          |

## L 075      Passo 3/8" (9.525mm)

| Materiale | Cod. HFH     | Esec.<br>N° | N°<br>Denti | Bussola<br>Tipo | Ø Prim.<br>Dp | Ø est.<br>De | Ø Flangia<br>Df | Ø Mozzo<br>Dm | Ø int.<br>Di | F  | L  | R | Flangia<br>N° | Massa<br>(kg) |
|-----------|--------------|-------------|-------------|-----------------|---------------|--------------|-----------------|---------------|--------------|----|----|---|---------------|---------------|
|           |              |             |             |                 |               |              |                 |               |              |    |    |   |               |               |
| Acciaio   | PBD 18 L 075 | 15F         | 18          | 1108            | 54,57         | 53,81        | 60              | -             | -            | 25 | 25 | - | 308           | 0,25          |
|           | PBD 19 L 075 | 15F         | 19          | 1108            | 57,61         | 56,84        | 63              | -             | -            | 25 | 25 | - | 309           | 0,32          |
|           | PBD 20 L 075 | 15F         | 20          | 1108            | 60,64         | 59,88        | 66              | -             | -            | 25 | 25 | - | 310           | 0,35          |
|           | PBD 21 L 075 | 15F         | 21          | 1108            | 63,67         | 62,91        | 71              | -             | -            | 25 | 25 | - | 311           | 0,40          |
|           | PBD 22 L 075 | 15F         | 22          | 1108            | 66,70         | 65,94        | 75              | -             | -            | 25 | 25 | - | 312           | 0,44          |
|           | PBD 23 L 075 | 15F         | 23          | 1108            | 69,73         | 68,97        | 79              | -             | -            | 25 | 25 | - | 313           | 0,48          |
|           | PBD 24 L 075 | 15F         | 24          | 1108            | 72,77         | 72,00        | 79              | -             | -            | 25 | 25 | - | 313           | 0,55          |
|           | PBD 25 L 075 | 15F         | 25          | 1108            | 75,80         | 75,04        | 83              | -             | -            | 25 | 25 | - | 314           | 0,63          |
|           | PBD 26 L 075 | 15F         | 26          | 1108            | 78,83         | 78,07        | 87              | -             | -            | 25 | 25 | - | 315           | 0,66          |
|           | PBD 27 L 075 | 15F         | 27          | 1108            | 81,86         | 81,10        | 87              | -             | -            | 25 | 25 | - | 315           | 0,70          |
|           | PBD 28 L 075 | 15F         | 28          | 1108            | 84,89         | 84,13        | 91              | -             | -            | 25 | 25 | - | 316           | 0,72          |
|           | PBD 30 L 075 | 15F         | 30          | 1108            | 90,96         | 90,20        | 97              | -             | -            | 25 | 25 | - | 318           | 0,93          |
|           | PBD 32 L 075 | 15F         | 32          | 1108            | 97,02         | 96,26        | 103             | -             | -            | 25 | 25 | - | 320           | 1,10          |
|           | PBD 36 L 075 | 15F         | 36          | 1108            | 109,15        | 108,39       | 115             | -             | -            | 25 | 25 | - | 323           | 1,20          |
|           | PBD 40 L 075 | 15F         | 40          | 1610            | 121,28        | 120,51       | 127             | -             | -            | 25 | 25 | - | 327           | 1,70          |
|           | PBD 48 L 075 | 21F         | 48          | 1610            | 145,53        | 144,77       | 152             | 92            | 120          | 25 | 25 | - | 334           | 2,60          |
|           | PBD 60 L 075 | 21F         | 60          | 1610            | 181,91        | 181,15       | -               | 92            | 166          | 25 | 25 | - | -             | 3,00          |

## L 100      Passo 3/8" (9.525mm)

| Materiale     | Cod.         | HFH          | Esec.<br>N° | N°<br>Denti | Bussola<br>Tipo | Ø Prim.<br>Dp | Ø est.<br>De | Ø Flangia<br>Df | Ø Mozzo<br>Dm | Ø int.<br>Di | F   | L  | R   | Flangia<br>N° | Massa<br>(kg) |
|---------------|--------------|--------------|-------------|-------------|-----------------|---------------|--------------|-----------------|---------------|--------------|-----|----|-----|---------------|---------------|
| Acciaio       | PBD 18 L 100 |              | 15F         | 18          | 1108            | 54,57         | 53,81        | 60              | -             | 38           | 31  | 22 | 9   | 308           | 0,20          |
|               | PBD 19 L 100 |              | 15F         | 19          | 1108            | 57,61         | 56,84        | 63              | -             | 38           | 31  | 22 | 9   | 309           | 0,32          |
|               | PBD 20 L 100 |              | 15F         | 20          | 1108            | 60,64         | 59,88        | 66              | -             | 45           | 31  | 22 | 9   | 310           | 0,41          |
|               | PBD 21 L 100 |              | 15F         | 21          | 1108            | 63,67         | 62,91        | 71              | -             | 45           | 31  | 22 | 9   | 311           | 0,45          |
|               | PBD 22 L 100 |              | 15F         | 22          | 1108            | 66,70         | 65,94        | 75              | -             | 48           | 31  | 22 | 9   | 312           | 0,47          |
|               | PBD 23 L 100 |              | 15F         | 23          | 1108            | 69,73         | 68,97        | 79              | -             | 52           | 32  | 22 | 10  | 313           | 0,50          |
|               | PBD 24 L 100 |              | 15F         | 24          | 1108            | 72,77         | 72,00        | 79              | -             | 52           | 32  | 22 | 10  | 313           | 0,64          |
|               | PBD 25 L 100 |              | 15F         | 25          | 1108            | 75,80         | 75,04        | 83              | -             | 54           | 32  | 22 | 10  | 314           | 0,68          |
|               | PBD 26 L 100 |              | 15F         | 26          | 1108            | 78,83         | 78,07        | 87              | -             | 60           | 32  | 22 | 10  | 315           | 0,70          |
|               | PBD 27 L 100 |              | 15F         | 27          | 1108            | 81,86         | 81,10        | 87              | -             | 60           | 32  | 22 | 10  | 315           | 0,83          |
|               | PBD 28 L 100 |              | 15F         | 28          | 1108            | 84,89         | 84,13        | 91              | -             | 65           | 32  | 22 | 10  | 316           | 0,85          |
|               | PBD 30 L 100 |              | 15F         | 30          | 1210            | 90,96         | 90,20        | 97              | -             | 71           | 32  | 25 | 7   | 318           | 0,90          |
|               | PBD 32 L 100 |              | 15F         | 32          | 1210            | 97,02         | 96,26        | 103             | -             | 75           | 32  | 25 | 7   | 320           | 1,05          |
|               | PBD 36 L 100 |              | 15F         | 36          | 1610            | 109,15        | 108,39       | 115             | -             | 86           | 32  | 25 | 7   | 323           | 1,40          |
|               | PBD 40 L 100 |              | 15F         | 40          | 1610            | 121,28        | 120,51       | 127             | -             | 96           | 32  | 25 | 7   | 327           | 1,65          |
|               | PBD 48 L 100 |              | 21F         | 48          | 1610            | 145,53        | 144,77       | 152             | 92            | 120          | 32  | 25 | 7   | 334           | 2,8           |
|               | PBD 60 L 100 |              | 21F         | 60          | 1610            | 181,91        | 181,15       | -               | 92            | 166          | 32  | 25 | 3,5 | -             | 2,7           |
|               | Ghisa        | PBD 72 L 100 |             | 22          | 72              | 2012          | 218,30       | 217,53          | -             | 106          | 202 | 32 | 32  | -             | -             |
| PBD 84 L 100  |              |              | 14          | 84          | 1610            | 254,68        | 253,90       | -               | 106           | 236          | 32  | 32 | -   | -             | 3,87          |
| PBD 96 L 100  |              |              | 14          | 96          | 2012            | 291,06        | 290,30       | -               | 106           | 270          | 32  | 32 | -   | -             | 4,64          |
| PBD 120 L 100 |              |              | 14          | 120         | 2012            | 363,83        | 363,07       | -               | 106           | 343          | 32  | 32 | -   | -             | 6,37          |

# PULEGGE DENTATE XL037



## XL037 Passo 1/5" (5.08mm)

| Materiale | Codice<br>HFH | Esec.<br>N° | N°<br>Denti | Ø Prim.<br>Dp | Ø est.<br>De | Ø Flangia<br>Df | Ø Mozzo<br>Dm | Ø int.<br>Di | L    | Ø preforo<br>d | Flangia<br>N° | Massa<br>(kg) |
|-----------|---------------|-------------|-------------|---------------|--------------|-----------------|---------------|--------------|------|----------------|---------------|---------------|
| Alluminio | 10 XL 037     | 2F          | 10          | 16,17         | 15,66        | 23,00           | 10            | 14,3         | 20,0 | -              | 201           | 0,01          |
|           | 11 XL 037     | 2F          | 11          | 17,19         | 17,28        | 23,00           | 10            | 14,3         | 20,0 | -              | 201           | 0,01          |
|           | 12 XL 037     | 2F          | 12          | 19,40         | 18,90        | 25,00           | 10            | 14,3         | 20,0 | -              | 203           | 0,01          |
|           | 13 XL 037     | 2F          | 13          | 21,02         | 20,51        | 25,00           | 10            | 14,3         | 20,0 | -              | 203           | 0,01          |
|           | 14 XL 037     | 2F          | 14          | 22,64         | 23,13        | 28,00           | 16            | 14,3         | 20,0 | -              | 204           | 0,02          |
|           | 15 XL 037     | 2F          | 15          | 24,25         | 23,75        | 28,00           | 16            | 14,3         | 20,0 | -              | 204           | 0,02          |
|           | 16 XL 037     | 2F          | 16          | 25,87         | 25,36        | 32,00           | 16            | 14,3         | 20,0 | -              | 205           | 0,03          |
|           | 17 XL 037     | 2F          | 17          | 27,49         | 26,98        | 32,00           | 20            | 14,3         | 20,0 | -              | 205           | 0,03          |
|           | 18 XL 037     | 2F          | 18          | 29,11         | 28,60        | 36,00           | 20            | 14,3         | 20,0 | -              | 206           | 0,04          |
|           | 19 XL 037     | 2F          | 19          | 30,72         | 30,21        | 36,00           | 20            | 14,3         | 22,0 | -              | 206           | 0,04          |
|           | 20 XL 037     | 2F          | 20          | 32,34         | 31,83        | 38,00           | 25            | 14,3         | 22,0 | -              | 207           | 0,05          |
|           | 21 XL 037     | 2F          | 21          | 33,96         | 33,45        | 38,00           | 25            | 14,3         | 22,0 | -              | 207           | 0,05          |
|           | 22 XL 037     | 2F          | 22          | 35,57         | 35,07        | 42,00           | 25            | 14,3         | 22,0 | -              | 208           | 0,06          |
|           | 24 XL 037     | 2F          | 24          | 38,81         | 38,30        | 44,00           | 30            | 14,3         | 22,0 | -              | 209           | 0,06          |
|           | 26 XL 037     | 2F          | 26          | 42,04         | 41,53        | 48,00           | 30            | 14,3         | 22,0 | 8              | 210           | 0,09          |
|           | 27 XL 037     | 2F          | 27          | 43,66         | 43,15        | 48,00           | 34            | 14,3         | 22,0 | 8              | 210           | 0,09          |
|           | 28 XL 037     | 2F          | 28          | 45,28         | 44,77        | 51,00           | 34            | 14,3         | 22,0 | 8              | 211           | 0,1           |
|           | 30 XL 037     | 2F          | 30          | 48,51         | 48,00        | 54,00           | 38            | 14,3         | 22,0 | 8              | 212           | 0,12          |
|           | 32 XL 037     | 2F          | 32          | 51,74         | 51,24        | 57,00           | 38            | 14,3         | 25,0 | 8              | 213           | 0,12          |
|           | 34 XL 037     | 2F          | 34          | 54,98         | 54,47        | 60,00           | 38            | 14,3         | 25,0 | 8              | 214           | 0,13          |
|           | 35 XL 037     | 2F          | 35          | 56,60         | 56,09        | 63,00           | 38            | 14,3         | 25,0 | 8              | 215           | 0,14          |
|           | 36 XL 037     | 2           | 36          | 58,21         | 57,70        | -               | 45            | 14,3         | 25,0 | 8              | -             | 0,14          |
|           | 38 XL 037     | 2           | 38          | 61,45         | 60,94        | -               | 45            | 14,3         | 25,0 | 8              | -             | 0,15          |
|           | 40 XL 037     | 2           | 40          | 64,68         | 64,17        | -               | 45            | 14,3         | 25,0 | 8              | -             | 0,16          |
|           | 42 XL 037     | 2           | 42          | 67,91         | 67,41        | -               | 45            | 14,3         | 25,0 | 8              | -             | 0,18          |
|           | 44 XL 037     | 2           | 44          | 71,15         | 70,64        | -               | 45            | 14,3         | 25,0 | 8              | -             | 0,19          |
|           | 48 XL 037     | 2           | 48          | 77,62         | 77,11        | -               | 45            | 14,3         | 25,0 | 10             | -             | 0,19          |
|           | 52 XL 037     | 2           | 52          | 84,08         | 83,57        | -               | 45            | 14,3         | 25,0 | 10             | -             | 0,19          |
|           | 60 XL 037     | 2           | 60          | 97,02         | 96,61        | -               | 45            | 14,3         | 25,0 | 10             | -             | 0,22          |
|           | 72 XL 037     | 2           | 72          | 116,42        | 115,92       | -               | 45            | 14,3         | 25,0 | 10             | -             | 0,44          |

# PULEGGE DENTATE L 050 - 075 - 100



## L 050 Passo 3/8" (9.525mm)

| Materiale | Cod. HFH | Esec. N° | N° Denti | Ø Prim. Dp | Ø est. De | Ø Flangia Df | Ø Mozzo Dm | F    | L    | Ø preforo d | Flangia N° | Massa (kg) |      |
|-----------|----------|----------|----------|------------|-----------|--------------|------------|------|------|-------------|------------|------------|------|
| Acciaio   | 10 L 050 | 2F       | 10       | 30,32      | 29,56     | 36           | 20         | 19,0 | 28   | 8           | 300        | 0,11       |      |
|           | 11 L 050 | 2F       | 11       | 33,35      | 32,59     | 38           | 24         | 19,0 | 30   | 8           | 301        | 0,14       |      |
|           | 12 L 050 | 2F       | 12       | 36,38      | 35,62     | 42           | 24         | 19,0 | 30   | 8           | 302        | 0,17       |      |
|           | 13 L 050 | 2F       | 13       | 39,41      | 38,65     | 44           | 28         | 19,0 | 30   | 8           | 303        | 0,21       |      |
|           | 14 L 050 | 2F       | 14       | 42,44      | 41,68     | 48           | 28         | 19,0 | 30   | 8           | 304        | 0,24       |      |
|           | 15 L 050 | 2F       | 15       | 45,44      | 44,72     | 51           | 34         | 19,0 | 30   | 8           | 305        | 0,29       |      |
|           | 16 L 050 | 2F       | 16       | 48,51      | 47,75     | 54           | 36         | 19,0 | 32   | 8           | 306        | 0,33       |      |
|           | 17 L 050 | 2F       | 17       | 51,54      | 50,78     | 57           | 36         | 19,0 | 32   | 10          | 307        | 0,38       |      |
|           | 18 L 050 | 2F       | 18       | 54,57      | 53,81     | 60           | 40         | 19,0 | 32   | 10          | 308        | 0,44       |      |
|           | 19 L 050 | 2F       | 19       | 57,61      | 56,84     | 63           | 40         | 19,0 | 32   | 10          | 309        | 0,47       |      |
|           | 20 L 050 | 2F       | 20       | 60,64      | 59,88     | 66           | 40         | 19,0 | 32   | 10          | 310        | 0,51       |      |
|           | 21 L 050 | 2F       | 21       | 63,67      | 62,91     | 71           | 45         | 19,0 | 32   | 10          | 311        | 0,60       |      |
|           | 22 L 050 | 2F       | 22       | 66,70      | 65,94     | 75           | 45         | 19,0 | 32   | 10          | 312        | 0,64       |      |
|           | 23 L 050 | 2F       | 23       | 69,73      | 68,97     | 79           | 55         | 19,0 | 32   | 10          | 313        | 0,78       |      |
|           | 24 L 050 | 2F       | 24       | 72,77      | 72,00     | 79           | 55         | 19,0 | 32   | 10          | 313        | 0,81       |      |
|           | 25 L 050 | 2F       | 25       | 75,80      | 75,04     | 83           | 58         | 19,0 | 32   | 10          | 314        | 0,89       |      |
|           | 26 L 050 | 2F       | 26       | 78,83      | 78,07     | 87           | 58         | 19,0 | 32   | 12          | 315        | 0,94       |      |
|           | 27 L 050 | 2F       | 27       | 81,86      | 81,10     | 87           | 58         | 19,0 | 32   | 12          | 315        | 0,99       |      |
|           | 28 L 050 | 2F       | 28       | 84,89      | 84,13     | 91           | 58         | 19,0 | 32   | 12          | 316        | 1,04       |      |
|           | 30 L 050 | 2F       | 30       | 90,96      | 90,20     | 97           | 70         | 19,0 | 32   | 12          | 318        | 1,17       |      |
|           | 32 L 050 | 2F       | 32       | 97,03      | 96,26     | 103          | 70         | 19,0 | 32   | 12          | 320        | 1,41       |      |
|           | 33 L 050 | 2F       | 33       | 100,05     | 99,29     | 106          | 70         | 19,0 | 32   | 12          | 321        | 1,49       |      |
|           | 34 L 050 | 2F       | 34       | 103,08     | 102,32    | 111          | 70         | 19,0 | 32   | 12          | 322        | 1,57       |      |
|           | 35 L 050 | 2F       | 35       | 106,12     | 105,35    | 111          | 70         | 19,0 | 32   | 12          | 322        | 1,62       |      |
|           | 36 L 050 | 2F       | 36       | 109,15     | 108,39    | 115          | 70         | 19,0 | 32   | 12          | 323        | 1,70       |      |
|           | 40 L 050 | 2F       | 40       | 121,29     | 120,51    | 127          | 70         | 19,0 | 32   | 12          | 327        | 2,03       |      |
|           | 42 L 050 | 2F       | 42       | 127,34     | 126,58    | 135          | 70         | 19,0 | 32   | 12          | 328        | 2,21       |      |
|           | 44 L 050 | 2F       | 44       | 133,40     | 132,64    | 140          | 70         | 19,0 | 32   | 12          | 330        | 2,38       |      |
|           | 45 L 050 | 2F       | 45       | 136,44     | 135,67    | 143          | 70         | 19,0 | 32   | 12          | 331        | 2,48       |      |
|           | 48 L 050 | 2F       | 48       | 145,53     | 144,77    | 152          | 70         | 19,0 | 32   | 12          | 334        | 2,78       |      |
|           | Ghisa    | 50 L 050 | 4        | 50         | 151,60    | 150,83       | -          | 70   | 19,0 | 32          | 14         | -          | 1,74 |
|           |          | 52 L 050 | 4        | 52         | 157,66    | 156,90       | -          | 70   | 19,0 | 32          | 14         | -          | 1,80 |
|           |          | 56 L 050 | 4        | 56         | 169,79    | 169,02       | -          | 70   | 19,0 | 32          | 14         | -          | 1,87 |
|           |          | 57 L 050 | 4        | 57         | 172,82    | 172,06       | -          | 70   | 19,0 | 32          | 14         | -          | 1,88 |
|           |          | 60 L 050 | 4        | 60         | 181,91    | 181,15       | -          | 75   | 19,0 | 42          | 14         | -          | 2,41 |
|           |          | 72 L 050 | 4        | 72         | 218,29    | 217,53       | -          | 75   | 19,0 | 42          | 14         | -          | 2,82 |
| 84 L 050  |          | 4        | 84       | 254,68     | 253,92    | -            | 75         | 19,0 | 42   | 14          | -          | 3,08       |      |

## L 075

## Passo 3/8" (9.525mm)

| Materiale | Cod. HFH | Esec.<br>N° | N°<br>Denti | Ø Prim.<br>Dp | Ø est.<br>De | Ø Flangia<br>Df | Ø Mozzo<br>Dm | F    | L  | Ø preforo<br>d | Flangia<br>N° | Massa<br>(kg) |
|-----------|----------|-------------|-------------|---------------|--------------|-----------------|---------------|------|----|----------------|---------------|---------------|
| Acciaio   | 10 L 075 | 2F          | 10          | 30,32         | 29,56        | 36              | 20            | 25,4 | 38 | 8              | 300           | 0,14          |
|           | 11 L 075 | 2F          | 11          | 33,35         | 32,59        | 38              | 24            | 25,4 | 38 | 8              | 301           | 0,18          |
|           | 12 L 075 | 2F          | 12          | 36,38         | 35,62        | 42              | 24            | 25,4 | 38 | 8              | 302           | 0,22          |
|           | 13 L 075 | 2F          | 13          | 39,41         | 38,65        | 44              | 28            | 25,4 | 38 | 8              | 303           | 0,26          |
|           | 14 L 075 | 2F          | 14          | 42,44         | 41,68        | 48              | 28            | 25,4 | 38 | 8              | 304           | 0,30          |
|           | 15 L 075 | 2F          | 15          | 45,44         | 44,72        | 51              | 34            | 25,4 | 38 | 8              | 305           | 0,37          |
|           | 16 L 075 | 2F          | 16          | 48,51         | 47,75        | 54              | 36            | 25,4 | 38 | 8              | 306           | 0,43          |
|           | 17 L 075 | 2F          | 17          | 51,54         | 50,78        | 57              | 36            | 25,4 | 38 | 10             | 307           | 0,46          |
|           | 18 L 075 | 2F          | 18          | 54,57         | 53,81        | 60              | 40            | 25,4 | 38 | 10             | 308           | 0,54          |
|           | 19 L 075 | 2F          | 19          | 57,61         | 56,84        | 63              | 40            | 25,4 | 38 | 10             | 309           | 0,58          |
|           | 20 L 075 | 2F          | 20          | 60,64         | 59,88        | 66              | 40            | 25,4 | 38 | 10             | 310           | 0,64          |
|           | 21 L 075 | 2F          | 21          | 63,67         | 62,91        | 71              | 45            | 25,4 | 38 | 10             | 311           | 0,71          |
|           | 22 L 075 | 2F          | 22          | 66,70         | 65,94        | 75              | 45            | 25,4 | 38 | 10             | 312           | 0,79          |
|           | 23 L 075 | 2F          | 23          | 69,73         | 68,97        | 79              | 55            | 25,4 | 38 | 10             | 313           | 0,94          |
|           | 24 L 075 | 2F          | 24          | 72,77         | 72,00        | 79              | 55            | 25,4 | 38 | 10             | 313           | 1,00          |
|           | 25 L 075 | 2F          | 25          | 75,80         | 75,04        | 83              | 58            | 25,4 | 38 | 10             | 314           | 1,10          |
|           | 26 L 075 | 2F          | 26          | 78,83         | 78,07        | 87              | 58            | 25,4 | 38 | 12             | 315           | 1,16          |
|           | 27 L 075 | 2F          | 27          | 81,86         | 81,10        | 87              | 58            | 25,4 | 38 | 12             | 315           | 1,22          |
|           | 28 L 075 | 2F          | 28          | 84,89         | 84,13        | 91              | 58            | 25,4 | 38 | 12             | 316           | 1,30          |
|           | 30 L 075 | 2F          | 30          | 90,96         | 90,20        | 97              | 70            | 25,4 | 38 | 12             | 318           | 1,47          |
|           | 32 L 075 | 2F          | 32          | 97,03         | 96,26        | 103             | 70            | 25,4 | 38 | 12             | 320           | 1,75          |
|           | 33 L 075 | 2F          | 33          | 100,05        | 99,29        | 106             | 70            | 25,4 | 38 | 12             | 321           | 1,85          |
|           | 34 L 075 | 2F          | 34          | 103,08        | 102,32       | 111             | 70            | 25,4 | 38 | 12             | 322           | 1,93          |
|           | 35 L 075 | 2F          | 35          | 106,12        | 105,35       | 111             | 70            | 25,4 | 38 | 12             | 322           | 2,03          |
| 36 L 075  | 2F       | 36          | 109,15      | 108,39        | 115          | 70              | 25,4          | 38   | 12 | 323            | 2,14          |               |
| 40 L 075  | 2F       | 40          | 121,29      | 120,51        | 127          | 70              | 25,4          | 38   | 12 | 327            | 2,56          |               |
| 42 L 075  | 2F       | 42          | 127,34      | 126,58        | 135          | 70              | 25,4          | 38   | 12 | 328            | 2,81          |               |
| 44 L 075  | 2F       | 44          | 133,40      | 132,64        | 140          | 70              | 25,4          | 38   | 12 | 330            | 3,02          |               |
| 45 L 075  | 2F       | 45          | 136,44      | 135,67        | 143          | 70              | 25,4          | 38   | 12 | 331            | 3,16          |               |
| 48 L 075  | 2F       | 48          | 145,53      | 144,77        | 152          | 70              | 25,4          | 38   | 12 | 334            | 3,57          |               |
| Ghisa     | 50 L 075 | 4           | 50          | 151,60        | 150,83       | -               | 70            | 25,4 | 38 | 14             | -             | 2,10          |
|           | 52 L 075 | 4           | 52          | 157,66        | 156,90       | -               | 70            | 25,4 | 38 | 14             | -             | 2,13          |
|           | 56 L 075 | 4           | 56          | 169,79        | 169,02       | -               | 70            | 25,4 | 38 | 14             | -             | 2,27          |
|           | 57 L 075 | 4           | 57          | 172,82        | 172,06       | -               | 70            | 25,4 | 38 | 14             | -             | 2,28          |
|           | 60 L 075 | 4           | 60          | 181,91        | 181,15       | -               | 75            | 25,4 | 45 | 14             | -             | 2,70          |
|           | 72 L 075 | 4           | 72          | 218,29        | 217,53       | -               | 75            | 25,4 | 45 | 14             | -             | 3,19          |
|           | 84 L 075 | 4           | 84          | 254,68        | 253,92       | -               | 75            | 25,4 | 45 | 14             | -             | 3,64          |
|           | 96 L 075 | 4           | 96          | 291,06        | 290,30       | -               | 75            | 25,4 | 45 | 14             | -             | 4,04          |

## L 100

## Passo 3/8" (9.525mm)

| Materiale | Cod. HFH | Esec.<br>N° | N°<br>Denti | Ø Prim.<br>Dp | Ø est.<br>De | Ø Flangia<br>Df | Ø Mozzo<br>Dm | F    | L    | Ø preforo<br>d | Flangia<br>N° | Massa<br>(kg) |      |
|-----------|----------|-------------|-------------|---------------|--------------|-----------------|---------------|------|------|----------------|---------------|---------------|------|
| Acciaio   | 10 L 100 | 2F          | 10          | 30,32         | 29,56        | 36              | 20            | 31,8 | 45   | 8              | 300           | 0,17          |      |
|           | 11 L 100 | 2F          | 11          | 33,35         | 32,59        | 38              | 24            | 31,8 | 45   | 8              | 301           | 0,22          |      |
|           | 12 L 100 | 2F          | 12          | 36,38         | 35,62        | 42              | 24            | 31,8 | 45   | 8              | 302           | 0,26          |      |
|           | 13 L 100 | 2F          | 13          | 39,41         | 38,65        | 44              | 28            | 31,8 | 45   | 8              | 303           | 0,32          |      |
|           | 14 L 100 | 2F          | 14          | 42,44         | 41,68        | 48              | 28            | 31,8 | 45   | 10             | 304           | 0,35          |      |
|           | 15 L 100 | 2F          | 15          | 45,44         | 44,72        | 51              | 34            | 31,8 | 45   | 10             | 305           | 0,43          |      |
|           | 16 L 100 | 2F          | 16          | 48,51         | 47,75        | 54              | 36            | 31,8 | 45   | 10             | 306           | 0,50          |      |
|           | 17 L 100 | 2F          | 17          | 51,54         | 50,78        | 57              | 36            | 31,8 | 45   | 10             | 307           | 0,56          |      |
|           | 18 L 100 | 2F          | 18          | 54,57         | 53,81        | 60              | 40            | 31,8 | 45   | 10             | 308           | 0,64          |      |
|           | 19 L 100 | 2F          | 19          | 57,61         | 56,84        | 63              | 40            | 31,8 | 45   | 10             | 309           | 0,70          |      |
|           | 20 L 100 | 2F          | 20          | 60,64         | 59,88        | 66              | 40            | 31,8 | 45   | 10             | 310           | 0,77          |      |
|           | 21 L 100 | 2F          | 21          | 63,67         | 62,91        | 71              | 45            | 31,8 | 45   | 10             | 311           | 0,88          |      |
|           | 22 L 100 | 2F          | 22          | 66,70         | 65,94        | 75              | 45            | 31,8 | 45   | 12             | 312           | 0,95          |      |
|           | 23 L 100 | 2F          | 23          | 69,73         | 68,97        | 79              | 55            | 31,8 | 45   | 12             | 313           | 1,11          |      |
|           | 24 L 100 | 2F          | 24          | 72,77         | 72,00        | 79              | 55            | 31,8 | 45   | 12             | 313           | 1,18          |      |
|           | 25 L 100 | 2F          | 25          | 75,80         | 75,04        | 83              | 58            | 31,8 | 45   | 12             | 314           | 1,30          |      |
|           | 26 L 100 | 2F          | 26          | 78,83         | 78,07        | 87              | 58            | 31,8 | 45   | 12             | 315           | 1,40          |      |
|           | 27 L 100 | 2F          | 27          | 81,86         | 81,10        | 87              | 58            | 31,8 | 45   | 12             | 315           | 1,47          |      |
|           | 28 L 100 | 2F          | 28          | 84,89         | 84,13        | 91              | 58            | 31,8 | 45   | 12             | 316           | 1,58          |      |
|           | 30 L 100 | 2F          | 30          | 90,96         | 90,20        | 97              | 70            | 31,8 | 45   | 12             | 318           | 1,78          |      |
|           | 32 L 100 | 2F          | 32          | 97,03         | 96,26        | 103             | 70            | 31,8 | 45   | 12             | 320           | 2,11          |      |
|           | 33 L 100 | 2F          | 33          | 100,05        | 99,29        | 106             | 70            | 31,8 | 45   | 12             | 321           | 2,23          |      |
|           | 34 L 100 | 2F          | 34          | 103,08        | 102,32       | 111             | 70            | 31,8 | 45   | 12             | 322           | 2,39          |      |
|           | 35 L 100 | 2F          | 35          | 106,12        | 105,35       | 111             | 70            | 31,8 | 45   | 12             | 322           | 2,45          |      |
|           | 36 L 100 | 2F          | 36          | 109,15        | 108,39       | 115             | 70            | 31,8 | 45   | 12             | 323           | 2,59          |      |
|           | 40 L 100 | 2F          | 40          | 121,29        | 120,51       | 127             | 70            | 31,8 | 45   | 12             | 327           | 3,13          |      |
|           | 42 L 100 | 2F          | 42          | 127,34        | 126,58       | 135             | 70            | 31,8 | 45   | 12             | 328           | 3,43          |      |
|           | 44 L 100 | 2F          | 44          | 133,40        | 132,64       | 140             | 70            | 31,8 | 45   | 12             | 330           | 3,72          |      |
|           | 45 L 100 | 2F          | 45          | 136,44        | 135,67       | 143             | 70            | 31,8 | 45   | 12             | 331           | 3,89          |      |
|           | 48 L 100 | 2F          | 48          | 145,53        | 144,77       | 152             | 70            | 31,8 | 45   | 12             | 334           | 4,38          |      |
|           | Ghisa    | 50 L 100    | 4           | 50            | 151,60       | 150,83          | -             | 70   | 31,8 | 45             | 14            | -             | 2,41 |
|           |          | 52 L 100    | 4           | 52            | 157,66       | 156,90          | -             | 70   | 31,8 | 45             | 14            | -             | 2,55 |
|           |          | 56 L 100    | 4           | 56            | 169,79       | 169,02          | -             | 70   | 31,8 | 45             | 14            | -             | 2,65 |
|           |          | 57 L 100    | 4           | 57            | 172,82       | 172,06          | -             | 70   | 31,8 | 45             | 14            | -             | 2,71 |
|           |          | 60 L 100    | 4           | 60            | 181,91       | 181,15          | -             | 75   | 31,8 | 45             | 14            | -             | 3,11 |
|           |          | 72 L 100    | 4           | 72            | 218,29       | 217,53          | -             | 75   | 31,8 | 45             | 14            | -             | 3,65 |
| 84 L 100  |          | 4           | 84          | 254,68        | 253,92       | -               | 75            | 31,8 | 45   | 14             | -             | 4,12          |      |
| 96 L 100  |          | 4           | 96          | 291,06        | 290,30       | -               | 75            | 31,8 | 45   | 14             | -             | 4,60          |      |

# PULEGGE DENTATE

## H 075-100-150-200-300



### H 075 Passo 1/2" (12.7mm)

| Materiale | Cod. HFH | Esec. N° | N° Denti | Ø Prim. Dp | Ø est. De | Ø Flangia Df | Ø Mozzo Dm | F    | L  | Ø preforo d | Flangia N° | Massa (kg) |
|-----------|----------|----------|----------|------------|-----------|--------------|------------|------|----|-------------|------------|------------|
| Acciaio   | 14 H 075 | 2F       | 14       | 56,59      | 55,22     | 63           | 40         | 26,4 | 40 | 10          | 309        | 0,58       |
|           | 15 H 075 | 2F       | 15       | 60,64      | 59,27     | 66           | 45         | 26,4 | 40 | 10          | 310        | 0,69       |
|           | 16 H 075 | 2F       | 16       | 64,68      | 63,31     | 71           | 45         | 26,4 | 40 | 10          | 311        | 0,77       |
|           | 17 H 075 | 2F       | 17       | 68,72      | 67,35     | 75           | 45         | 26,4 | 40 | 12          | 312        | 0,84       |
|           | 18 H 075 | 2F       | 18       | 72,77      | 71,39     | 79           | 55         | 26,4 | 40 | 12          | 313        | 1,01       |
|           | 19 H 075 | 2F       | 19       | 76,81      | 75,44     | 83           | 60         | 26,4 | 40 | 12          | 314        | 1,15       |
|           | 20 H 075 | 2F       | 20       | 80,85      | 79,48     | 87           | 62         | 26,4 | 40 | 12          | 315        | 1,27       |
|           | 21 H 075 | 2F       | 21       | 84,89      | 83,52     | 91           | 65         | 26,4 | 40 | 12          | 316        | 1,41       |
|           | 22 H 075 | 2F       | 22       | 88,89      | 87,56     | 93           | 68         | 26,4 | 40 | 12          | 317        | 1,55       |
|           | 23 H 075 | 2F       | 23       | 92,98      | 91,61     | 97           | 72         | 26,4 | 40 | 12          | 318        | 1,71       |
|           | 24 H 075 | 2F       | 24       | 97,03      | 95,65     | 103          | 72         | 26,4 | 40 | 12          | 320        | 1,83       |
|           | 25 H 075 | 2F       | 25       | 101,06     | 99,69     | 106          | 72         | 26,4 | 40 | 12          | 321        | 1,96       |
|           | 26 H 075 | 2F       | 26       | 105,11     | 103,73    | 111          | 80         | 26,4 | 40 | 12          | 322        | 2,19       |
|           | 27 H 075 | 2F       | 27       | 109,15     | 107,78    | 115          | 80         | 26,4 | 40 | 12          | 323        | 2,32       |
|           | 28 H 075 | 2F       | 28       | 113,19     | 111,82    | 119          | 80         | 26,4 | 40 | 12          | 325        | 2,47       |
|           | 30 H 075 | 2F       | 30       | 121,29     | 119,90    | 127          | 80         | 26,4 | 40 | 14          | 327        | 2,76       |
|           | 32 H 075 | 2F       | 32       | 129,36     | 127,99    | 135          | 80         | 26,4 | 40 | 14          | 328        | 3,08       |
|           | 33 H 075 | 2F       | 33       | 133,40     | 132,03    | 140          | 80         | 26,4 | 40 | 14          | 330        | 3,25       |
|           | 34 H 075 | 2F       | 34       | 137,45     | 136,07    | 143          | 80         | 26,4 | 40 | 14          | 331        | 3,42       |
|           | 35 H 075 | 2F       | 35       | 141,49     | 140,12    | 148          | 80         | 26,4 | 40 | 14          | 333        | 3,61       |
| 36 H 075  | 2F       | 36       | 145,53   | 144,16     | 152       | 80           | 26,4       | 40   | 14 | 334         | 3,79       |            |
| 38 H 075  | 2F       | 38       | 153,62   | 152,24     | 158       | 80           | 26,4       | 40   | 14 | 335         | 4,16       |            |
| 40 H 075  | 2F       | 40       | 161,70   | 160,33     | 168       | 80           | 26,4       | 40   | 14 | 338         | 4,58       |            |
| Ghisa     | 44 H 075 | 4F       | 44       | 177,87     | 176,50    | 184          | 80         | 26,4 | 40 | 18          | 339        | 2,57       |
|           | 48 H 075 | 4F       | 48       | 194,04     | 192,67    | 200          | 90         | 26,4 | 45 | 18          | 342        | 3,56       |
|           | 50 H 075 | 4        | 50       | 202,13     | 200,75    | -            | 90         | 26,4 | 45 | 18          | -          | 3,74       |



## H 100      Passo 1/2" (12.7mm)

| Materiale      | Cod.      | HFH | Esec.<br>N° | N°<br>Denti | Ø Prim.<br>Dp | Ø est.<br>De | Ø Flangia<br>Df | Ø Mozzo<br>Dm | F    | L  | Ø preforo<br>d | Flangia<br>N° | Massa<br>(kg) |
|----------------|-----------|-----|-------------|-------------|---------------|--------------|-----------------|---------------|------|----|----------------|---------------|---------------|
| <b>Acciaio</b> | 14 H 100  |     | 2F          | 14          | 56,59         | 55,22        | 63              | 40            | 31,8 | 45 | 12             | 309           | 0,65          |
|                | 15 H 100  |     | 2F          | 15          | 60,64         | 59,27        | 66              | 45            | 31,8 | 45 | 12             | 310           | 0,77          |
|                | 16 H 100  |     | 2F          | 16          | 64,68         | 63,31        | 71              | 45            | 31,8 | 45 | 12             | 311           | 0,87          |
|                | 17 H 100  |     | 2F          | 17          | 68,72         | 67,35        | 75              | 45            | 31,8 | 45 | 12             | 312           | 0,97          |
|                | 18 H 100  |     | 2F          | 18          | 72,77         | 71,39        | 79              | 55            | 31,8 | 45 | 12             | 313           | 1,16          |
|                | 19 H 100  |     | 2F          | 19          | 76,81         | 75,44        | 83              | 60            | 31,8 | 45 | 14             | 314           | 1,30          |
|                | 20 H 100  |     | 2F          | 20          | 80,85         | 79,48        | 87              | 62            | 31,8 | 45 | 14             | 315           | 1,44          |
|                | 21 H 100  |     | 2F          | 21          | 84,89         | 83,52        | 91              | 65            | 31,8 | 45 | 14             | 316           | 1,60          |
|                | 22 H 100  |     | 2F          | 22          | 88,89         | 87,56        | 93              | 68            | 31,8 | 45 | 14             | 317           | 1,76          |
|                | 23 H 100  |     | 2F          | 23          | 92,98         | 91,61        | 97              | 72            | 31,8 | 45 | 14             | 318           | 1,94          |
|                | 24 H 100  |     | 2F          | 24          | 97,03         | 95,65        | 103             | 72            | 31,8 | 45 | 14             | 320           | 2,09          |
|                | 25 H 100  |     | 2F          | 25          | 101,06        | 99,69        | 106             | 72            | 31,8 | 45 | 14             | 321           | 2,24          |
|                | 26 H 100  |     | 2F          | 26          | 105,11        | 103,73       | 111             | 80            | 31,8 | 45 | 14             | 322           | 2,49          |
|                | 27 H 100  |     | 2F          | 27          | 109,15        | 107,78       | 115             | 80            | 31,8 | 45 | 14             | 323           | 2,66          |
|                | 28 H 100  |     | 2F          | 28          | 113,19        | 111,82       | 119             | 80            | 31,8 | 45 | 14             | 325           | 2,83          |
|                | 29 H 100  |     | 2F          | 29          | 117,23        | 115,86       | 123             | 80            | 31,8 | 45 | 14             | 326           | 3,01          |
|                | 30 H 100  |     | 2F          | 30          | 121,29        | 119,90       | 127             | 80            | 31,8 | 45 | 14             | 327           | 3,19          |
|                | 32 H 100  |     | 2F          | 32          | 129,36        | 127,99       | 135             | 80            | 31,8 | 45 | 14             | 328           | 3,57          |
|                | 33 H 100  |     | 2F          | 33          | 133,40        | 132,03       | 140             | 80            | 31,8 | 45 | 14             | 330           | 3,79          |
|                | 34 H 100  |     | 2F          | 34          | 137,45        | 136,07       | 143             | 80            | 31,8 | 45 | 14             | 331           | 3,99          |
| 35 H 100       |           | 2F  | 35          | 141,49      | 140,12        | 148          | 80              | 31,8          | 45   | 14 | 333            | 4,20          |               |
| 36 H 100       |           | 2F  | 36          | 145,53      | 144,16        | 152          | 80              | 31,8          | 45   | 14 | 334            | 4,44          |               |
| 38 H 100       |           | 2F  | 38          | 153,62      | 152,24        | 158          | 80              | 31,8          | 45   | 14 | 335            | 4,90          |               |
| 40 H 100       |           | 2F  | 40          | 161,70      | 160,33        | 168          | 80              | 31,8          | 45   | 14 | 338            | 5,39          |               |
| <b>Ghisa</b>   | 44 H 100  |     | 4F          | 44          | 177,87        | 176,50       | 184             | 80            | 31,8 | 50 | 18             | 339           | 3,37          |
|                | 45 H 100  |     | 4F          | 45          | 181,91        | 180,54       | 192             | 80            | 31,8 | 50 | 18             | 340           | 3,57          |
|                | 48 H 100  |     | 4F          | 48          | 194,04        | 192,67       | 200             | 90            | 31,8 | 50 | 18             | 342           | 4,10          |
|                | 50 H 100  |     | 4           | 50          | 202,21        | 200,75       | -               | 90            | 31,8 | 50 | 18             | -             | 4,24          |
|                | 52 H 100  |     | 4           | 52          | 210,21        | 208,84       | -               | 90            | 31,8 | 50 | 18             | -             | 4,32          |
|                | 58 H 100  |     | 4           | 58          | 234,47        | 233,09       | -               | 90            | 31,8 | 50 | 18             | -             | 4,61          |
|                | 60 H 100  |     | 4           | 60          | 242,55        | 241,18       | -               | 100           | 31,8 | 50 | 18             | -             | 5,30          |
|                | 70 H 100  |     | 4           | 70          | 282,98        | 281,61       | -               | 100           | 31,8 | 55 | 18             | -             | 6,13          |
|                | 72 H 100  |     | 4           | 72          | 291,06        | 289,69       | -               | 120           | 31,8 | 55 | 18             | -             | 7,47          |
|                | 84 H 100  |     | 4           | 84          | 339,57        | 338,20       | -               | 120           | 31,8 | 55 | 18             | -             | 8,52          |
|                | 96 H 100  |     | 4           | 96          | 388,08        | 386,71       | -               | 120           | 31,8 | 60 | 18             | -             | 10,25         |
|                | 120 H 100 |     | 4           | 120         | 485,10        | 483,73       | -               | 120           | 31,8 | 60 | 18             | -             | 13,09         |

## H 150      Passo 1/2" (12.7mm)

| Materiale | Cod.      | HFH | Esec. | N°     | Ø Prim. | Ø est. | Ø Flangia | Ø Mozzo | F  | L  | Ø preforo | Flangia | Massa |
|-----------|-----------|-----|-------|--------|---------|--------|-----------|---------|----|----|-----------|---------|-------|
|           |           |     | N°    | Denti  | Dp      | De     | Df        | Dm      |    |    | d         | N°      | (kg)  |
| Acciaio   | 14 H 150  |     | 2F    | 14     | 56,59   | 55,22  | 63        | 40      | 46 | 58 | 18        | 309     | 0,81  |
|           | 15 H 150  |     | 2F    | 15     | 60,64   | 59,27  | 66        | 45      | 46 | 58 | 18        | 310     | 0,97  |
|           | 16 H 150  |     | 2F    | 16     | 64,68   | 63,31  | 71        | 45      | 46 | 58 | 18        | 311     | 1,11  |
|           | 17 H 150  |     | 2F    | 17     | 68,72   | 67,35  | 75        | 45      | 46 | 58 | 18        | 312     | 1,25  |
|           | 18 H 150  |     | 2F    | 18     | 72,77   | 71,39  | 79        | 55      | 46 | 58 | 18        | 313     | 1,48  |
|           | 19 H 150  |     | 2F    | 19     | 76,81   | 75,44  | 83        | 60      | 46 | 58 | 18        | 314     | 1,68  |
|           | 20 H 150  |     | 2F    | 20     | 80,85   | 79,48  | 87        | 62      | 46 | 58 | 18        | 315     | 1,88  |
|           | 21 H 150  |     | 2F    | 21     | 84,89   | 83,52  | 91        | 65      | 46 | 58 | 18        | 316     | 2,08  |
|           | 22 H 150  |     | 2F    | 22     | 88,89   | 87,56  | 93        | 68      | 46 | 58 | 18        | 317     | 2,30  |
|           | 23 H 150  |     | 2F    | 23     | 92,98   | 91,61  | 97        | 72      | 46 | 58 | 18        | 318     | 2,54  |
|           | 24 H 150  |     | 2F    | 24     | 97,03   | 95,65  | 103       | 72      | 46 | 58 | 18        | 320     | 2,75  |
|           | 25 H 150  |     | 2F    | 25     | 101,06  | 99,69  | 106       | 72      | 46 | 58 | 18        | 321     | 2,97  |
|           | 26 H 150  |     | 2F    | 26     | 105,11  | 103,73 | 111       | 80      | 46 | 58 | 18        | 322     | 3,29  |
|           | 27 H 150  |     | 2F    | 27     | 109,15  | 107,78 | 115       | 80      | 46 | 58 | 18        | 323     | 3,52  |
|           | 28 H 150  |     | 2F    | 28     | 113,19  | 111,82 | 119       | 80      | 46 | 58 | 18        | 325     | 3,78  |
|           | 29 H 150  |     | 2F    | 29     | 117,23  | 115,86 | 123       | 80      | 46 | 58 | 18        | 326     | 4,03  |
|           | 30 H 150  |     | 2F    | 30     | 121,29  | 119,90 | 127       | 80      | 46 | 58 | 18        | 327     | 4,29  |
|           | 32 H 150  |     | 2F    | 32     | 129,36  | 127,99 | 135       | 80      | 46 | 58 | 18        | 328     | 4,86  |
|           | 33 H 150  |     | 2F    | 33     | 133,40  | 132,03 | 140       | 80      | 46 | 58 | 18        | 330     | 5,15  |
|           | 34 H 150  |     | 2F    | 34     | 137,45  | 136,07 | 143       | 80      | 46 | 58 | 18        | 331     | 5,46  |
| 35 H 150  |           | 2F  | 35    | 141,49 | 140,12  | 148    | 80        | 46      | 58 | 18 | 333       | 5,78    |       |
| 36 H 150  |           | 2F  | 36    | 145,53 | 144,16  | 152    | 80        | 46      | 58 | 18 | 334       | 6,09    |       |
| 38 H 150  |           | 2F  | 38    | 153,62 | 152,24  | 158    | 80        | 46      | 58 | 18 | 335       | 6,74    |       |
| 40 H 150  |           | 2F  | 40    | 161,70 | 160,33  | 168    | 80        | 46      | 58 | 18 | 338       | 7,46    |       |
| Ghisa     | 44 H 150  |     | 4F    | 44     | 177,87  | 176,50 | 184       | 80      | 46 | 58 | 18        | 339     | 4,29  |
|           | 45 H 150  |     | 4F    | 45     | 181,91  | 180,54 | 192       | 80      | 46 | 58 | 18        | 340     | 4,44  |
|           | 48 H 150  |     | 4F    | 48     | 194,04  | 192,67 | 200       | 90      | 46 | 65 | 18        | 342     | 5,41  |
|           | 50 H 150  |     | 4     | 50     | 202,21  | 200,75 | -         | 90      | 46 | 65 | 18        | -       | 5,59  |
|           | 52 H 150  |     | 4     | 52     | 210,21  | 208,84 | -         | 90      | 46 | 65 | 18        | -       | 5,79  |
|           | 58 H 150  |     | 4     | 58     | 234,47  | 233,09 | -         | 90      | 46 | 65 | 18        | -       | 6,15  |
|           | 60 H 150  |     | 4     | 60     | 242,55  | 241,18 | -         | 100     | 46 | 65 | 18        | -       | 7,08  |
|           | 70 H 150  |     | 4     | 70     | 282,98  | 281,61 | -         | 100     | 46 | 65 | 24        | -       | 7,77  |
|           | 72 H 150  |     | 4     | 72     | 291,06  | 289,69 | -         | 120     | 46 | 65 | 24        | -       | 9,70  |
|           | 84 H 150  |     | 4     | 84     | 339,57  | 338,20 | -         | 120     | 46 | 65 | 24        | -       | 10,99 |
|           | 96 H 150  |     | 4     | 96     | 388,08  | 386,71 | -         | 120     | 46 | 65 | 24        | -       | 12,24 |
|           | 120 H 150 |     | 4     | 120    | 485,10  | 483,73 | -         | 120     | 46 | 65 | 24        | -       | 16,17 |

## H 200      Passo 1/2" (12.7mm)

| Material       | Cod. HFH  | Esec. N° | N° Denti | Ø Prim. Dp | Ø est. De | Ø Flangia Df | Ø Mozzo Dm | F  | L  | Ø preforo d | Flangia N° | Massa (kg) |
|----------------|-----------|----------|----------|------------|-----------|--------------|------------|----|----|-------------|------------|------------|
| <b>Acciaio</b> | 14 H 200  | 2F       | 14       | 56,59      | 55,22     | 63           | 40         | 59 | 70 | 18          | 309        | 1,10       |
|                | 15 H 200  | 2F       | 15       | 60,64      | 59,27     | 66           | 45         | 59 | 70 | 18          | 310        | 1,33       |
|                | 16 H 200  | 2F       | 16       | 64,68      | 63,31     | 71           | 45         | 59 | 70 | 18          | 311        | 1,54       |
|                | 17 H 200  | 2F       | 17       | 68,72      | 67,35     | 75           | 45         | 59 | 70 | 18          | 312        | 1,69       |
|                | 18 H 200  | 2F       | 18       | 72,77      | 71,39     | 79           | 55         | 59 | 70 | 18          | 313        | 1,95       |
|                | 19 H 200  | 2F       | 19       | 76,81      | 75,44     | 83           | 60         | 59 | 70 | 18          | 314        | 2,20       |
|                | 20 H 200  | 2F       | 20       | 80,85      | 79,48     | 87           | 62         | 59 | 70 | 18          | 315        | 2,44       |
|                | 21 H 200  | 2F       | 21       | 84,89      | 83,52     | 91           | 65         | 59 | 70 | 18          | 316        | 2,70       |
|                | 22 H 200  | 2F       | 22       | 88,89      | 87,56     | 93           | 68         | 59 | 70 | 18          | 317        | 2,97       |
|                | 23 H 200  | 2F       | 23       | 92,98      | 91,61     | 97           | 72         | 59 | 70 | 18          | 318        | 3,25       |
|                | 24 H 200  | 2F       | 24       | 97,03      | 95,65     | 103          | 72         | 59 | 70 | 18          | 320        | 3,56       |
|                | 25 H 200  | 2F       | 25       | 101,06     | 99,69     | 106          | 72         | 59 | 70 | 18          | 321        | 3,81       |
|                | 26 H 200  | 2F       | 26       | 105,11     | 103,73    | 111          | 80         | 59 | 70 | 18          | 322        | 4,18       |
|                | 27 H 200  | 2F       | 27       | 109,15     | 107,78    | 115          | 80         | 59 | 70 | 18          | 323        | 4,49       |
|                | 28 H 200  | 2F       | 28       | 113,19     | 111,82    | 119          | 80         | 59 | 70 | 18          | 325        | 4,81       |
|                | 29 H 200  | 2F       | 29       | 117,23     | 115,86    | 123          | 80         | 59 | 70 | 18          | 326        | 5,14       |
|                | 30 H 200  | 2F       | 30       | 121,29     | 119,90    | 127          | 80         | 59 | 70 | 18          | 327        | 5,47       |
|                | 32 H 200  | 2F       | 32       | 129,36     | 127,99    | 135          | 80         | 59 | 70 | 18          | 328        | 6,17       |
|                | 33 H 200  | 2F       | 33       | 133,40     | 132,03    | 140          | 80         | 59 | 70 | 18          | 330        | 6,56       |
|                | 34 H 200  | 2F       | 34       | 137,45     | 136,07    | 143          | 80         | 59 | 70 | 18          | 331        | 6,94       |
| 35 H 200       | 2F        | 35       | 141,49   | 140,12     | 148       | 80           | 59         | 70 | 18 | 333         | 7,34       |            |
| 36 H 200       | 2F        | 36       | 145,53   | 144,16     | 152       | 80           | 59         | 70 | 18 | 334         | 7,75       |            |
| 38 H 200       | 2F        | 38       | 153,62   | 152,24     | 158       | 80           | 59         | 70 | 18 | 335         | 8,62       |            |
| 40 H 200       | 2F        | 40       | 161,70   | 160,33     | 168       | 80           | 59         | 70 | 18 | 338         | 9,50       |            |
| <b>Ghisa</b>   | 44 H 200  | 4F       | 44       | 177,87     | 176,50    | 184          | 80         | 59 | 70 | 18          | 339        | 5,14       |
|                | 45 H 200  | 4F       | 45       | 181,91     | 180,54    | 192          | 80         | 59 | 70 | 18          | 340        | 5,38       |
|                | 48 H 200  | 4F       | 48       | 194,04     | 192,67    | 200          | 90         | 59 | 75 | 24          | 342        | 6,29       |
|                | 50 H 200  | 4        | 50       | 202,21     | 200,75    | -            | 90         | 59 | 75 | 24          | -          | 6,68       |
|                | 52 H 200  | 4        | 52       | 210,21     | 208,84    | -            | 90         | 59 | 75 | 24          | -          | 6,81       |
|                | 58 H 200  | 4        | 58       | 234,47     | 233,09    | -            | 90         | 59 | 75 | 24          | -          | 7,26       |
|                | 60 H 200  | 4        | 60       | 242,55     | 241,18    | -            | 100        | 59 | 75 | 24          | -          | 8,25       |
|                | 70 H 200  | 4        | 70       | 282,98     | 281,61    | -            | 100        | 59 | 75 | 28          | -          | 9,20       |
|                | 72 H 200  | 4        | 72       | 291,06     | 289,69    | -            | 120        | 59 | 75 | 28          | -          | 11,09      |
|                | 84 H 200  | 4        | 84       | 339,57     | 338,20    | -            | 120        | 59 | 75 | 28          | -          | 12,63      |
|                | 96 H 200  | 4        | 96       | 388,08     | 386,71    | -            | 120        | 59 | 75 | 28          | -          | 14,51      |
|                | 120 H 200 | 4        | 120      | 485,10     | 483,73    | -            | 120        | 59 | 75 | 28          | -          | 19,15      |

## H 300      Passo 1/2" (12.7mm)

| Material       | Cod. HFH  | Esec. N° | N° Denti | Ø Prim. Dp | Ø est. De | Ø Flangia Df | Ø Mozzo Dm | F   | L   | Ø preforo d | Flangia N° | Massa (kg) |
|----------------|-----------|----------|----------|------------|-----------|--------------|------------|-----|-----|-------------|------------|------------|
| <b>Acciaio</b> | 14 H 300  | 2F       | 14       | 56,59      | 55,22     | 63           | 40         | 86  | 100 | 18          | 309        | 1,64       |
|                | 15 H 300  | 2F       | 15       | 60,64      | 59,27     | 66           | 45         | 86  | 100 | 18          | 310        | 1,91       |
|                | 16 H 300  | 2F       | 16       | 64,68      | 63,31     | 71           | 45         | 86  | 100 | 18          | 311        | 2,16       |
|                | 17 H 300  | 2F       | 17       | 68,72      | 67,35     | 75           | 45         | 86  | 100 | 18          | 312        | 2,43       |
|                | 18 H 300  | 2F       | 18       | 72,77      | 71,39     | 79           | 55         | 86  | 100 | 18          | 313        | 2,80       |
|                | 19 H 300  | 2F       | 19       | 76,81      | 75,44     | 83           | 60         | 86  | 100 | 18          | 314        | 3,16       |
|                | 20 H 300  | 2F       | 20       | 80,85      | 79,48     | 87           | 62         | 86  | 100 | 18          | 315        | 3,50       |
|                | 21 H 300  | 2F       | 21       | 84,89      | 83,52     | 91           | 65         | 86  | 100 | 18          | 316        | 3,87       |
|                | 22 H 300  | 2F       | 22       | 88,89      | 87,56     | 93           | 68         | 86  | 100 | 18          | 317        | 4,26       |
|                | 23 H 300  | 2F       | 23       | 92,98      | 91,61     | 97           | 72         | 86  | 100 | 18          | 318        | 4,68       |
|                | 24 H 300  | 2F       | 24       | 97,03      | 95,65     | 103          | 72         | 86  | 100 | 18          | 320        | 5,08       |
|                | 25 H 300  | 2F       | 25       | 101,06     | 99,69     | 106          | 72         | 86  | 100 | 18          | 321        | 5,45       |
|                | 26 H 300  | 2F       | 26       | 105,11     | 103,73    | 111          | 80         | 86  | 100 | 18          | 322        | 6,01       |
|                | 27 H 300  | 2F       | 27       | 109,15     | 107,78    | 115          | 80         | 86  | 100 | 18          | 323        | 6,45       |
|                | 28 H 300  | 2F       | 28       | 113,19     | 111,82    | 119          | 80         | 86  | 100 | 18          | 325        | 6,91       |
|                | 30 H 300  | 2F       | 30       | 121,29     | 119,90    | 127          | 80         | 86  | 100 | 18          | 327        | 7,90       |
|                | 32 H 300  | 2F       | 32       | 129,36     | 127,99    | 135          | 80         | 86  | 100 | 18          | 328        | 8,92       |
|                | 33 H 300  | 2F       | 33       | 133,40     | 132,03    | 140          | 80         | 86  | 100 | 18          | 330        | 9,46       |
|                | 34 H 300  | 2F       | 34       | 137,45     | 136,07    | 143          | 80         | 86  | 100 | 18          | 331        | 10,04      |
|                | 35 H 300  | 2F       | 35       | 141,49     | 140,12    | 148          | 80         | 86  | 100 | 18          | 333        | 10,62      |
| 36 H 300       | 2F        | 36       | 145,53   | 144,16     | 152       | 80           | 86         | 100 | 18  | 334         | 11,24      |            |
| 38 H 300       | 2F        | 38       | 153,62   | 152,24     | 158       | 80           | 86         | 100 | 18  | 335         | 12,44      |            |
| 40 H 300       | 2F        | 40       | 161,70   | 160,33     | 168       | 80           | 86         | 100 | 18  | 338         | 13,80      |            |
| <b>Ghisa</b>   | 44 H 300  | 4F       | 44       | 177,87     | 176,50    | 184          | 80         | 86  | 100 | 24          | 339        | 7,22       |
|                | 48 H 300  | 4F       | 48       | 194,04     | 192,67    | 200          | 90         | 86  | 100 | 24          | 342        | 8,60       |
|                | 50 H 300  | 4        | 50       | 202,21     | 200,75    | -            | 90         | 86  | 100 | 24          | -          | 8,99       |
|                | 58 H 300  | 4        | 58       | 234,47     | 233,09    | -            | 90         | 86  | 100 | 24          | -          | 10,04      |
|                | 60 H 300  | 4        | 60       | 242,55     | 241,18    | -            | 100        | 86  | 100 | 24          | -          | 11,18      |
|                | 72 H 300  | 4        | 72       | 291,06     | 289,69    | -            | 120        | 86  | 100 | 28          | -          | 15,07      |
|                | 84 H 300  | 4        | 84       | 339,57     | 338,20    | -            | 120        | 86  | 100 | 28          | -          | 16,97      |
|                | 96 H 300  | 4        | 96       | 388,08     | 386,71    | -            | 120        | 86  | 100 | 28          | -          | 19,86      |
|                | 120 H 300 | 4        | 120      | 485,10     | 483,73    | -            | 120        | 86  | 100 | 28          | -          | 25,91      |

# PULEGGE DENTATE XH 200 - 300 - 400



## XH 200 Passo 7/8" (22.22mm)

| Materiale | Cod. HFH  | Esec. N° | N° Denti | Ø Prim. Dp | Ø est. De | Ø Flangia Df | Ø Mozzo Dm | F  | L  | Ø preforo d | Flangia N° | Massa (kg) |
|-----------|-----------|----------|----------|------------|-----------|--------------|------------|----|----|-------------|------------|------------|
| Acciaio   | 18 XH 200 | 2F       | 18       | 127,34     | 124,55    | 138          | 100        | 65 | 80 | 24          | 401        | 6,00       |
|           | 19 XH 200 | 2F       | 19       | 134,41     | 131,62    | 146          | 100        | 65 | 80 | 24          | 402        | 6,60       |
|           | 20 XH 200 | 2F       | 20       | 141,49     | 138,69    | 154          | 100        | 65 | 80 | 24          | 403        | 7,30       |
|           | 21 XH 200 | 2F       | 21       | 148,56     | 145,77    | 160          | 110        | 65 | 80 | 24          | 404        | 8,73       |
|           | 22 XH 200 | 2F       | 22       | 155,64     | 152,84    | 168          | 110        | 65 | 80 | 24          | 405        | 9,55       |
|           | 24 XH 200 | 2F       | 24       | 169,79     | 166,99    | 183          | 120        | 65 | 80 | 24          | 406        | 11,47      |
|           | 25 XH 200 | 2F       | 25       | 176,86     | 174,07    | 188          | 120        | 65 | 80 | 24          | 407        | 12,46      |
|           | 26 XH 200 | 2F       | 26       | 183,93     | 181,14    | 198          | 120        | 65 | 80 | 24          | 409        | 13,47      |
|           | 27 XH 200 | 2F       | 27       | 191,01     | 188,22    | 200          | 120        | 65 | 80 | 24          | 410        | 14,42      |
|           | 28 XH 200 | 2F       | 28       | 198,09     | 195,29    | 211          | 120        | 65 | 80 | 24          | 411        | 15,44      |
|           | 30 XH 200 | 2F       | 30       | 212,23     | 209,44    | 226          | 120        | 65 | 80 | 24          | 412        | 17,69      |
|           | 32 XH 200 | 2F       | 32       | 226,38     | 223,59    | 240          | 120        | 65 | 80 | 24          | 414        | 19,95      |
|           | 34 XH 200 | 2F       | 34       | 240,53     | 237,74    | 256          | 120        | 65 | 80 | 24          | 415        | 22,75      |

## XH 300 Passo 7/8" (22.22mm)

| Materiale | Cod. HFH  | Esec. N° | N° Denti | Ø Prim. Dp | Ø est. De | Ø Flangia Df | Ø Mozzo Dm | F  | L   | Ø preforo d | Flangia N° | Massa (kg) |
|-----------|-----------|----------|----------|------------|-----------|--------------|------------|----|-----|-------------|------------|------------|
| Acciaio   | 18 XH 300 | 2F       | 18       | 127,34     | 124,55    | 138          | 100        | 92 | 110 | 28          | 401        | 8,90       |
|           | 19 XH 300 | 2F       | 19       | 134,41     | 131,62    | 146          | 100        | 92 | 110 | 28          | 402        | 9,20       |
|           | 20 XH 300 | 2F       | 20       | 141,49     | 138,69    | 154          | 100        | 92 | 110 | 28          | 403        | 10,61      |
|           | 21 XH 300 | 2F       | 21       | 148,56     | 145,77    | 160          | 110        | 92 | 110 | 28          | 404        | 11,87      |
|           | 22 XH 300 | 2F       | 22       | 155,64     | 152,84    | 168          | 110        | 92 | 110 | 28          | 405        | 13,08      |
|           | 24 XH 300 | 2F       | 24       | 169,79     | 166,99    | 183          | 120        | 92 | 110 | 28          | 406        | 15,77      |
|           | 25 XH 300 | 2F       | 25       | 176,86     | 174,07    | 188          | 120        | 92 | 110 | 28          | 407        | 17,13      |
|           | 26 XH 300 | 2F       | 26       | 183,93     | 181,14    | 198          | 120        | 92 | 110 | 28          | 409        | 18,55      |
|           | 27 XH 300 | 2F       | 27       | 191,01     | 188,22    | 200          | 120        | 92 | 110 | 28          | 410        | 19,90      |
|           | 28 XH 300 | 2F       | 28       | 198,09     | 195,29    | 211          | 150        | 92 | 110 | 28          | 411        | 22,27      |
|           | 30 XH 300 | 2F       | 30       | 212,23     | 209,44    | 226          | 150        | 92 | 110 | 28          | 412        | 25,39      |
|           | 32 XH 300 | 2F       | 32       | 226,38     | 223,59    | 240          | 150        | 92 | 110 | 28          | 414        | 28,73      |
|           | 34 XH 300 | 2F       | 34       | 240,53     | 237,74    | 256          | 150        | 92 | 110 | 28          | 415        | 34,20      |

## XH 400      Passo 7/8" (22.22mm)

| Materiale      | Cod. HFH  | Esec.<br>N° | N°<br>Denti | Ø Prim.<br>Dp | Ø est.<br>De | Ø Flangia<br>Df | Ø Mozzo<br>Dm | F   | L   | Ø preforo<br>d | Flangia<br>N° | Massa<br>(kg) |
|----------------|-----------|-------------|-------------|---------------|--------------|-----------------|---------------|-----|-----|----------------|---------------|---------------|
| <b>Acciaio</b> | 18 XH 400 | 2F          | 18          | 127,34        | 124,55       | 138             | 100           | 119 | 132 | 32             | 401           | 9,60          |
|                | 19 XH 400 | 2F          | 19          | 134,41        | 131,62       | 146             | 100           | 119 | 132 | 32             | 402           | 10,80         |
|                | 20 XH 400 | 2F          | 20          | 141,49        | 138,69       | 154             | 100           | 119 | 132 | 32             | 403           | 12,87         |
|                | 21 XH 400 | 2F          | 21          | 148,56        | 145,77       | 160             | 110           | 119 | 132 | 32             | 404           | 14,42         |
|                | 22 XH 400 | 2F          | 22          | 155,64        | 152,84       | 168             | 110           | 119 | 132 | 32             | 405           | 15,44         |
|                | 24 XH 400 | 2F          | 24          | 169,79        | 166,99       | 183             | 120           | 119 | 132 | 32             | 406           | 19,22         |
|                | 25 XH 400 | 2F          | 25          | 176,86        | 174,07       | 188             | 120           | 119 | 132 | 32             | 407           | 21,05         |
|                | 26 XH 400 | 2F          | 26          | 183,93        | 181,14       | 198             | 120           | 119 | 132 | 32             | 409           | 22,80         |
|                | 27 XH 400 | 2F          | 27          | 191,01        | 188,22       | 200             | 120           | 119 | 132 | 32             | 410           | 24,66         |
|                | 28 XH 400 | 2F          | 28          | 198,09        | 195,29       | 211             | 150           | 119 | 132 | 32             | 411           | 27,23         |
|                | 30 XH 400 | 2F          | 30          | 212,23        | 209,44       | 226             | 150           | 119 | 132 | 32             | 412           | 31,30         |
|                | 32 XH 400 | 2F          | 32          | 226,38        | 223,59       | 240             | 150           | 119 | 132 | 32             | 414           | 35,20         |
|                | 34 XH 400 | 2F          | 34          | 240,53        | 237,74       | 256             | 150           | 119 | 132 | 32             | 415           | 40,00         |

# PULEGGE DENTATE HTD 3M 09-15



## Passo 3M-09

| Materiale | Cod HFH  | Esec.<br>N° | N°<br>Denti | Ø Prim.<br>Dp | Ø est.<br>De | Ø Flangia<br>Df | Ø Mozzo<br>Dm | Ø int.<br>Di | F    | L    | Ø preforo<br>d | Flangia<br>N° | Massa<br>(kg) |
|-----------|----------|-------------|-------------|---------------|--------------|-----------------|---------------|--------------|------|------|----------------|---------------|---------------|
| Acciaio   | 10 3M-09 | 1F          | 10          | 9,55          | 8,79         | 12,0            | 12,0          | -            | 10,2 | 17,5 | -              | 100           | 0,004         |
|           | 12 3M-09 | 1F          | 12          | 11,46         | 10,40        | 15,0            | 15,0          | -            | 10,2 | 17,5 | -              | 101           | 0,006         |
|           | 14 3M-09 | 1F          | 14          | 13,37         | 12,61        | 16,0            | 16,0          | -            | 10,2 | 17,5 | -              | 102           | 0,007         |
|           | 15 3M-09 | 1F          | 15          | 14,32         | 13,56        | 17,5            | 17,0          | -            | 10,2 | 17,5 | -              | 104           | 0,008         |
|           | 16 3M-09 | 2F          | 16          | 15,28         | 14,52        | 10,0            | 10,0          | -            | 12,8 | 20,6 | 4              | 104           | 0,007         |
|           | 18 3M-09 | 2F          | 18          | 17,19         | 19,50        | 11,0            | 11,0          | -            | 12,8 | 20,6 | 6              | 105           | 0,008         |
|           | 20 3M-09 | 2F          | 20          | 19,10         | 23,00        | 13,0            | 13,0          | -            | 12,8 | 20,6 | 6              | 107           | 0,010         |
|           | 21 3M-09 | 2F          | 21          | 20,05         | 25,00        | 14,0            | 14,0          | -            | 12,8 | 20,6 | 6              | 108           | 0,013         |
|           | 22 3M-09 | 2F          | 22          | 21,01         | 25,00        | 14,0            | 14,0          | -            | 12,8 | 20,6 | 6              | 108           | 0,014         |
|           | 24 3M-09 | 2F          | 24          | 22,16         | 25,00        | 14,0            | 14,0          | -            | 12,8 | 20,6 | 6              | 108           | 0,016         |
|           | 26 3M-09 | 2F          | 26          | 24,04         | 28,00        | 16,0            | 16,0          | -            | 12,8 | 20,6 | 6              | 109           | 0,018         |
|           | 28 3M-09 | 2F          | 28          | 25,65         | 32,00        | 18,0            | 18,0          | -            | 12,8 | 20,6 | 6              | 110           | 0,024         |
|           | 30 3M-09 | 2F          | 30          | 27,89         | 32,00        | 20,0            | 20,0          | -            | 12,8 | 20,6 | 6              | 110           | 0,028         |
|           | 32 3M-09 | 2F          | 32          | 29,80         | 36,00        | 22,0            | 22,0          | -            | 12,8 | 20,6 | 6              | 111           | 0,032         |
|           | 36 3M-09 | 2F          | 36          | 33,62         | 38,00        | 26,0            | 26,0          | -            | 13,4 | 22,2 | 6              | 112           | 0,045         |
|           | 40 3M-09 | 2F          | 40          | 37,44         | 42,00        | 28,0            | 28,0          | -            | 13,4 | 22,2 | 6              | 113           | 0,055         |
|           | 44 3M-09 | 2F          | 44          | 41,26         | 48,00        | 33,0            | 33,0          | -            | 13,4 | 22,2 | 6              | 114           | 0,074         |
|           | 48 3M-09 | 2           | 48          | 45,08         | -            | 33,0            | 33,0          | -            | 13,4 | 22,2 | 8              | -             | 0,106         |
|           | 60 3M-09 | 2           | 60          | 56,54         | -            | 33,0            | 33,0          | -            | 13,4 | 22,2 | 8              | -             | 0,106         |
|           | 72 3M-09 | 2           | 72          | 68,00         | -            | 33,0            | 33,0          | -            | 13,4 | 22,2 | 8              | -             | 0,145         |

## Passo 3M-15

| Materiale | Cod HFH  | Esec.<br>N° | N°<br>Denti | Ø Prim.<br>Dp | Ø est.<br>De | Ø Flangia<br>Df | Ø Mozzo<br>Dm | Ø int.<br>Di | F    | L    | Ø preforo<br>d | Flangia<br>N° | Massa<br>(kg) |
|-----------|----------|-------------|-------------|---------------|--------------|-----------------|---------------|--------------|------|------|----------------|---------------|---------------|
| Acciaio   | 10 3M-15 | 1F          | 10          | 9,55          | 8,79         | 12,0            | 12,0          | -            | 17,0 | 26,0 | -              | 100           | 0,006         |
|           | 12 3M-15 | 1F          | 12          | 11,46         | 10,40        | 15,0            | 15,0          | -            | 17,0 | 26,0 | -              | 101           | 0,008         |
|           | 14 3M-15 | 1F          | 14          | 13,37         | 12,61        | 16,0            | 16,0          | -            | 17,0 | 26,0 | -              | 102           | 0,010         |
|           | 15 3M-15 | 1F          | 15          | 14,32         | 13,56        | 17,5            | 17,0          | -            | 17,0 | 26,0 | -              | 104           | 0,012         |
|           | 16 3M-15 | 2F          | 16          | 15,28         | 14,52        | 10,0            | 10,0          | -            | 19,5 | 26,0 | 4              | 104           | 0,010         |
|           | 18 3M-15 | 2F          | 18          | 17,19         | 19,50        | 11,0            | 11,0          | -            | 19,5 | 26,0 | 6              | 105           | 0,012         |
|           | 20 3M-15 | 2F          | 20          | 19,10         | 23,00        | 13,0            | 13,0          | -            | 19,5 | 26,0 | 6              | 107           | 0,014         |
|           | 21 3M-15 | 2F          | 21          | 20,05         | 25,00        | 14,0            | 14,0          | -            | 19,5 | 26,0 | 6              | 108           | 0,016         |
|           | 22 3M-15 | 2F          | 22          | 21,01         | 25,00        | 14,0            | 14,0          | -            | 19,5 | 26,0 | 6              | 108           | 0,018         |
|           | 24 3M-15 | 2F          | 24          | 22,16         | 25,00        | 14,0            | 14,0          | -            | 19,5 | 26,0 | 6              | 108           | 0,020         |
|           | 26 3M-15 | 2F          | 26          | 24,04         | 28,00        | 16,0            | 16,0          | -            | 19,5 | 26,0 | 6              | 109           | 0,027         |
|           | 28 3M-15 | 2F          | 28          | 25,65         | 32,00        | 18,0            | 18,0          | -            | 19,5 | 26,0 | 6              | 110           | 0,031         |
|           | 30 3M-15 | 2F          | 30          | 27,89         | 32,00        | 20,0            | 20,0          | -            | 19,5 | 26,0 | 6              | 110           | 0,035         |
|           | 32 3M-15 | 2F          | 32          | 29,80         | 36,00        | 22,0            | 22,0          | -            | 19,5 | 26,0 | 6              | 111           | 0,042         |
|           | 36 3M-15 | 2F          | 36          | 33,62         | 38,00        | 26,0            | 26,0          | -            | 20,0 | 30,0 | 6              | 112           | 0,060         |
|           | 40 3M-15 | 2F          | 40          | 37,44         | 42,00        | 28,0            | 28,0          | -            | 20,0 | 30,0 | 6              | 113           | 0,072         |
|           | 44 3M-15 | 2F          | 44          | 41,26         | 48,00        | 33,0            | 33,0          | -            | 20,0 | 30,0 | 6              | 114           | 0,095         |
|           | 48 3M-15 | 2           | 48          | 45,08         | -            | 33,0            | 33,0          | -            | 20,0 | 30,0 | 8              | -             | 0,103         |
|           | 60 3M-15 | 2           | 60          | 56,54         | -            | 33,0            | 33,0          | -            | 20,0 | 30,0 | 8              | -             | 0,150         |
|           | 72 3M-15 | 2           | 72          | 68,00         | -            | 33,0            | 33,0          | -            | 20,0 | 30,0 | 8              | -             | 0,212         |

# PULEGGE DENTATE HTD 5M 09-15-25



## Passo 5M-09

| Materiale | Cod. HFH | Esec. N° | N° Denti | Ø Prim. Dp | Ø est. De | Ø Flangia Df | Ø Mozzo Dm | Ø int. Di | F    | L    | Ø preforo d | Flangia N° | Massa (kg) |
|-----------|----------|----------|----------|------------|-----------|--------------|------------|-----------|------|------|-------------|------------|------------|
| Acciaio   | 12 5M-09 | 2F       | 12       | 19,10      | 17,96     | 23           | 12,5       | -         | 14,5 | 20,0 | 6           | 202        | 0,03       |
|           | 14 5M-09 | 2F       | 14       | 22,28      | 21,14     | 25           | 13,5       | -         | 14,5 | 20,0 | 6           | 203        | 0,04       |
|           | 15 5M-09 | 2F       | 15       | 23,87      | 22,73     | 28           | 15,5       | -         | 14,5 | 20,0 | 6           | 204        | 0,05       |
|           | 16 5M-09 | 2F       | 16       | 25,46      | 24,32     | 28           | 16,5       | -         | 14,5 | 20,0 | 6           | 204        | 0,06       |
|           | 18 5M-09 | 2F       | 18       | 28,65      | 27,51     | 32           | 20,0       | -         | 14,5 | 20,0 | 6           | 205        | 0,07       |
|           | 20 5M-09 | 2F       | 20       | 31,83      | 30,69     | 36           | 23,0       | -         | 14,5 | 22,5 | 6           | 206        | 0,10       |
|           | 21 5M-09 | 2F       | 21       | 33,42      | 32,28     | 38           | 24,0       | -         | 14,5 | 22,5 | 6           | 207        | 12,00      |
|           | 22 5M-09 | 2F       | 22       | 35,01      | 33,87     | 38           | 25,5       | -         | 14,5 | 22,5 | 6           | 204        | 0,13       |
|           | 24 5M-09 | 2F       | 24       | 38,20      | 37,06     | 42           | 27,0       | -         | 14,5 | 22,5 | 6           | 208        | 0,15       |
|           | 26 5M-09 | 2F       | 26       | 41,38      | 40,24     | 44           | 30,0       | -         | 14,5 | 22,5 | 6           | 209        | 0,18       |
|           | 28 5M-09 | 2F       | 28       | 44,56      | 43,42     | 48           | 30,5       | -         | 14,5 | 22,5 | 6           | 210        | 0,21       |
|           | 30 5M-09 | 2F       | 30       | 47,75      | 46,60     | 51           | 35,0       | -         | 14,5 | 22,5 | 6           | 211        | 0,25       |
|           | 32 5M-09 | 2F       | 32       | 50,93      | 49,79     | 54           | 38,0       | -         | 14,5 | 22,5 | 8           | 212        | 0,28       |
|           | 36 5M-09 | 2F       | 36       | 57,30      | 56,16     | 60           | 38,0       | -         | 14,5 | 22,5 | 8           | 214        | 0,33       |
|           | 40 5M-09 | 2F       | 40       | 63,66      | 62,52     | 71           | 38,0       | -         | 14,5 | 22,5 | 8           | 217        | 0,42       |
|           | Ghisa    | 44 5M-09 | 2        | 44         | 70,03     | 68,89        | -          | 38,0      | -    | 14,5 | 25,5        | 8          | -          |
| 48 5M-09  |          | 2        | 48       | 76,39      | 75,25     | -            | 45,0       | -         | 14,5 | 25,5 | 8           | -          | 0,18       |
| 60 5M-09  |          | 2        | 60       | 95,49      | 94,35     | -            | 45,0       | -         | 14,5 | 25,5 | 8           | -          | 0,23       |
| 72 5M-09  |          | 2        | 72       | 114,59     | 113,45    | -            | 45,0       | -         | 14,5 | 25,5 | 8           | -          | 0,42       |

## Passo 5M-15

| Materiale | Cod. HFH | Esec. N° | N° Denti | Ø Prim. Dp | Ø est. De | Ø Flangia Df | Ø Mozzo Dm | Ø int. Di | F    | L    | Ø preforo d | Flangia N° | Massa (kg) |
|-----------|----------|----------|----------|------------|-----------|--------------|------------|-----------|------|------|-------------|------------|------------|
| Acciaio   | 12 5M-15 | 2F       | 12       | 19,10      | 17,96     | 23           | 13,0       | -         | 20,5 | 26   | 6           | 202        | 0,03       |
|           | 14 5M-15 | 2F       | 14       | 22,28      | 21,14     | 25           | 14,0       | -         | 20,5 | 26   | 6           | 203        | 0,04       |
|           | 15 5M-15 | 2F       | 15       | 23,87      | 22,73     | 28           | 16,0       | -         | 20,5 | 26   | 6           | 204        | 0,05       |
|           | 16 5M-15 | 2F       | 16       | 25,46      | 24,32     | 28           | 16,5       | -         | 20,5 | 26   | 6           | 204        | 0,06       |
|           | 18 5M-15 | 2F       | 18       | 28,65      | 27,51     | 32           | 20,0       | -         | 20,5 | 26   | 6           | 205        | 0,09       |
|           | 20 5M-15 | 2F       | 20       | 31,83      | 30,69     | 36           | 23,0       | -         | 20,5 | 26   | 6           | 206        | 0,12       |
|           | 21 5M-15 | 2F       | 21       | 33,42      | 32,28     | 38           | 24,0       | -         | 20,5 | 26   | 6           | 207        | 0,14       |
|           | 22 5M-15 | 2F       | 22       | 35,01      | 33,87     | 38           | 25,5       | -         | 20,5 | 26   | 6           | 204        | 0,15       |
|           | 24 5M-15 | 2F       | 24       | 38,20      | 37,06     | 42           | 27,0       | -         | 20,5 | 28   | 6           | 208        | 0,19       |
|           | 26 5M-15 | 2F       | 26       | 41,38      | 40,24     | 44           | 30,0       | -         | 20,5 | 28   | 6           | 209        | 0,23       |
|           | 28 5M-15 | 2F       | 28       | 44,56      | 43,42     | 48           | 30,5       | -         | 20,5 | 28   | 6           | 210        | 0,26       |
|           | 30 5M-15 | 2F       | 30       | 47,75      | 46,60     | 51           | 35,0       | -         | 20,5 | 28   | 6           | 211        | 0,32       |
|           | 32 5M-15 | 2F       | 32       | 50,93      | 49,79     | 54           | 38,0       | -         | 20,5 | 28   | 8           | 212        | 0,35       |
|           | 36 5M-15 | 2F       | 36       | 57,30      | 56,16     | 60           | 38,0       | -         | 20,5 | 28   | 8           | 214        | 0,43       |
|           | 40 5M-15 | 2F       | 40       | 63,66      | 62,52     | 71           | 38,0       | -         | 20,5 | 28   | 8           | 217        | 0,52       |
|           | Ghisa    | 44 5M-15 | 2        | 44         | 70,03     | 68,89        | -          | 38,0      | -    | 20,5 | 30          | 8          | -          |
| 48 5M-15  |          | 2        | 48       | 76,39      | 75,25     | -            | 38,0       | -         | 20,5 | 30   | 8           | -          | 0,29       |
| 60 5M-15  |          | 2        | 60       | 95,49      | 94,35     | -            | 50,0       | -         | 20,5 | 30   | 8           | -          | 0,30       |
| 72 5M-15  |          | 2        | 72       | 114,59     | 113,45    | -            | 50,0       | -         | 20,5 | 30   | 8           | -          | 0,59       |



## Passo 5M-25

| Materiale | Cod. HFH | Esec.<br>N° | N°<br>Denti | Ø Prim.<br>Dp | Ø est.<br>De | Ø Flangia<br>Df | Ø Mozzo<br>Dm | Ø int.<br>Di | F    | L  | Ø preforo<br>d | Flangia<br>N° | Massa<br>(kg) |
|-----------|----------|-------------|-------------|---------------|--------------|-----------------|---------------|--------------|------|----|----------------|---------------|---------------|
| Acciaio   | 12 5M-25 | 2F          | 12          | 19,10         | 17,96        | 23              | 13,0          | -            | 30,5 | 36 | 6              | 202           | 0,05          |
|           | 14 5M-25 | 2F          | 14          | 22,28         | 21,14        | 25              | 14,0          | -            | 30,5 | 36 | 6              | 203           | 0,08          |
|           | 15 5M-25 | 2F          | 15          | 23,87         | 22,73        | 28              | 16,0          | -            | 30,5 | 36 | 6              | 204           | 0,09          |
|           | 16 5M-25 | 2F          | 16          | 25,46         | 24,32        | 28              | 16,5          | -            | 30,5 | 36 | 6              | 204           | 0,11          |
|           | 18 5M-25 | 2F          | 18          | 28,65         | 27,51        | 32              | 20,0          | -            | 30,5 | 36 | 6              | 205           | 0,13          |
|           | 20 5M-25 | 2F          | 20          | 31,83         | 30,69        | 36              | 23,0          | -            | 30,5 | 36 | 6              | 206           | 0,17          |
|           | 21 5M-25 | 2F          | 21          | 33,42         | 32,28        | 38              | 24,0          | -            | 30,5 | 38 | 6              | 207           | 0,20          |
|           | 22 5M-25 | 2F          | 22          | 35,01         | 33,87        | 38              | 25,5          | -            | 30,5 | 38 | 6              | 204           | 0,22          |
|           | 24 5M-25 | 2F          | 24          | 38,20         | 37,06        | 42              | 27,0          | -            | 30,5 | 38 | 6              | 208           | 0,26          |
|           | 26 5M-25 | 2F          | 26          | 41,38         | 40,24        | 44              | 30,0          | -            | 30,5 | 38 | 6              | 209           | 0,32          |
|           | 28 5M-25 | 2F          | 28          | 44,56         | 43,42        | 48              | 30,5          | -            | 30,5 | 38 | 6              | 210           | 0,37          |
|           | 30 5M-25 | 2F          | 30          | 47,75         | 46,60        | 51              | 35,0          | -            | 30,5 | 38 | 6              | 211           | 0,44          |
|           | 32 5M-25 | 2F          | 32          | 50,93         | 49,79        | 54              | 38,0          | -            | 30,5 | 38 | 8              | 212           | 0,48          |
|           | 36 5M-25 | 2F          | 36          | 57,30         | 56,16        | 60              | 38,0          | -            | 30,5 | 38 | 8              | 214           | 0,59          |
| 40 5M-25  | 2F       | 40          | 63,66       | 62,52         | 71           | 38,0            | -             | 30,5         | 38   | 8  | 217            | 0,75          |               |
| Ghisa     | 44 5M-25 | 2           | 44          | 70,03         | 68,89        | -               | 38,0          | -            | 30,5 | 40 | 8              | -             | 0,32          |
|           | 48 5M-25 | 2           | 48          | 76,39         | 75,25        | -               | 38,0          | -            | 30,5 | 40 | 8              | -             | 0,28          |
|           | 60 5M-25 | 2           | 60          | 95,49         | 94,35        | -               | 50,0          | -            | 30,5 | 40 | 8              | -             | 0,44          |
|           | 72 5M-25 | 2           | 72          | 114,59        | 113,45       | -               | 50,0          | -            | 30,5 | 40 | 8              | -             | 0,85          |

# PULEGGE DENTATE HTD 8M 20-30-50-85



## Passo 8M-20

| Materiale  | Cod. HFH | Esec. N° | N° Denti | Ø Prim. Dp | Ø est. De | Ø Flangia Df | Ø Mozzo Dm | Ø int. Di | F   | L  | Ø preforo d | Flangia N° | Massa (kg) |
|------------|----------|----------|----------|------------|-----------|--------------|------------|-----------|-----|----|-------------|------------|------------|
| Acciaio    | 22 8M-20 | 2F       | 22       | 56,02      | 54,65     | 60           | 43         | -         | 28  | 38 | 12          | 308        | 0,54       |
|            | 24 8M-20 | 2F       | 24       | 61,11      | 59,74     | 66           | 45         | -         | 28  | 38 | 12          | 310        | 0,65       |
|            | 26 8M-20 | 2F       | 26       | 66,21      | 64,84     | 71           | 48         | -         | 28  | 38 | 12          | 311        | 0,80       |
|            | 28 8M-20 | 2F       | 28       | 71,30      | 70,08     | 75           | 50         | -         | 28  | 38 | 14          | 312        | 0,88       |
|            | 30 8M-20 | 2F       | 30       | 76,39      | 75,13     | 83           | 55         | -         | 28  | 38 | 14          | 314        | 1,00       |
|            | 32 8M-20 | 2F       | 32       | 81,49      | 80,16     | 87           | 60         | -         | 28  | 38 | 14          | 315        | 1,20       |
|            | 34 8M-20 | 2F       | 34       | 86,58      | 85,21     | 91           | 66         | -         | 28  | 38 | 14          | 316        | 1,40       |
|            | 36 8M-20 | 2F       | 36       | 91,67      | 90,30     | 98,5         | 70         | -         | 28  | 38 | 14          | 319        | 1,60       |
|            | 38 8M-20 | 2F       | 38       | 96,77      | 95,39     | 103          | 75         | -         | 28  | 38 | 14          | 320        | 1,70       |
|            | 40 8M-20 | 2F       | 40       | 101,86     | 100,49    | 106          | 75         | -         | 28  | 38 | 14          | 320        | 1,85       |
|            | 44 8M-20 | 2F       | 44       | 112,05     | 110,67    | 119          | 75         | -         | 28  | 38 | 14          | 325        | 2,10       |
|            | 48 8M-20 | 2F       | 48       | 122,23     | 120,86    | 127          | 75         | -         | 28  | 38 | 14          | 327        | 2,50       |
|            | 56 8M-20 | 3F       | 56       | 142,60     | 141,23    | 148          | 80         | 116       | 28  | 38 | 14          | 333        | 2,82       |
|            | 64 8M-20 | 3F       | 64       | 162,97     | 161,60    | 168          | 80         | 137       | 28  | 38 | 14          | 338        | 3,22       |
|            | 72 8M-20 | 3F       | 72       | 183,35     | 181,97    | 192          | 80         | 158       | 28  | 38 | 14          | 340        | 3,74       |
|            | Ghisa    | 80 8M-20 | 3        | 80         | 203,72    | 202,35       | -          | 90        | 180 | 28 | 38          | 14         | -          |
| 90 8M-20   |          | 3        | 90       | 229,18     | 227,81    | -            | 90         | 204       | 28  | 38 | 14          | -          | 4,57       |
| *112 8M-20 |          | 4        | 112      | 285,21     | 283,83    | -            | 90         | 254       | 28  | 38 | 18          | -          | -          |
| *114 8M-20 |          | 4        | 114      | 366,69     | 365,32    | -            | 90         | 336       | 28  | 38 | 20          | -          | -          |
| *168 8M-20 |          | 4        | 168      | 427,81     | 426,44    | -            | 100        | 400       | 28  | 38 | 20          | -          | -          |
| *192 8M-20 | 4        | 192      | 488,92   | 487,55     | -         | 100          | 460        | 28        | 38  | 20 | -           | -          |            |

## Passo 8M-30

| Materiale | Cod. HFH | Esec. N° | N° Denti | Ø Prim. Dp | Ø est. De | Ø Flangia Df | Ø Mozzo Dm | Ø int. Di | F   | L  | Ø preforo d | Flangia N° | Massa (kg) |
|-----------|----------|----------|----------|------------|-----------|--------------|------------|-----------|-----|----|-------------|------------|------------|
| Acciaio   | 22 8M-30 | 2F       | 22       | 56,02      | 54,65     | 60,0         | 43         | -         | 38  | 48 | 12          | 308        | 0,75       |
|           | 24 8M-30 | 2F       | 24       | 61,11      | 59,74     | 66,0         | 45         | -         | 38  | 48 | 12          | 310        | 0,90       |
|           | 26 8M-30 | 2F       | 26       | 66,21      | 64,84     | 71,0         | 48         | -         | 38  | 48 | 12          | 311        | 1,10       |
|           | 28 8M-30 | 2F       | 28       | 71,30      | 70,08     | 75,0         | 50         | -         | 38  | 48 | 14          | 312        | 1,20       |
|           | 30 8M-30 | 2F       | 30       | 76,39      | 75,13     | 83,0         | 55         | -         | 38  | 48 | 14          | 314        | 1,32       |
|           | 32 8M-30 | 2F       | 32       | 81,49      | 80,16     | 87,0         | 60         | -         | 38  | 48 | 14          | 315        | 1,55       |
|           | 34 8M-30 | 2F       | 34       | 86,58      | 85,21     | 91,0         | 66         | -         | 38  | 48 | 14          | 316        | 1,80       |
|           | 36 8M-30 | 2F       | 36       | 91,67      | 90,30     | 98,5         | 70         | -         | 38  | 48 | 14          | 319        | 2,10       |
|           | 38 8M-30 | 2F       | 38       | 96,77      | 95,39     | 103,0        | 75         | -         | 38  | 48 | 14          | 320        | 2,30       |
|           | 40 8M-30 | 2F       | 40       | 101,86     | 100,49    | 106,0        | 75         | -         | 38  | 48 | 14          | 320        | 2,47       |
|           | 44 8M-30 | 2F       | 44       | 112,05     | 110,67    | 119,0        | 75         | -         | 38  | 48 | 14          | 325        | 2,95       |
|           | 48 8M-30 | 2F       | 48       | 122,23     | 120,86    | 127,0        | 75         | -         | 38  | 48 | 14          | 327        | 3,30       |
|           | 56 8M-30 | 3F       | 56       | 142,60     | 141,23    | 148,0        | 80         | 116       | 38  | 48 | 14          | 333        | 4,02       |
|           | 64 8M-30 | 3F       | 64       | 162,97     | 161,60    | 168,0        | 80         | 137       | 38  | 48 | 14          | 338        | 4,60       |
|           | 72 8M-30 | 3F       | 72       | 183,35     | 181,97    | 192,0        | 80         | 158       | 38  | 48 | 14          | 340        | 5,41       |
|           | Ghisa    | 80 8M-30 | 3        | 80         | 203,72    | 202,35       | -          | 90        | 180 | 38 | 48          | 14         | -          |
| 90 8M-30  |          | 3        | 90       | 229,18     | 227,81    | -            | 90         | 204       | 38  | 48 | 14          | -          | 6,42       |
| 112 8M-30 |          | 4        | 112      | 285,21     | 283,83    | -            | 90         | 254       | 38  | 48 | 18          | -          | 8,12       |
| 114 8M-30 |          | 4        | 114      | 366,69     | 365,32    | -            | 90         | 336       | 38  | 48 | 20          | -          | 10,36      |
| 168 8M-30 |          | 4        | 168      | 427,81     | 426,44    | -            | 100        | 400       | 38  | 48 | 20          | -          | 12,37      |
| 192 8M-30 | 4        | 192      | 488,92   | 487,55     | -         | 100          | 460        | 38        | 48  | 20 | -           | 14,31      |            |

### Passo 8M-50

| Materiale | Cod. HFH | Esec.    | N°    | Ø Prim. | Ø est. | Ø Flangia | Ø Mozzo | Ø int. | F   | L  | Ø preforo | Flangia | Massa (kg) |
|-----------|----------|----------|-------|---------|--------|-----------|---------|--------|-----|----|-----------|---------|------------|
|           |          | N°       | Denti | Dp      | De     | Df        | Dm      | Di     |     |    | d         | N°      |            |
| Acciaio   | 22 8M-50 | 2F       | 22    | 56,02   | 54,65  | 60,0      | 43      | -      | 60  | 70 | 12        | 308     | 1,10       |
|           | 24 8M-50 | 2F       | 24    | 61,11   | 59,74  | 66,0      | 45      | -      | 60  | 70 | 12        | 310     | 1,30       |
|           | 26 8M-50 | 2F       | 26    | 66,21   | 64,84  | 71,0      | 48      | -      | 60  | 70 | 12        | 311     | 1,60       |
|           | 28 8M-50 | 2F       | 28    | 71,30   | 70,08  | 75,0      | 50      | -      | 60  | 70 | 14        | 312     | 1,70       |
|           | 30 8M-50 | 2F       | 30    | 76,39   | 75,13  | 83,0      | 55      | -      | 60  | 70 | 14        | 314     | 2,00       |
|           | 32 8M-50 | 2F       | 32    | 81,49   | 80,16  | 87,0      | 60      | -      | 60  | 70 | 14        | 315     | 2,35       |
|           | 34 8M-50 | 2F       | 34    | 86,58   | 85,21  | 91,0      | 66      | -      | 60  | 70 | 14        | 316     | 2,80       |
|           | 36 8M-50 | 2F       | 36    | 91,67   | 90,30  | 98,5      | 70      | -      | 60  | 70 | 14        | 319     | 3,10       |
|           | 38 8M-50 | 2F       | 38    | 96,77   | 95,39  | 103,0     | 75      | -      | 60  | 70 | 14        | 320     | 3,30       |
|           | 40 8M-50 | 2F       | 40    | 101,86  | 100,49 | 106,0     | 75      | -      | 60  | 70 | 14        | 320     | 3,60       |
|           | 44 8M-50 | 2F       | 44    | 112,05  | 110,67 | 119,0     | 75      | -      | 60  | 70 | 14        | 325     | 4,40       |
|           | 48 8M-50 | 2F       | 48    | 122,23  | 120,86 | 127,0     | 75      | -      | 60  | 70 | 14        | 327     | 5,00       |
|           | 56 8M-50 | 7F       | 56    | 142,60  | 141,23 | 148,0     | 90      | 116    | 60  | 60 | 18        | 333     | 5,68       |
|           | 64 8M-50 | 7F       | 64    | 162,97  | 161,60 | 168,0     | 100     | 137    | 60  | 60 | 18        | 338     | 6,93       |
|           | 72 8M-50 | 7F       | 72    | 183,35  | 181,97 | 192,0     | 100     | 158    | 60  | 60 | 18        | 340     | 7,95       |
|           | Ghisa    | 80 8M-50 | 7     | 80      | 203,72 | 202,35    | -       | 110    | 180 | 60 | 60        | 18      | -          |
| 90 8M-50  |          | 7        | 90    | 229,18  | 227,81 | -         | 110     | 204    | 60  | 60 | 18        | -       | 9,20       |
| 112 8M-50 |          | 8        | 112   | 285,21  | 283,83 | -         | 110     | 254    | 60  | 60 | 18        | -       | 12,16      |
| 114 8M-50 |          | 8        | 114   | 366,69  | 365,32 | -         | 110     | 336    | 60  | 60 | 20        | -       | 15,68      |
| 168 8M-50 |          | 8        | 168   | 427,81  | 426,44 | -         | 120     | 400    | 60  | 60 | 20        | -       | 18,99      |
| 192 8M-50 |          | 8        | 192   | 488,92  | 487,55 | -         | 130     | 460    | 60  | 60 | 20        | -       | 24,09      |

### Passo 8M-85

| Materiale  | Cod. HFH | Esec.    | N°    | Ø Prim. | Ø est. | Ø Flangia | Ø Mozzo | Ø int. | F   | L   | Ø preforo | Flangia | Massa (kg) |
|------------|----------|----------|-------|---------|--------|-----------|---------|--------|-----|-----|-----------|---------|------------|
|            |          | N°       | Denti | Dp      | De     | Df        | Dm      | Di     |     |     | d         | N°      |            |
| Acciaio    | 22 8M-85 | 2F       | 22    | 56,02   | 54,65  | 60,0      | 43      | -      | 95  | 105 | 12        | 308     | 1,60       |
|            | 24 8M-85 | 2F       | 24    | 61,11   | 59,74  | 66,0      | 45      | -      | 95  | 105 | 12        | 310     | 1,95       |
|            | 26 8M-85 | 2F       | 26    | 66,21   | 64,84  | 71,0      | 48      | -      | 95  | 105 | 12        | 311     | 2,30       |
|            | 28 8M-85 | 2F       | 28    | 71,30   | 70,08  | 75,0      | 50      | -      | 95  | 105 | 14        | 312     | 2,60       |
|            | 30 8M-85 | 2F       | 30    | 76,39   | 75,13  | 83,0      | 55      | -      | 95  | 105 | 14        | 314     | 3,10       |
|            | 32 8M-85 | 2F       | 32    | 81,49   | 80,16  | 87,0      | 60      | -      | 95  | 105 | 14        | 315     | 3,70       |
|            | 34 8M-85 | 2F       | 34    | 86,58   | 85,21  | 91,0      | 66      | -      | 95  | 105 | 14        | 316     | 4,00       |
|            | 36 8M-85 | 2F       | 36    | 91,67   | 90,30  | 98,5      | 70      | -      | 95  | 105 | 14        | 319     | 4,70       |
|            | 38 8M-85 | 2F       | 38    | 96,77   | 95,39  | 103,0     | 75      | -      | 95  | 105 | 14        | 320     | 5,10       |
|            | 40 8M-85 | 2F       | 40    | 101,86  | 100,49 | 106,0     | 75      | -      | 95  | 105 | 14        | 320     | 5,40       |
|            | 44 8M-85 | 2F       | 44    | 112,05  | 110,67 | 119,0     | 75      | -      | 95  | 105 | 14        | 325     | 6,70       |
|            | 48 8M-85 | 2F       | 48    | 122,23  | 120,86 | 127,0     | 75      | -      | 95  | 105 | 14        | 327     | 7,20       |
|            | 56 8M-85 | 7F       | 56    | 142,60  | 141,23 | 148,0     | 90      | 116    | 95  | 105 | 18        | 333     | 11,48      |
|            | 64 8M-85 | 7F       | 64    | 162,97  | 161,60 | 168,0     | 100     | 137    | 95  | 95  | 18        | 338     | 11,02      |
|            | 72 8M-85 | 7F       | 72    | 183,35  | 181,97 | 192,0     | 100     | 158    | 95  | 95  | 18        | 340     | 13,45      |
|            | Ghisa    | 80 8M-85 | 8     | 80      | 203,72 | 202,35    | -       | 110    | 180 | 95  | 95        | 20      | -          |
| 90 8M-85   |          | 8        | 90    | 229,18  | 227,81 | -         | 110     | 204    | 95  | 95  | 20        | -       | 14,38      |
| 112 8M-85  |          | 8        | 112   | 285,21  | 283,83 | -         | 110     | 254    | 95  | 95  | 24        | -       | 18,66      |
| *114 8M-85 |          | 8        | 114   | 366,69  | 365,32 | -         | 110     | 336    | 95  | 95  | 24        | -       | -          |
| *168 8M-85 |          | 8        | 168   | 427,81  | 426,44 | -         | 120     | 400    | 95  | 95  | 24        | -       | -          |
| *192 8M-85 |          | 8        | 192   | 488,92  | 487,55 | -         | 130     | 460    | 95  | 95  | 24        | -       | -          |

# PULEGGE DENTATE HTD

## 14M 40-55-85-115-170



### Passo 14M-40

| Materiale | Cod. HFH    | Esec.<br>N° | N°<br>Denti | Ø Prim.<br>Dp | Ø est.<br>De | Ø Flangia<br>Df | Ø Mozzo<br>Dm | Ø int.<br>Di | F  | L  | Ø preforo<br>d | Flangia<br>N° | Massa<br>(kg) |
|-----------|-------------|-------------|-------------|---------------|--------------|-----------------|---------------|--------------|----|----|----------------|---------------|---------------|
| Acciaio   | 28 14M-40   | 2F          | 28          | 124,78        | 122,12       | 127             | 100           | -            | 54 | 69 | 24             | 400           | 4,80          |
|           | 30 14M-40   | 2F          | 30          | 133,69        | 130,99       | 138             | 100           | -            | 54 | 69 | 24             | 401           | 5,60          |
|           | 32 14M-40   | 2F          | 32          | 142,60        | 139,88       | 154             | 100           | -            | 54 | 69 | 24             | 403           | 6,20          |
|           | 34 14M-40   | 2F          | 34          | 151,52        | 148,79       | 160             | 100           | -            | 54 | 69 | 24             | 404           | 6,90          |
|           | 36 14M-40   | 2F          | 36          | 160,43        | 157,68       | 168             | 100           | -            | 54 | 69 | 24             | 405           | 7,70          |
|           | 38 14M-40   | 2F          | 38          | 169,34        | 166,60       | 183             | 120           | -            | 54 | 69 | 24             | 406           | 8,90          |
|           | 40 14M-40   | 2F          | 40          | 178,25        | 175,49       | 188             | 120           | -            | 54 | 69 | 24             | 407           | 9,80          |
|           | 44 14M-40   | 2F          | 44          | 196,08        | 193,28       | 211             | 120           | -            | 54 | 69 | 24             | 411           | 12,00         |
| Ghisa     | 48 14M-40   | 3F          | 48          | 213,90        | 211,11       | 226             | 135           | 170          | 54 | 69 | 24             | 412           | 11,98         |
|           | 56 14M-40   | 3F          | 56          | 249,55        | 246,76       | 256             | 135           | 207          | 54 | 69 | 28             | 416           | 14,01         |
|           | 64 14M-40   | 3F          | 64          | 285,21        | 282,41       | 296             | 135           | 240          | 54 | 69 | 28             | 418           | 16,65         |
|           | 72 14M-40   | 4           | 72          | 320,86        | 318,06       | -               | 135           | 278          | 54 | 69 | 28             | -             | 15,52         |
|           | 80 14M-40   | 4           | 80          | 356,51        | 353,71       | -               | 135           | 314          | 54 | 69 | 28             | -             | 17,23         |
|           | 90 14M-40   | 4           | 90          | 401,07        | 398,28       | -               | 135           | 358          | 54 | 69 | 28             | -             | 19,40         |
|           | 112 14M-40  | 4           | 112         | 499,11        | 496,32       | -               | 135           | 456          | 54 | 69 | 28             | -             | 24,14         |
|           | *114 14M-40 | 4           | 144         | 641,71        | 638,92       | -               | 135           | 600          | 54 | 69 | 28             | -             | -             |
|           | *168 14M-40 | 4           | 168         | 748,66        | 745,87       | -               | 135           | 706          | 54 | 69 | 28             | -             | -             |
|           | *192 14M-40 | 4           | 192         | 855,62        | 852,82       | -               | 135           | 813          | 54 | 69 | 28             | -             | -             |

### Passo 14M-55

| Materiale | Cod. HFH   | Esec.<br>N° | N°<br>Denti | Ø Prim.<br>Dp | Ø est.<br>De | Ø Flangia<br>Df | Ø Mozzo<br>Dm | Ø int.<br>Di | F  | L  | Ø preforo<br>d | Flangia<br>N° | Massa<br>(kg) |
|-----------|------------|-------------|-------------|---------------|--------------|-----------------|---------------|--------------|----|----|----------------|---------------|---------------|
| Acciaio   | 28 14M-55  | 2F          | 28          | 124,78        | 122,12       | 127             | 100           | -            | 70 | 85 | 24             | 400           | 5,70          |
|           | 30 14M-55  | 2F          | 30          | 133,69        | 130,99       | 138             | 100           | -            | 70 | 85 | 24             | 401           | 7,10          |
|           | 32 14M-55  | 2F          | 32          | 142,60        | 139,88       | 154             | 100           | -            | 70 | 85 | 24             | 403           | 7,90          |
|           | 34 14M-55  | 2F          | 34          | 151,52        | 148,79       | 160             | 100           | -            | 70 | 85 | 24             | 404           | 9,33          |
|           | 36 14M-55  | 2F          | 36          | 160,43        | 157,68       | 168             | 100           | -            | 70 | 85 | 24             | 405           | 10,49         |
|           | 38 14M-55  | 2F          | 38          | 169,34        | 166,60       | 183             | 120           | -            | 70 | 85 | 24             | 406           | 12,11         |
|           | 40 14M-55  | 2F          | 40          | 178,25        | 175,49       | 188             | 120           | -            | 70 | 85 | 24             | 407           | 13,30         |
|           | 44 14M-55  | 2F          | 44          | 196,08        | 193,28       | 211             | 120           | -            | 70 | 85 | 24             | 411           | 16,12         |
| Ghisa     | 48 14M-55  | 7F          | 48          | 213,90        | 211,11       | 226             | 135           | 170          | 70 | 70 | 24             | 412           | 13,50         |
|           | 56 14M-55  | 7F          | 56          | 249,55        | 246,76       | 256             | 135           | 207          | 70 | 70 | 28             | 416           | 15,78         |
|           | 64 14M-55  | 7F          | 64          | 285,21        | 282,41       | 296             | 135           | 240          | 70 | 70 | 28             | 418           | 19,04         |
|           | 72 14M-55  | 8           | 72          | 320,86        | 318,06       | -               | 135           | 278          | 70 | 70 | 28             | -             | 18,41         |
|           | 80 14M-55  | 8           | 80          | 356,51        | 353,71       | -               | 135           | 314          | 70 | 70 | 28             | -             | 20,27         |
|           | 90 14M-55  | 8           | 90          | 401,07        | 398,28       | -               | 135           | 358          | 70 | 70 | 28             | -             | 22,98         |
|           | 112 14M-55 | 8           | 112         | 499,11        | 496,32       | -               | 135           | 456          | 70 | 70 | 28             | -             | 29,29         |
|           | 114 14M-55 | 8           | 144         | 641,71        | 638,92       | -               | 135           | 600          | 70 | 70 | 28             | -             | -             |
|           | 168 14M-55 | 8           | 168         | 748,66        | 745,87       | -               | 135           | 706          | 70 | 70 | 28             | -             | -             |
|           | 192 14M-55 | 8           | 192         | 855,62        | 852,82       | -               | 135           | 813          | 70 | 70 | 28             | -             | -             |

### Passo 14M-85

| Materiale | Cod. HFH   | Esec.<br>N° | N°<br>Denti | Ø Prim.<br>Dp | Ø est.<br>De | Ø Flangia<br>Df | Ø Mozzo<br>Dm | Ø int.<br>Di | F   | L   | Ø preforo<br>d | Flangia<br>N° | Massa<br>(kg) |
|-----------|------------|-------------|-------------|---------------|--------------|-----------------|---------------|--------------|-----|-----|----------------|---------------|---------------|
| Acciaio   | 28 14M-85  | 2F          | 28          | 124,78        | 122,12       | 127             | 100           | -            | 102 | 117 | 24             | 400           | 8,77          |
|           | 30 14M-85  | 2F          | 30          | 133,69        | 130,99       | 138             | 100           | -            | 102 | 117 | 24             | 401           | 10,13         |
|           | 32 14M-85  | 2F          | 32          | 142,60        | 139,88       | 154             | 100           | -            | 102 | 117 | 24             | 403           | 11,65         |
|           | 34 14M-85  | 2F          | 34          | 151,52        | 148,79       | 160             | 100           | -            | 102 | 117 | 24             | 404           | 13,15         |
|           | 36 14M-85  | 2F          | 36          | 160,43        | 157,68       | 168             | 100           | -            | 102 | 117 | 32             | 405           | 14,48         |
|           | 38 14M-85  | 2F          | 38          | 169,34        | 166,60       | 183             | 120           | -            | 102 | 117 | 32             | 406           | 16,62         |
|           | 40 14M-85  | 2F          | 40          | 178,25        | 175,49       | 188             | 135           | -            | 102 | 117 | 32             | 407           | 18,84         |
|           | 44 14M-85  | 2F          | 44          | 196,08        | 193,28       | 211             | 135           | -            | 102 | 117 | 32             | 411           | 22,86         |
|           | 48 14M-85  | 2F          | 48          | 213,90        | 211,11       | 226             | 150           | -            | 102 | 117 | 32             | 412           | 27,58         |
| Ghisa     | 56 14M-85  | 7F          | 56          | 249,55        | 246,76       | 256             | 150           | 207          | 102 | 102 | 32             | 416           | 24,19         |
|           | 64 14M-85  | 7F          | 64          | 285,21        | 282,41       | 296             | 150           | 240          | 102 | 102 | 32             | 418           | 28,57         |
|           | 72 14M-85  | 8           | 72          | 320,86        | 318,06       | -               | 150           | 278          | 102 | 102 | 32             | -             | 28,26         |
|           | 80 14M-85  | 8           | 80          | 356,51        | 353,71       | -               | 150           | 314          | 102 | 102 | 32             | -             | 31,00         |
|           | 90 14M-85  | 8           | 90          | 401,07        | 398,28       | -               | 150           | 358          | 102 | 102 | 32             | -             | 35,00         |
|           | 112 14M-85 | 8           | 112         | 499,11        | 496,32       | -               | 150           | 456          | 102 | 102 | 32             | -             | 43,50         |
|           | 114 14M-85 | 8           | 144         | 641,71        | 638,92       | -               | 150           | 600          | 102 | 102 | 32             | -             | -             |
|           | 168 14M-85 | 8           | 168         | 748,66        | 745,87       | -               | 150           | 706          | 102 | 102 | 32             | -             | -             |
|           | 192 14M-85 | 8           | 192         | 855,62        | 852,82       | -               | 150           | 813          | 102 | 102 | 32             | -             | -             |

### Passo 14M-115

| Materiale | Cod. HFH    | Esec.<br>N° | N°<br>Denti | Ø Prim.<br>Dp | Ø est.<br>De | Ø Flangia<br>Df | Ø Mozzo<br>Dm | Ø int.<br>Di | F   | L   | Ø preforo<br>d | Flangia<br>N° | Massa<br>(kg) |
|-----------|-------------|-------------|-------------|---------------|--------------|-----------------|---------------|--------------|-----|-----|----------------|---------------|---------------|
| Acciaio   | 28 14M-115  | 2F          | 28          | 124,78        | 122,12       | 127             | 100           | -            | 133 | 148 | 32             | 400           | 10,75         |
|           | 30 14M-115  | 2F          | 30          | 133,69        | 130,99       | 138             | 100           | -            | 133 | 148 | 32             | 401           | 12,52         |
|           | 32 14M-115  | 2F          | 32          | 142,60        | 139,88       | 154             | 100           | -            | 133 | 148 | 32             | 403           | 14,48         |
|           | 34 14M-115  | 2F          | 34          | 151,52        | 148,79       | 160             | 100           | -            | 133 | 148 | 32             | 404           | 16,45         |
|           | 36 14M-115  | 2F          | 36          | 160,43        | 157,68       | 168             | 100           | -            | 133 | 148 | 32             | 405           | 18,99         |
|           | 38 14M-115  | 2F          | 38          | 169,34        | 166,60       | 183             | 120           | -            | 133 | 148 | 32             | 406           | 21,31         |
|           | 40 14M-115  | 2F          | 40          | 178,25        | 175,49       | 188             | 135           | -            | 133 | 148 | 32             | 407           | 24,04         |
|           | 44 14M-115  | 2F          | 44          | 196,08        | 193,28       | 211             | 135           | -            | 133 | 148 | 32             | 411           | 29,41         |
|           | 48 14M-115  | 2F          | 48          | 213,90        | 211,11       | 226             | 150           | -            | 133 | 148 | 32             | 412           | 35,00         |
|           | 56 14M-115  | 2F          | 56          | 249,55        | 246,76       | 256             | 150           | -            | 133 | 148 | 32             | 416           | 48,00         |
| Ghisa     | 64 14M-115  | 7F          | 64          | 285,21        | 282,41       | 296             | 150           | 240          | 133 | 133 | 32             | 418           | 36,00         |
|           | 72 14M-115  | 8           | 72          | 320,86        | 318,06       | -               | 150           | 278          | 133 | 133 | 32             | -             | 36,00         |
|           | 80 14M-115  | 8           | 80          | 356,51        | 353,71       | -               | 150           | 314          | 133 | 133 | 32             | -             | 40,00         |
|           | 90 14M-115  | 8           | 90          | 401,07        | 398,28       | -               | 150           | 358          | 133 | 133 | 32             | -             | 45,00         |
|           | 112 14M-115 | 8           | 112         | 499,11        | 496,32       | -               | 150           | 456          | 133 | 133 | 32             | -             | 55,50         |
|           | 114 14M-115 | 8           | 144         | 641,71        | 638,92       | -               | 150           | 600          | 133 | 133 | 32             | -             | -             |
|           | 168 14M-115 | 8           | 168         | 748,66        | 745,87       | -               | 150           | 706          | 133 | 133 | 32             | -             | -             |
|           | 192 14M-115 | 8           | 192         | 855,62        | 852,82       | -               | 150           | 813          | 133 | 133 | 32             | -             | -             |

## Passo 14M-170

| Materiale    | Cod. HFH     | Esec.<br>N° | N°<br>Denti | Ø Prim.<br>Dp | Ø est.<br>De | Ø Flangia<br>Df | Ø Mozzo<br>Dm | Ø int.<br>Di | F   | L   | Ø preforo<br>d | Flangia<br>N° | Massa<br>(kg) |
|--------------|--------------|-------------|-------------|---------------|--------------|-----------------|---------------|--------------|-----|-----|----------------|---------------|---------------|
| Acciaio      | 28 14M-170   | 2F          | 28          | 124,78        | 122,12       | 127             | 100           | -            | 187 | 202 | 32             | 400           | 14,79         |
|              | 30 14M-170   | 2F          | 30          | 133,69        | 130,99       | 138             | 100           | -            | 187 | 202 | 32             | 401           | 17,24         |
|              | 32 14M-170   | 2F          | 32          | 142,60        | 139,88       | 154             | 100           | -            | 187 | 202 | 32             | 403           | 19,92         |
|              | 34 14M-170   | 2F          | 34          | 151,52        | 148,79       | 160             | 100           | -            | 187 | 202 | 32             | 404           | 22,72         |
|              | 36 14M-170   | 2F          | 36          | 160,43        | 157,68       | 168             | 120           | -            | 187 | 202 | 32             | 405           | 26,07         |
|              | 38 14M-170   | 2F          | 38          | 169,34        | 166,60       | 183             | 135           | -            | 187 | 202 | 32             | 406           | 29,71         |
|              | 40 14M-170   | 2F          | 40          | 178,25        | 175,49       | 188             | 140           | -            | 187 | 202 | 32             | 407           | 33,50         |
|              | *44 14M-170  | 2F          | 44          | 196,08        | 193,28       | 211             | 160           | -            | 187 | 202 | 32             | 411           |               |
|              | *48 14M-170  | 2F          | 48          | 213,90        | 211,11       | 226             | 160           | -            | 187 | 202 | 32             | 412           |               |
|              | *56 14M-170  | 2F          | 56          | 249,55        | 246,76       | 256             | 160           | -            | 187 | 202 | 32             | 416           |               |
| *64 14M-170  | 2F           | 64          | 285,21      | 282,41        | 296          | 180             | -             | 187          | 202 | 32  | 418            |               |               |
| Ghisa        | *72 14M-170  | 7           | 72          | 320,86        | 318,06       | -               | 180           | 278          | 187 | 187 | 32             | -             |               |
|              | 80 14M-170   | 7           | 80          | 356,51        | 353,71       | -               | 180           | 314          | 187 | 187 | 32             | -             | 71,00         |
|              | 90 14M-170   | 8           | 90          | 401,07        | 398,28       | -               | 180           | 358          | 187 | 187 | 38             | -             | 73,00         |
|              | 112 14M-170  | 8           | 112         | 499,11        | 496,32       | -               | 200           | 456          | 187 | 187 | 38             | -             | 95,00         |
|              |              | 8           | 144         | 641,71        | 638,92       | -               | 220           | 600          | 187 | 187 | 38             | -             |               |
|              | *114 14M-170 |             |             |               |              |                 |               |              |     |     |                |               |               |
|              | *168 14M-170 | 8           | 168         | 748,66        | 745,87       | -               | 220           | 706          | 187 | 187 | 38             | -             |               |
| *192 14M-170 | 8            | 192         | 855,62      | 852,82        | -            | 220             | 813           | 187          | 187 | 38  | -              |               |               |

# PULEGGE DENTATE METRICHE PASSO T 2,5 16



**16 T 2.5**

**Passo 2.5 mm.**

| Materiale | Cod.     | HFH | Esec.<br>N° | N°<br>Denti | Ø est.<br>De | Ø Flangia<br>Df | Ø Mozzo<br>Dm | F  | L  | Ø preforo<br>d | Flangia<br>N° | Massa<br>(kg) |
|-----------|----------|-----|-------------|-------------|--------------|-----------------|---------------|----|----|----------------|---------------|---------------|
| Acciaio   | 16 T 2.5 | 12  | 1F          | 12          | 9,00         | 12,0            | 12            | 9  | 16 | -              | 100           | -             |
|           | 16 T 2.5 | 14  | 1F          | 14          | 10,60        | 15,0            | 14            | 9  | 16 | -              | 101           | -             |
|           | 16 T 2.5 | 15  | 1F          | 15          | 11,40        | 15,0            | 15            | 9  | 16 | -              | 101           | -             |
|           | 16 T 2.5 | 16  | 1F          | 16          | 12,20        | 16,0            | 16            | 9  | 16 | -              | 102           | -             |
|           | 16 T 2.5 | 18  | 2F          | 18          | 13,80        | 17,5            | 10            | 10 | 16 | 3              | 104           | -             |
|           | 16 T 2.5 | 19  | 2F          | 19          | 14,60        | 17,5            | 10            | 10 | 16 | 3              | 104           | -             |
|           | 16 T 2.5 | 20  | 2F          | 20          | 15,40        | 19,5            | 11            | 10 | 16 | 3              | 105           | -             |
|           | 16 T 2.5 | 22  | 2F          | 22          | 17,00        | 23,0            | 11            | 10 | 16 | 3              | 106           | -             |
|           | 16 T 2.5 | 24  | 2F          | 24          | 18,55        | 23,0            | 12            | 10 | 16 | 3              | 107           | 0,01          |
|           | 16 T 2.5 | 25  | 2F          | 25          | 19,35        | 23,0            | 13            | 10 | 16 | 3              | 107           | 0,01          |
|           | 16 T 2.5 | 26  | 2F          | 26          | 20,15        | 25,0            | 14            | 10 | 16 | 4              | 108           | 0,01          |
|           | 16 T 2.5 | 28  | 2F          | 28          | 21,75        | 25,0            | 14            | 10 | 16 | 4              | 108           | 0,02          |
|           | 16 T 2.5 | 30  | 2F          | 30          | 23,35        | 28,0            | 16            | 10 | 16 | 6              | 109           | 0,02          |
|           | 16 T 2.5 | 32  | 2F          | 32          | 24,95        | 32,0            | 16            | 10 | 16 | 6              | 110           | 0,02          |
|           | 16 T 2.5 | 36  | 2F          | 36          | 28,10        | 36,0            | 20            | 10 | 16 | 6              | 111           | 0,03          |
|           | 16 T 2.5 | 40  | 2F          | 40          | 31,30        | 38,0            | 22            | 10 | 16 | 6              | 112           | 0,03          |
|           | 16 T 2.5 | 44  | 2           | 44          | 34,50        | -               | 24            | 10 | 16 | 6              | -             | 0,04          |
|           | 16 T 2.5 | 48  | 2           | 48          | 37,70        | -               | 26            | 10 | 16 | 6              | -             | 0,05          |
|           | 16 T 2.5 | 60  | 2           | 60          | 47,25        | -               | 34            | 10 | 16 | 8              | -             | 0,07          |

# PULEGGE DENTATE METRICHE PASSO T5 21-27-36



## 21 T 5                  Passo 5 mm.

| Materiale | Cod.     | HFH | Esec.<br>N° | N°<br>Denti | Ø est.<br>De | Ø Flangia<br>Df | Ø Mozzo<br>Dm | F  | L  | Ø preforo<br>d | Flangia<br>N° | Massa<br>(kg) |
|-----------|----------|-----|-------------|-------------|--------------|-----------------|---------------|----|----|----------------|---------------|---------------|
| Acciaio   | 21 T5 10 | 10  | 2F          | 10          | 15,05        | 19,5            | 8             | 15 | 21 | -              | 200           | 0,01          |
|           | 21 T5 12 | 12  | 2F          | 12          | 18,25        | 23,0            | 10            | 15 | 21 | -              | 201           | 0,01          |
|           | 21 T5 14 | 14  | 2F          | 14          | 21,45        | 25,0            | 13            | 15 | 21 | -              | 203           | 0,02          |
|           | 21 T5 15 | 15  | 2F          | 15          | 23,05        | 28,0            | 16            | 15 | 21 | -              | 204           | 0,02          |
|           | 21 T5 16 | 16  | 2F          | 16          | 24,60        | 32,0            | 18            | 15 | 21 | -              | 205           | 0,03          |
|           | 21 T5 18 | 18  | 2F          | 18          | 27,80        | 32,0            | 20            | 15 | 21 | -              | 205           | 0,03          |
|           | 21 T5 19 | 19  | 2F          | 19          | 29,40        | 36,0            | 22            | 15 | 21 | -              | 206           | 0,04          |
|           | 21 T5 20 | 20  | 2F          | 20          | 31,00        | 36,0            | 23            | 15 | 21 | -              | 206           | 0,04          |
|           | 21 T5 22 | 22  | 2F          | 22          | 34,25        | 38,0            | 24            | 15 | 21 | -              | 207           | 0,05          |
|           | 21 T5 25 | 25  | 2F          | 25          | 38,95        | 44,0            | 26            | 15 | 21 | -              | 209           | 0,06          |
|           | 21 T5 26 | 26  | 2F          | 26          | 40,60        | 44,0            | 26            | 15 | 21 | -              | 209           | 0,06          |
|           | 21 T5 27 | 27  | 2F          | 27          | 42,20        | 48,0            | 30            | 15 | 21 | 8              | 210           | 0,07          |
|           | 21 T5 28 | 28  | 2F          | 28          | 43,75        | 48,0            | 32            | 15 | 21 | 8              | 210           | 0,07          |
|           | 21 T5 30 | 30  | 2F          | 30          | 46,95        | 51,0            | 34            | 15 | 21 | 8              | 211           | 0,07          |
|           | 21 T5 32 | 32  | 2F          | 32          | 50,10        | 54,0            | 38            | 15 | 21 | 8              | 212           | 0,09          |
|           | 21 T5 36 | 36  | 2F          | 36          | 56,45        | 63,0            | 38            | 15 | 21 | 8              | 215           | 0,11          |
|           | 21 T5 40 | 40  | 2F          | 40          | 62,85        | 66,0            | 40            | 15 | 21 | 8              | 216           | 0,14          |
|           | 21 T5 42 | 42  | 2F          | 42          | 66,00        | 71,0            | 40            | 15 | 21 | 8              | 217           | 0,18          |
|           | 21 T5 44 | 2   | 44          | 2           | 69,20        | -               | 45            | 15 | 21 | 8              | -             | 0,18          |
|           | 21 T5 48 | 2   | 48          | 2           | 75,55        | -               | 50            | 15 | 21 | 8              | -             | 0,20          |
| 21 T5 60  | 2        | 60  | 2           | 94,65       | -            | 65              | 15            | 21 | 8  | -              | 0,31          |               |

## 27 T 5                  Passo 5 mm.

| Materiale | Cod.     | HFH | Esec.<br>N° | N°<br>Denti | Ø est.<br>De | Ø Flangia<br>Df | Ø Mozzo<br>Dm | F  | L  | Ø preforo<br>d | Flangia<br>N° | Massa<br>(kg) |
|-----------|----------|-----|-------------|-------------|--------------|-----------------|---------------|----|----|----------------|---------------|---------------|
| Acciaio   | 27 T5 10 | 10  | 2F          | 10          | 15,05        | 19,5            | 8             | 21 | 27 | -              | 200           | 0,02          |
|           | 27 T5 12 | 12  | 2F          | 12          | 18,25        | 23,0            | 10            | 21 | 27 | -              | 201           | 0,02          |
|           | 27 T5 14 | 14  | 2F          | 14          | 21,45        | 25,0            | 13            | 21 | 27 | -              | 203           | 0,03          |
|           | 27 T5 15 | 15  | 2F          | 15          | 23,05        | 28,0            | 16            | 21 | 27 | -              | 204           | 0,03          |
|           | 27 T5 16 | 16  | 2F          | 16          | 24,60        | 32,0            | 18            | 21 | 27 | -              | 205           | 0,04          |
|           | 27 T5 18 | 18  | 2F          | 18          | 27,80        | 32,0            | 20            | 21 | 27 | -              | 205           | 0,04          |
|           | 27 T5 19 | 19  | 2F          | 19          | 29,40        | 36,0            | 22            | 21 | 27 | -              | 206           | 0,05          |
|           | 27 T5 20 | 20  | 2F          | 20          | 31,00        | 36,0            | 23            | 21 | 27 | -              | 206           | 0,06          |
|           | 27 T5 22 | 22  | 2F          | 22          | 34,25        | 38,0            | 24            | 21 | 27 | -              | 207           | 0,06          |
|           | 27 T5 24 | 24  | 2F          | 24          | 37,40        | 42,0            | 26            | 21 | 27 | -              | 208           | 0,08          |
|           | 27 T5 25 | 25  | 2F          | 25          | 38,95        | 44,0            | 26            | 21 | 27 | -              | 209           | 0,08          |
|           | 27 T5 26 | 26  | 2F          | 26          | 40,60        | 44,0            | 26            | 21 | 27 | -              | 209           | 0,09          |
|           | 27 T5 27 | 27  | 2F          | 27          | 42,20        | 48,0            | 30            | 21 | 27 | 8              | 210           | 0,09          |
|           | 27 T5 28 | 28  | 2F          | 28          | 43,75        | 48,0            | 32            | 21 | 27 | 8              | 210           | 0,09          |
|           | 27 T5 30 | 30  | 2F          | 30          | 46,95        | 51,0            | 34            | 21 | 27 | 8              | 211           | 0,10          |
|           | 27 T5 32 | 32  | 2F          | 32          | 50,10        | 54,0            | 38            | 21 | 27 | 8              | 212           | 0,12          |
|           | 27 T5 36 | 36  | 2F          | 36          | 56,45        | 63,0            | 38            | 21 | 27 | 8              | 215           | 0,16          |
|           | 27 T5 40 | 40  | 2F          | 40          | 62,85        | 66,0            | 40            | 21 | 27 | 8              | 216           | 0,19          |
|           | 27 T5 42 | 42  | 2F          | 42          | 66,00        | 71,0            | 40            | 21 | 27 | 8              | 217           | 0,20          |
|           | 27 T5 44 | 2   | 44          | 2           | 69,20        | -               | 45            | 21 | 27 | 8              | -             | 0,23          |
| 27 T5 48  | 2        | 48  | 2           | 75,55       | -            | 50              | 21            | 27 | 8  | -              | 0,28          |               |
| 27 T5 60  | 2        | 60  | 2           | 94,65       | -            | 65              | 21            | 27 | 8  | -              | 0,43          |               |



# 36 T 5

# Passo 5 mm.

| Materiale | Cod.     | HFH | Esec.<br>N° | N°<br>Denti | Ø est.<br>De | Ø Flangia<br>Df | Ø Mozzo<br>Dm | F  | L  | Ø preforo<br>d | Flangia<br>N° | Massa<br>(kg) |
|-----------|----------|-----|-------------|-------------|--------------|-----------------|---------------|----|----|----------------|---------------|---------------|
| Acciaio   | 36 T5 10 |     | 2F          | 10          | 15,05        | 19,5            | 8             | 30 | 36 | -              | 200           | 0,02          |
|           | 36 T5 12 |     | 2F          | 12          | 18,25        | 23,0            | 10            | 30 | 36 | -              | 201           | 0,03          |
|           | 36 T5 14 |     | 2F          | 14          | 21,45        | 25,0            | 13            | 30 | 36 | -              | 203           | 0,04          |
|           | 36 T5 15 |     | 2F          | 15          | 23,05        | 28,0            | 16            | 30 | 36 | -              | 204           | 0,04          |
|           | 36 T5 16 |     | 2F          | 16          | 24,60        | 32,0            | 18            | 30 | 36 | -              | 205           | 0,05          |
|           | 36 T5 18 |     | 2F          | 18          | 27,80        | 32,0            | 20            | 30 | 36 | -              | 205           | 0,06          |
|           | 36 T5 19 |     | 2F          | 19          | 29,40        | 36,0            | 22            | 30 | 36 | -              | 206           | 0,07          |
|           | 36 T5 20 |     | 2F          | 20          | 31,00        | 36,0            | 23            | 30 | 36 | -              | 206           | 0,08          |
|           | 36 T5 22 |     | 2F          | 22          | 34,25        | 38,0            | 24            | 30 | 36 | -              | 207           | 0,08          |
|           | 36 T5 24 |     | 2F          | 24          | 37,40        | 42,0            | 26            | 30 | 36 | -              | 208           | 0,11          |
|           | 36 T5 25 |     | 2F          | 25          | 38,95        | 44,0            | 26            | 30 | 36 | -              | 209           | 0,12          |
|           | 36 T5 26 |     | 2F          | 26          | 40,60        | 44,0            | 26            | 30 | 36 | -              | 209           | 0,12          |
|           | 36 T5 27 |     | 2F          | 27          | 42,20        | 48,0            | 30            | 30 | 36 | 8              | 210           | 0,13          |
|           | 36 T5 28 |     | 2F          | 28          | 43,75        | 48,0            | 32            | 30 | 36 | 8              | 210           | 0,14          |
|           | 36 T5 30 |     | 2F          | 30          | 46,95        | 51,0            | 34            | 30 | 36 | 8              | 211           | 0,15          |
|           | 36 T5 32 |     | 2F          | 32          | 50,10        | 54,0            | 38            | 30 | 36 | 8              | 212           | 0,18          |
|           | 36 T5 36 |     | 2F          | 36          | 56,45        | 63,0            | 38            | 30 | 36 | 8              | 215           | 0,23          |
|           | 36 T5 40 |     | 2F          | 40          | 62,85        | 66,0            | 40            | 30 | 36 | 8              | 216           | 0,28          |
|           | 36 T5 42 |     | 2F          | 42          | 66,00        | 71,0            | 40            | 30 | 36 | 8              | 217           | 0,29          |
|           | 36 T5 44 |     | 2           | 44          | 69,20        | -               | 45            | 30 | 36 | 8              | -             | 0,31          |
| 36 T5 48  |          | 2   | 48          | 75,55       | -            | 50              | 30            | 36 | 8  | -              | 0,40          |               |
| 36 T5 60  |          | 2   | 60          | 94,65       | -            | 65              | 30            | 36 | 8  | -              | 0,61          |               |

# PULEGGE DENTATE METRICHE PASSO T10 31-40-47-66



## 31 T 10                  Passo 10 mm.

| Materiale | Cod. HFH   | Esec. N° | N° Denti | Ø est. De | Ø Flangia Df | Ø Mozzo Dm | F  | L  | Ø preforo d | Flangia N° | Massa (kg) |
|-----------|------------|----------|----------|-----------|--------------|------------|----|----|-------------|------------|------------|
| Acciaio   | 31 T 10 12 | 2F       | 12       | 36,35     | 42           | 28         | 21 | 31 | 6           | 208        | 0,08       |
|           | 31 T 10 14 | 2F       | 14       | 42,70     | 48           | 32         | 21 | 31 | 8           | 210        | 0,10       |
|           | 31 T 10 15 | 2F       | 15       | 45,90     | 51           | 32         | 21 | 31 | 8           | 211        | 0,12       |
|           | 31 T 10 16 | 2F       | 16       | 49,10     | 54           | 35         | 21 | 31 | 8           | 212        | 0,13       |
|           | 31 T 10 18 | 2F       | 18       | 55,45     | 60           | 40         | 21 | 31 | 8           | 214        | 0,17       |
|           | 31 T 10 19 | 2F       | 19       | 58,65     | 66           | 44         | 21 | 31 | 8           | 216        | 0,18       |
|           | 31 T 10 20 | 2F       | 20       | 61,80     | 66           | 46         | 21 | 31 | 8           | 216        | 0,21       |
|           | 31 T 10 22 | 2F       | 22       | 68,20     | 75           | 52         | 21 | 31 | 8           | 218        | 0,25       |
|           | 31 T 10 24 | 2F       | 24       | 74,55     | 83           | 58         | 21 | 31 | 8           | 219        | 0,29       |
|           | 31 T 10 25 | 2F       | 25       | 77,75     | 83           | 60         | 21 | 31 | 8           | 219        | 0,31       |
|           | 31 T 10 26 | 2F       | 26       | 80,90     | 87           | 60         | 21 | 31 | 8           | 220        | 0,36       |
|           | 31 T 10 27 | 2F       | 27       | 84,10     | 91           | 60         | 21 | 31 | 8           | 221        | 0,37       |
|           | 31 T 10 28 | 2F       | 28       | 87,25     | 93           | 60         | 21 | 31 | 8           | 222        | 0,40       |
|           | 31 T 10 30 | 2F       | 30       | 93,65     | 97           | 60         | 21 | 31 | 8           | 223        | 0,44       |
|           | 31 T 10 32 | 2F       | 32       | 100,00    | 106          | 65         | 21 | 31 | 10          | 224        | 0,49       |
|           | 31 T 10 36 | 2F       | 36       | 112,75    | 119          | 70         | 21 | 31 | 10          | 225        | 0,62       |
|           | 31 T 10 40 | 2F       | 40       | 125,45    | 131          | 80         | 21 | 31 | 10          | 226        | 0,77       |
|           | 31 T 10 44 | 2        | 44       | 138,20    | -            | 88         | 21 | 31 | 10          | -          | 1,00       |
|           | 31 T 10 48 | 2        | 48       | 150,95    | -            | 95         | 21 | 31 | 16          | -          | 1,10       |
|           | 31 T 10 60 | 2        | 60       | 189,15    | -            | 110        | 21 | 31 | 16          | -          | 1,70       |

## 40 T 10                  Passo 10 mm.

| Materiale | Cod. HFH   | Esec. N° | N° Denti | Ø est. De | Ø Flangia Df | Ø Mozzo Dm | F  | L  | Ø preforo d | Flangia N° | Massa (kg) |
|-----------|------------|----------|----------|-----------|--------------|------------|----|----|-------------|------------|------------|
| Acciaio   | 40 T 10 12 | 2F       | 12       | 36,35     | 42           | 28         | 30 | 40 | 6           | 208        | 0,10       |
|           | 40 T 10 14 | 2F       | 14       | 42,70     | 48           | 32         | 30 | 40 | 8           | 210        | 0,13       |
|           | 40 T 10 15 | 2F       | 15       | 45,90     | 51           | 32         | 30 | 40 | 8           | 211        | 0,15       |
|           | 40 T 10 16 | 2F       | 16       | 49,10     | 54           | 35         | 30 | 40 | 8           | 212        | 0,18       |
|           | 40 T 10 18 | 2F       | 18       | 55,45     | 60           | 40         | 30 | 40 | 8           | 214        | 0,22       |
|           | 40 T 10 19 | 2F       | 19       | 58,65     | 66           | 44         | 30 | 40 | 8           | 216        | 0,25       |
|           | 40 T 10 20 | 2F       | 20       | 61,80     | 66           | 46         | 30 | 40 | 8           | 216        | 0,28       |
|           | 40 T 10 22 | 2F       | 22       | 68,20     | 75           | 52         | 30 | 40 | 8           | 218        | 0,34       |
|           | 40 T 10 24 | 2F       | 24       | 74,55     | 83           | 58         | 30 | 40 | 8           | 219        | 0,39       |
|           | 40 T 10 25 | 2F       | 25       | 77,75     | 83           | 60         | 30 | 40 | 8           | 219        | 0,42       |
|           | 40 T 10 26 | 2F       | 26       | 80,90     | 87           | 60         | 30 | 40 | 8           | 220        | 0,48       |
|           | 40 T 10 27 | 2F       | 27       | 84,10     | 91           | 60         | 30 | 40 | 8           | 221        | 0,54       |
|           | 40 T 10 28 | 2F       | 28       | 87,25     | 93           | 60         | 30 | 40 | 8           | 222        | 0,55       |
|           | 40 T 10 30 | 2F       | 30       | 93,65     | 97           | 60         | 30 | 40 | 8           | 223        | 0,64       |
|           | 40 T 10 32 | 2F       | 32       | 100,00    | 106          | 65         | 30 | 40 | 10          | 224        | 0,69       |
|           | 40 T 10 36 | 2F       | 36       | 112,75    | 119          | 70         | 30 | 40 | 10          | 225        | 0,54       |
|           | 40 T 10 40 | 2F       | 40       | 125,45    | 131          | 80         | 30 | 40 | 10          | 226        | 1,07       |
|           | 40 T 10 44 | 2        | 44       | 138,20    | -            | 88         | 30 | 40 | 10          | -          | 1,35       |
|           | 40 T 10 48 | 2        | 48       | 150,95    | -            | 95         | 30 | 40 | 16          | -          | 1,52       |
|           | 40 T 10 60 | 2        | 60       | 189,15    | -            | 110        | 30 | 40 | 16          | -          | 2,34       |

## 47 T 11

## Passo 10MM

| Materiale | Cod.       | HFH | Esec.<br>N° | N°<br>Denti | Ø est.<br>De | Ø Flangia<br>Df | Ø Mozzo<br>Dm | F  | L  | Ø preforo<br>d | Flangia<br>N° | Massa<br>(kg) |
|-----------|------------|-----|-------------|-------------|--------------|-----------------|---------------|----|----|----------------|---------------|---------------|
| Acciaio   | 47 T 10 18 |     | 2F          | 18          | 55,45        | 60              | 40            | 37 | 47 | 10             | 214           | 0,25          |
|           | 47 T 10 19 |     | 2F          | 19          | 58,65        | 66              | 44            | 37 | 47 | 10             | 216           | 0,29          |
|           | 47 T 10 20 |     | 2F          | 20          | 61,80        | 66              | 46            | 37 | 47 | 12             | 216           | 0,32          |
|           | 47 T 10 22 |     | 2F          | 22          | 68,20        | 75              | 52            | 37 | 47 | 12             | 218           | 0,39          |
|           | 47 T 10 24 |     | 2F          | 24          | 74,55        | 83              | 58            | 37 | 47 | 12             | 219           | 0,47          |
|           | 47 T 10 25 |     | 2F          | 25          | 77,75        | 83              | 60            | 37 | 47 | 12             | 219           | 0,53          |
|           | 47 T 10 26 |     | 2F          | 26          | 80,90        | 87              | 60            | 37 | 47 | 12             | 220           | 0,56          |
|           | 47 T 10 27 |     | 2F          | 27          | 84,10        | 91              | 60            | 37 | 47 | 12             | 221           | 0,60          |
|           | 47 T 10 28 |     | 2F          | 28          | 87,25        | 93              | 60            | 37 | 47 | 12             | 222           | 0,64          |
|           | 47 T 10 30 |     | 2F          | 30          | 93,65        | 97              | 60            | 37 | 47 | 12             | 223           | 0,74          |
|           | 47 T 10 32 |     | 2F          | 32          | 100,00       | 106             | 65            | 37 | 47 | 12             | 224           | 0,84          |
|           | 47 T 10 36 |     | 2F          | 36          | 112,75       | 119             | 70            | 37 | 47 | 16             | 225           | 1,06          |
|           | 47 T 10 40 |     | 2F          | 40          | 125,45       | 131             | 80            | 37 | 47 | 16             | 226           | 1,32          |
|           | 47 T 10 44 |     | 2           | 44          | 138,20       | -               | 88            | 37 | 47 | 16             | -             | 1,61          |
|           | 47 T 10 48 |     | 2           | 48          | 150,95       | -               | 95            | 37 | 47 | 16             | -             | 1,93          |
|           | 47 T 10 60 |     | 2           | 60          | 189,15       | -               | 110           | 37 | 47 | 16             | -             | 3,00          |

## 66 T 10

## Passo 10MM

| Materiale | Cod.       | HFH | Esec.<br>N° | N°<br>Denti | Ø est.<br>De | Ø Flangia<br>Df | Ø Mozzo<br>Dm | F  | L  | Ø preforo<br>d | Flangia<br>N° | Massa<br>(kg) |
|-----------|------------|-----|-------------|-------------|--------------|-----------------|---------------|----|----|----------------|---------------|---------------|
| Acciaio   | 66 T 10 18 |     | 2F          | 18          | 55,45        | 60              | 40            | 56 | 66 | 10             | 214           | 0,42          |
|           | 66 T 10 19 |     | 2F          | 19          | 58,65        | 66              | 44            | 56 | 66 | 10             | 216           | 0,47          |
|           | 66 T 10 20 |     | 2F          | 20          | 61,80        | 66              | 46            | 56 | 66 | 12             | 216           | 0,52          |
|           | 66 T 10 22 |     | 2F          | 22          | 68,20        | 75              | 52            | 56 | 66 | 12             | 218           | 0,57          |
|           | 66 T 10 24 |     | 2F          | 24          | 74,55        | 83              | 58            | 56 | 66 | 12             | 219           | 0,74          |
|           | 66 T 10 25 |     | 2F          | 25          | 77,75        | 83              | 60            | 56 | 66 | 12             | 219           | 0,77          |
|           | 66 T 10 26 |     | 2F          | 26          | 80,90        | 87              | 60            | 56 | 66 | 12             | 220           | 0,82          |
|           | 66 T 10 27 |     | 2F          | 27          | 84,10        | 91              | 60            | 56 | 66 | 12             | 221           | 0,95          |
|           | 66 T 10 28 |     | 2F          | 28          | 87,25        | 93              | 60            | 56 | 66 | 12             | 222           | 0,96          |
|           | 66 T 10 30 |     | 2F          | 30          | 93,65        | 97              | 60            | 56 | 66 | 12             | 223           | 1,17          |
|           | 66 T 10 32 |     | 2F          | 32          | 100,00       | 106             | 65            | 56 | 66 | 12             | 224           | 1,30          |
|           | 66 T 10 36 |     | 2F          | 36          | 112,75       | 119             | 70            | 56 | 66 | 16             | 225           | 1,64          |
|           | 66 T 10 40 |     | 2F          | 40          | 125,45       | 131             | 80            | 56 | 66 | 16             | 226           | 2,00          |
|           | 66 T 10 44 |     | 2           | 44          | 138,20       | -               | 88            | 56 | 66 | 16             | -             | 2,36          |
|           | 66 T 10 48 |     | 2           | 48          | 150,95       | -               | 95            | 56 | 66 | 16             | -             | 2,83          |
|           | 66 T 10 60 |     | 2           | 60          | 189,15       | -               | 110           | 56 | 66 | 16             | -             | 4,37          |

# FLANGE PER PULEGGE DENTATE



| S=0,5mm. |                   |      |      | S=1mm.  |                   |       |       | S=1,5mm. |                   |       |       | S=2,5mm. |                   |       |       |
|----------|-------------------|------|------|---------|-------------------|-------|-------|----------|-------------------|-------|-------|----------|-------------------|-------|-------|
| Flangia  | Dimensioni in mm. |      |      | Flangia | Dimensioni in mm. |       |       | Flangia  | Dimensioni in mm. |       |       | Flangia  | Dimensioni in mm. |       |       |
| N°       | Ø E               | Ø M  | Ø I  | N°      | Ø E               | Ø M   | Ø I   | N°       | Ø E               | Ø M   | Ø I   | N°       | Ø E               | Ø M   | Ø I   |
| 100      | 12,0              | 10,0 | 6,0  | 200     | 19,5              | 17,5  | 12,0  | 300      | 36                | 31,0  | 25,0  | 400      | 127               | 120,2 | 104,7 |
| 101      | 15,0              | 12,0 | 8,0  | 201     | 23,0              | 17,5  | 12,0  | 301      | 38                | 34,0  | 28,0  | 401      | 138               | 130,0 | 108,0 |
| 102      | 16,0              | 13,0 | 9,5  | 202     | 23,0              | 20,0  | 14,0  | 302      | 42                | 38,0  | 30,5  | 402      | 146               | 138,0 | 116,0 |
| 104      | 17,5              | 15,0 | 11,0 | 203     | 25,0              | 22,0  | 15,0  | 303      | 44                | 40,0  | 33,0  | 403      | 154               | 146,0 | 122,0 |
| 105      | 19,5              | 17,5 | 12,0 | 204     | 28,0              | 24,0  | 18,0  | 304      | 48                | 43,5  | 37,0  | 404      | 160               | 150,0 | 128,0 |
| 106      | 23,0              | 17,5 | 12,0 | 205     | 32,0              | 28,0  | 21,5  | 305      | 51                | 47,5  | 40,0  | 405      | 168               | 162,0 | 135,0 |
| 107      | 23,0              | 20,0 | 14,0 | 206     | 36,0              | 31,0  | 25,0  | 306      | 54                | 50,5  | 43,0  | 406      | 183               | 170,0 | 145,0 |
| 108      | 25,0              | 22,0 | 15,0 | 207     | 38,0              | 34,0  | 28,0  | 307      | 57                | 53,0  | 46,0  | 407      | 188               | 180,0 | 158,0 |
| 109      | 28,0              | 24,0 | 18,0 | 208     | 42,0              | 38,0  | 30,5  | 308      | 60                | 57,0  | 47,0  | 409      | 198               | 188,0 | 165,0 |
| 110      | 32,0              | 28,0 | 21,5 | 209     | 44,0              | 40,0  | 33,0  | 309      | 63                | 57,0  | 48,0  | 410      | 200               | 192,8 | 172,0 |
| 111      | 36,0              | 31,0 | 25,0 | 210     | 48,0              | 43,5  | 37,0  | 310      | 66                | 61,5  | 52,0  | 411      | 211               | 198,0 | 173,0 |
| 112      | 38,0              | 34,0 | 28,0 | 211     | 51,0              | 47,5  | 40,0  | 311      | 71                | 65,0  | 56,0  | 412      | 226               | 214,0 | 190,0 |
| 113      | 42,0              | 38,0 | 30,5 | 212     | 54,0              | 50,5  | 43,0  | 312      | 75                | 68,5  | 60,0  | 414      | 240               | 224,0 | 192,0 |
| 114      | 48,0              | 43,5 | 37,0 | 213     | 57,0              | 53,0  | 46,0  | 313      | 79                | 73,5  | 64,0  | 415      | 256               | 240,0 | 220,0 |
|          |                   |      |      | 214     | 60,0              | 57,0  | 47,0  | 314      | 83                | 76,5  | 68,0  | 416      | 256               | 247,0 | 225,0 |
|          |                   |      |      | 215     | 63,0              | 57,0  | 48,0  | 315      | 87                | 82,5  | 72,0  | 418      | 296               | 287   | 252   |
|          |                   |      |      | 216     | 66,0              | 61,5  | 52,0  | 316      | 91                | 85,5  | 76,0  |          |                   |       |       |
|          |                   |      |      | 217     | 71,0              | 65,0  | 56,0  | 317      | 93                | 89,0  | 80,0  |          |                   |       |       |
|          |                   |      |      | 218     | 75,0              | 68,5  | 60,0  | 318      | 97                | 93,0  | 83,0  |          |                   |       |       |
|          |                   |      |      | 219     | 83,0              | 76,5  | 68,0  | 319      | 98                | 92,0  | 79,3  |          |                   |       |       |
|          |                   |      |      | 220     | 87,0              | 82,5  | 72,0  | 320      | 103               | 97,0  | 86,0  |          |                   |       |       |
|          |                   |      |      | 221     | 91,0              | 85,5  | 76,0  | 321      | 106               | 101,0 | 90,0  |          |                   |       |       |
|          |                   |      |      | 222     | 93,0              | 89,0  | 80,0  | 322      | 111               | 106,0 | 94,0  |          |                   |       |       |
|          |                   |      |      | 223     | 97,0              | 93,0  | 83,0  | 323      | 115               | 110,0 | 99,0  |          |                   |       |       |
|          |                   |      |      | 224     | 106,0             | 101,0 | 90,0  | 325      | 119               | 113,5 | 103,0 |          |                   |       |       |
|          |                   |      |      | 225     | 119,0             | 113,5 | 103,0 | 326      | 123               | 117,5 | 107,0 |          |                   |       |       |
|          |                   |      |      | 226     | 131,0             | 125,5 | 115,0 | 327      | 127               | 122,0 | 111,0 |          |                   |       |       |
|          |                   |      |      |         |                   |       |       | 328      | 135               | 130,0 | 119,0 |          |                   |       |       |
|          |                   |      |      |         |                   |       |       | 330      | 140               | 134,5 | 123,0 |          |                   |       |       |
|          |                   |      |      |         |                   |       |       | 331      | 143               | 139,0 | 127,0 |          |                   |       |       |
|          |                   |      |      |         |                   |       |       | 333      | 148               | 143,0 | 132,0 |          |                   |       |       |
|          |                   |      |      |         |                   |       |       | 334      | 152               | 147,5 | 136,0 |          |                   |       |       |
|          |                   |      |      |         |                   |       |       | 335      | 158               | 154,0 | 142,0 |          |                   |       |       |
|          |                   |      |      |         |                   |       |       | 338      | 168               | 163,0 | 149,5 |          |                   |       |       |
|          |                   |      |      |         |                   |       |       | 339      | 184               | 179,0 | 165,0 |          |                   |       |       |
|          |                   |      |      |         |                   |       |       | 340      | 192               | 187,0 | 173,0 |          |                   |       |       |
|          |                   |      |      |         |                   |       |       | 342      | 200               | 195,0 | 181,0 |          |                   |       |       |